



I, JACKIE W. BRIM, CERTIFY THAT THIS PLAT WAS PREPARED UNDER MY SUPERVISION AND THAT THE PLAT WAS PREPARED FOR THE PURPOSE OF EASEMENTS ONLY, AND IS NOT INTENDED TO BE A BOUNDARY SURVEY OF PROPERTY SHOWN.

*Jackie W. Brim* 5-11-2016  
 JACKIE W. BRIM, NC P.L.S. L-4348 DATE

223-513-12  
 MICHAEL F. SHEA  
 LISA A. SHEA  
 DB 28015-549  
 11814 BRIDGEVIEW LN.

LEGEND

- REBAR OR PIPE FOUND
- CITY CONTROL POINT
- CALCULATED POINT
- LINES SURVEYED
- LINES NOT SURVEYED
- STORM DRAINAGE EASEMENT
- EXISTING PSDE TO BE ACCEPTED AS SDE

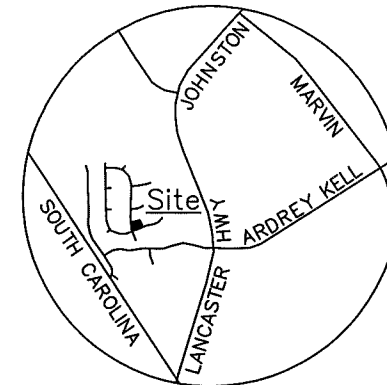

VICINITY MAP  
 Not to Scale

223-513-14  
 ELIZABETH C. THIBODEAU  
 ANTHONY A. THIBODEAU  
 DB 30693-512  
 16715 NEW PROVIDENCE LN.



#5 REBAR  
 NC GRID NAD 83 (2011)  
 NC GRID COORDINATES  
 N 468447.36'  
 E 1444867.41'

BRIDGEVIEW LANE  
 50' PUBLIC R/W

MAG NAIL  
 NC GRID NAD 83 (2011)  
 NC GRID COORDINATES  
 N 468447.34'  
 E 1444867.41'  
 CGF: 0.9998541

(N78°52'05"E 150.00')  
 N78°52'05"E 150.06'

TOTAL  
 R=955.00', L=78.03'  
 CH=78.01, N13°28'37"W  
 (R=955.00', L=78.01'  
 CH=78.01, N15°43'49"W)

R=1020.00', L=14.42'  
 CH=14.42, S69°29'35"W  
 (R=1020.00', L=14.42'  
 CH=14.42, S67°41'30"W)

223-513-13  
 ANDRE L. POWELL  
 LEA V. POWELL  
 DB 30166-734  
 11806 BRIDGEVIEW LN.

SEE  
 DETAIL

S91°31'17"E 104.95'  
 104.93' GRID

S68°06'24"E  
 50.29'

104.58'

S69°36'37"W 111.97' TOTAL  
 (S67°17'12"W 111.97')

NEW PROVIDENCE LN.  
 40' PUBLIC R/W

S69°36'37"W  
 7.39'

R=30.00', L=49.55'  
 CH=44.11, S63°08'04"E  
 (R=30.00', L=49.55'  
 CH=44.11, S65°23'32"E)

EXISTING "PUBLIC  
 STORM DRAIN  
 EASEMENT" PER  
 MB 34-510  
 TO BE ACCEPTED  
 AS STORM DRAINAGE  
 EASEMENT

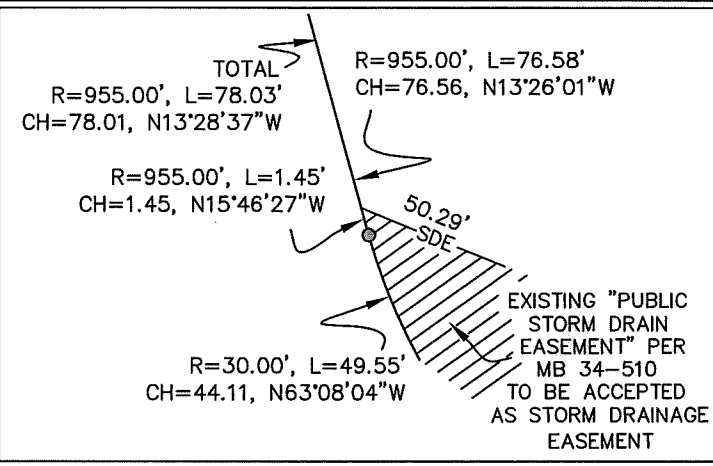

State of North Carolina  
 County of Mecklenburg

I, \_\_\_\_\_, Review Officer of Mecklenburg County, certify that the map or plat to which this certification is affixed meets all statutory requirements for recording.

Review Officer \_\_\_\_\_ Date \_\_\_\_\_

NOTES:

- 1) BEARINGS AND DISTANCES SHOWN IN PARENTHESES ARE BASED ON RECORDED INFORMATION, MB 34-510
- 2) TOTAL AREA 14,947 SQ.FT.
- 3) EXISTING PSDE TO BE ACCEPTED AS SDE 443 SQ.FT.
- 4) AREA REMAINING 14,947 SQ.FT.

PREPARED BY:  
 CITY OF CHARLOTTE  
 ENGINEERING & PROPERTY MANAGEMENT DEPT.  
 600 EAST FOURTH STREET  
 CHARLOTTE, NC 28208  
 704-336-2291

**CHARLOTTE**

**ENGINEERING & PROPERTY MANAGEMENT DEPARTMENT**

<b>REVISIONS</b>	11806 BRIDGEVIEW LN. STORM WATER MAINTENANCE IMPROVEMENT PROJECT	<b>JOB NO.</b> SWDES00561
		<b>FILE NO.</b>
<b>SCALE</b> 0 1"=40" 40'	<b>OWNERS:</b> ANDRE L. POWELL LEA V. POWELL 11806 BRIDGEVIEW LN. CHARLOTTE, MECKLENBURG CO., NC	<b>SHEET</b> 1
<b>DRAWN BY</b> JPG	<b>CHECKED BY</b> GAI <b>SURVEY SUPVR.</b>	<b>OF</b> 1

P:\acadproj\Surpro\SWATER\MAINT\BRIDGEVIEW LANE\11806\PLATS\11806 Bridgeview Ln. Plot2.dwg

DB 30986-129