

I, DAVID H. SNIDER, CERTIFY THAT THIS PLAT WAS PREPARED UNDER MY SUPERVISION AND THAT THE PLAT WAS PREPARED FOR THE PURPOSE OF ACQUISITION AND EASEMENTS ONLY, AND IS NOT INTENDED TO BE A BOUNDARY SURVEY OF PROPERTY SHOWN.

David H. Snider 4/15/15
 DAVID H. SNIDER, NC P.L.S. L-2942 DATE

STATE OF NORTH CAROLINA
 COUNTY OF MECKLENBURG

REVIEW OFFICER OF MECKLENBURG COUNTY, CERTIFY THAT THE MAP OR PLAT TO WHICH THIS CERTIFICATION IS AFFIXED, MEETS ALL STATUTORY REQUIREMENTS FOR RECORDING.

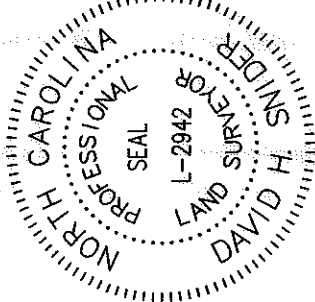
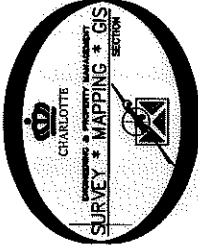

REVIEW OFFICER _____ DATE _____

FAIRCHILD LANE (40' PUBLIC R/W)

S 86°06'30" W 100.01' (TIE) 7.45' 5.00' (S 89°12'40" W 100.07')
 N 86°06'30" E 100.01' (TOTAL) 87.56'

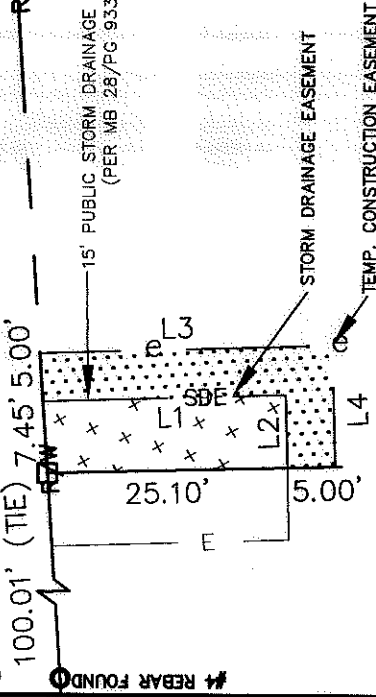

(N 01°21'10" E 136.58')
 N 01°29'19" W 136.51' (TOTAL) 106.41'

②
 22514227
 CYNTHIA L. MILL
 DB 25585/PG 918
 9216 FAIRCHILD LANE

- NOTE:
 1) BEARINGS AND DISTANCE SHOWN IN PARENTHESIS ARE BASED ON RECORDED INFORMATION.
 2) COMPUTED PROJECT DISTANCE -- *
 3) TOTAL AREA
 4) TEMP. CONSTRUCTION EASEMENT 13,667 SQ.FT.
 5) STORM DRAINAGE EASEMENT 190 SQ.FT.
 6) EXISTING PUBLIC STORM DRAINAGE EASEMENT AREA TO BE ACCEPTED BY THE CITY OF CHARLOTTE AS SDE 189 SQ.FT.
 7) EXISTING PUBLIC STORM DRAINAGE EASEMENT AND SDE OVERLAP AREA 189 SQ.FT.
 8) TOTAL AREA REMAINING 13,667 SQ.FT.

| LINE | LENGTH | BEARING |
|------|--------|---------------|
| L1 | 25.38' | S 01°45'00" E |
| L2 | 7.56' | S 88°15'00" W |
| L3 | 30.57' | S 01°45'00" E |
| L4 | 12.58' | S 88°15'00" W |

①
 22514228
 E. THOMAS BOWERS AND WIFE RITA C. BOWERS
 DB 11239/PG 390
 9212 FAIRCHILD LANE

REBAR FOUND
 S 86°00'57" W 99.40' (TIE)

REBAR FOUND
 EUGENE W. MITCHELL AND WIFE FREDIA R. MITCHELL
 DB 4704/PG 432
 9233 RAINTREE LANE

REBAR FOUND
 S 86°15'26" W 83.16'

REBAR FOUND
 S 85°47'45" W 17.47'

22514225
 TAMARA SILVERSTEIN
 DB 28216/PG 712
 9245 RAINTREE LANE

LEGEND

- REBAR OR IRON PIN FOUND
- COMPUTED POINT
- PROPERTY LINES
- EXISTING RIGHT-OF-WAY
- EXISTING EASEMENTS
- TEMP. CONSTRUCTION EASEMENT
- STORM DRAINAGE EASEMENT
- PREPARED BY: CITY OF CHARLOTTE ENGINEERING & PROPERTY MANAGEMENT DEPARTMENT 600 EAST FOURTH STREET CHARLOTTE, NC 28202 704-336-2291.

| | | | |
|--|--|---|------------------------|
| <p>CHARLOTTE ENGINEERING & PROPERTY MANAGEMENT DEPARTMENT</p> | | REVISIONS | JOB NO. SWDES00368 |
| | | <p>9212 FAIRCHILD LANE STORM WATER MAINTENANCE IMPROVEMENT PROJECT</p> | FILE NO. 225-142-27 |
| <p>SCALE 1"=20'</p> | | SHEET 1 | OF 1 |
| <p>DRAWN BY LG</p> | | <p>PROPERTY ACQUISITION OWNER: CYNTHIA L. MILL CHARLOTTE, MECKLENBURG CO., NC</p> | |
| <p>DATE _____</p> | | <p>CHECKED BY DHS SURVEY SUPV. <i>DHS</i></p> | |
| <p>K:\AutoCad\En_su-LD4\SWDES00368-Fairchild.mxd\dwg\Fairchild.mec3D2013.dwg</p> | | | |

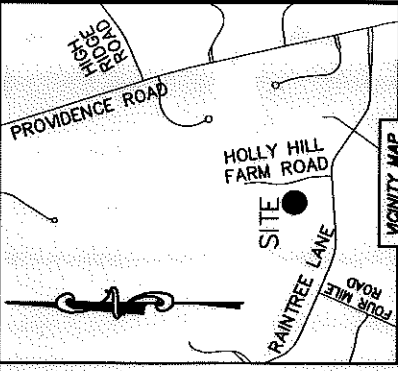

VICINITY MAP
 "not to scale"
 N 71°05'18" E
 116.17' (GROUND)
 1116.15' N

MAG. NAIL
 NC GRID NAD 83 (2011)
 N: 490,129.37 FEET
 E: 1,468,230.71 FEET
 CGF: 0.999850625



(N 01°21'10" E 136.59')
 S 01°45'12" E

22514226
 JEFFERY JAMES MORRIS AND SPOUSE MELISSA WATES MORRIS
 DB 26607/PG 379
 9220 FAIRCHILD LANE