

State of North Carolina
County of Mecklenburg

I, _____, Review Officer of Mecklenburg County, certify that the map or plat to which this certification is affixed meets all statutory requirements for recording.

JAMES E. COLOTTA
TAX CODE: 225-281-55
DB 15848 PG 771

CHARLES W. and
CHRISTOPHER R. HILL
TAX CODE: 225-351-03
DB 5715 PG 318

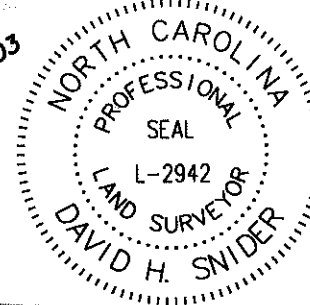

I, DAVID H. SNIDER, CERTIFY THAT THIS PLAT WAS PREPARED UNDER MY SUPERVISION AND THAT THE PLAT WAS PREPARED FOR THE PURPOSE OF EASEMENTS ONLY, AND IS NOT INTENDED TO BE A BOUNDARY SURVEY OF PROPERTY SHOWN.

David H. Snider 9/25/09
DAVID H. SNIDER, NC P.L.S. L-2942 DATE

Review Officer _____ Date _____

N71°41'33"E 172.23'
(N73°42'14"E 172.05')

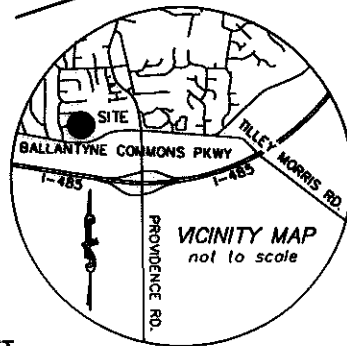

#4 rebar found

NOTE:

- 1) BEARINGS AND DISTANCES SHOWN IN PARENTHESES ARE BASED ON RECORDED MAP INFORMATION.
- 2) TOTAL AREA 20,849 SQ.FT.
- 3) TEMP. CONSTRUCTION EASEMENT 1,004 SQ.FT.
- 4) STORM DRAINAGE EASEMENT 79 SQ.FT.
- 5) SIDEWALK / UTILITY EASEMENT 66 SQ.FT.
- 6) AREA REMAINING 20,849 SQ.FT.

LINE	LENGTH	BEARING
L1	2.10	S00°02'30"W
L2	6.76	S00°02'30"W
L3	0.73	S00°02'30"W
L4	6.47	N10°11'37"E
L5	11.45	S79°48'23"E
L6	12.65	N78°59'30"W
L7	22.49	S79°48'23"E
L8	23.95	S79°48'23"E
L9	49.15	S79°22'00"E
L10	49.01	S79°22'00"E
L11	64.42	S77°44'36"E
L12	59.79	S77°44'36"E
L13	9.30	S18°24'32"E
L14	1.56	S18°24'32"E

LEGEND

NCGS CONTROL MONUMENT

IRON PIN FOUND

CALCULATED POINT

TEMP. CONSTRUCTION EASEMENT

SIDEWALK / UTILITY EASEMENT

STORM DRAINAGE EASEMENT

LINES SURVEYED

LINES NOT SURVEYED

CRESTWOOD DRIVE
(60' RW)
(N161°45'W 109.11')
(N182°43'W 106.28')

ERIC GRUBB and LORRIE LEE PARKS
TAX CODE: 225-281-47
DB 18022 PG 492
10433 CRESTWOOD DRIVE

STORM DRAINAGE EASEMENT
OVERLAPS SIDEWALK/UTILITY
8 SQ.FT.

MITCHELL and BEVERLY KATOWITZ
TAX CODE: 225-351-01
DB 15005 PG 452
5610 BALLANTYNE COMMONS PARKWAY

KNOX NAD83(86)
N 484552.89
E 1474266.96
GRID FACTOR=0.9998448

SEE DETAIL "A"

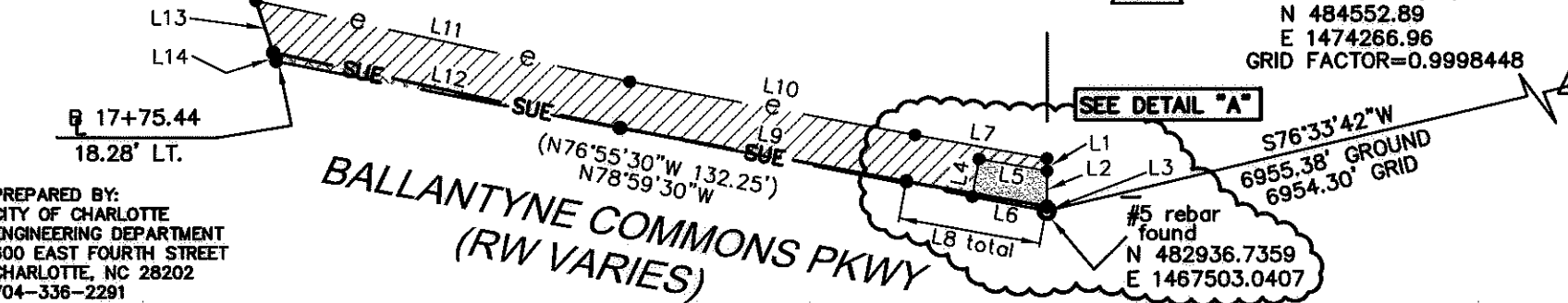

PREPARED BY:
CITY OF CHARLOTTE
ENGINEERING DEPARTMENT
600 EAST FOURTH STREET
CHARLOTTE, NC 28202
704-336-2291

BALLANTYNE COMMONS PKWY
(RW VARIES)
(N76°55'30"W 132.25')
(N78°59'30"W)

DB 25601-854

CHARLOTTE ENGINEERING DEPARTMENT		
REVISIONS	PROVIDENCE I-485 AREA PLAN IMPROVEMENTS	JOB NO. 512-08-007
	OWNER: ERIC GRUBB and LORRIE LEE PARKS TAX PARCEL 225-281-47 CHARLOTTE, MECKLENBURG CO., NC	FILE NO. LAN #208007
SCALE 1"=30'	DRAWN BY G.F.	SHEET 1 OF 1
DATE	CHECKED BY	SURVEY SUPERVISOR
K:\AUTOCAD\en_su-ld4\lan.208007\PLAT MAPS and INFORMATION\Plat-26		