

PARCEL AREA = 2,458,090.80 SQ. FT. 56.43 AC.
 PERM. DRAIN. ESM'T. = 9497.813 SQ. FT. 0.218 AC.

TEMP. CONST. ESM'T. = 27,064,054 SQ. FT. 0.621 AC.
 PREVIOUS TEMP. ESM'T. AREA = 18,455,679 SQ. FT. 0.424 AC.
 ADDITIONAL TEMP. ESM'T. AREA = 8,608,375 SQ. FT. 0.198 AC.
 THIS PARCEL.

NOTE.: SEE SHEETS 2 OF 4, 3 OF 4, AND 4 OF 4 FOR ESM'T. AREAS

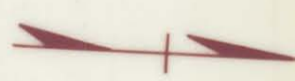
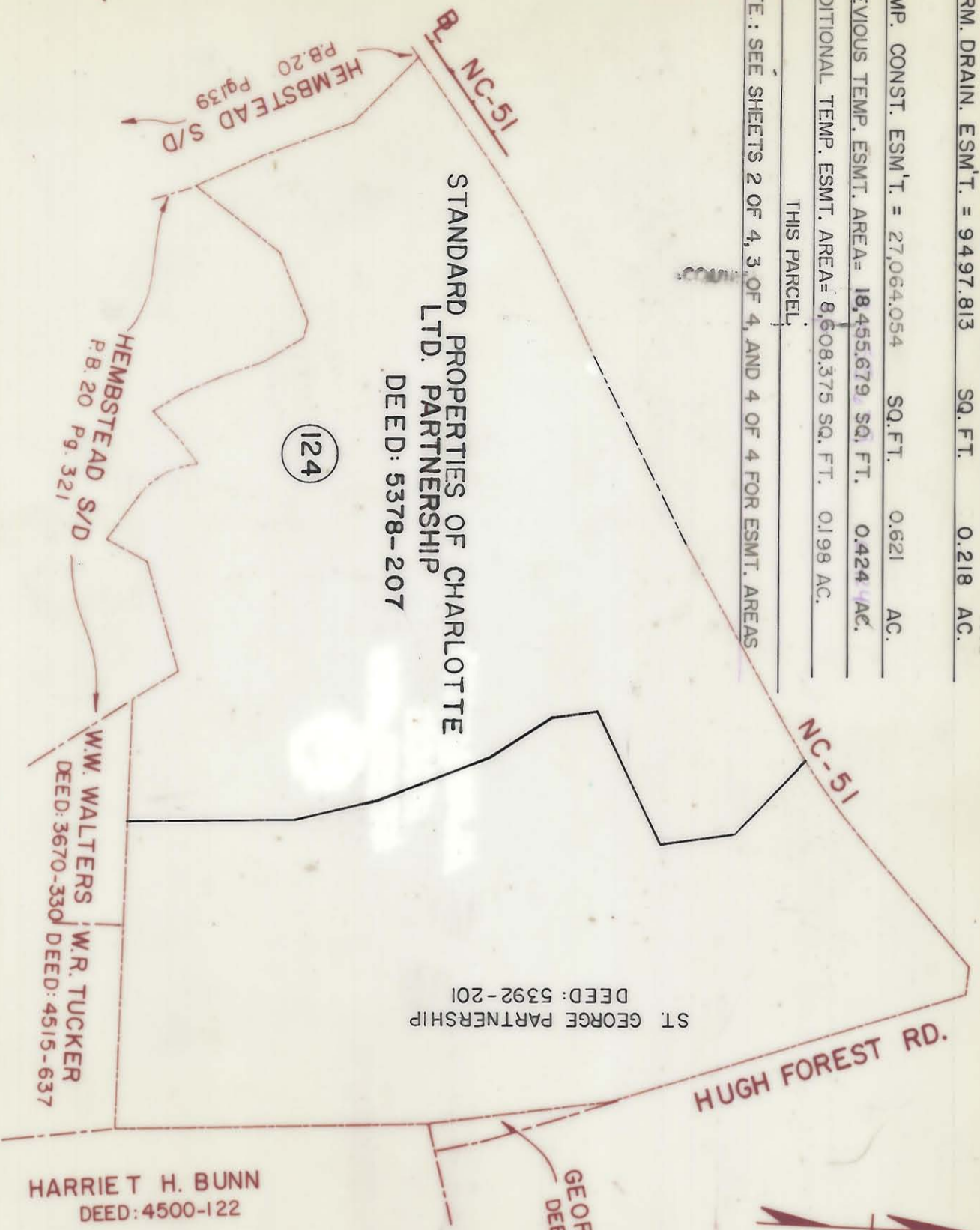

NOTE: Property corners shown circled were located by actual survey. Bearings and distances shown in parenthesis are based on deed information. Bearings are based on

N.C. COORDINATE SYSTEM

This map was prepared for the purpose of right-of-way or easement acquisition only, and is not intended to be a boundary survey of the property shown.

This plat was prepared under my supervision
 9-03-87
 N.C. Reg. Surveyor No. L-3028
Allen E. Beck

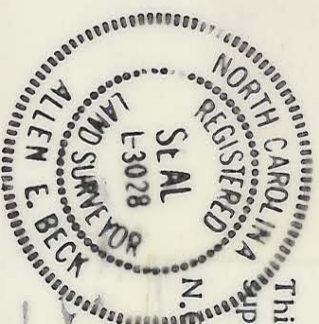

5688-0152
 ACQUISITION 1/28/88

PARCEL ID. # 227-0X-00

<p>CHARLOTTE ENGINEERING DEPARTMENT</p>		<p>REVISIONS</p> <p>10/13/87 OWNER ACJ</p> <p>11/18/87 OWNER ACJ</p>	<p>JOB NO.</p>
<p>PROPOSED R/W NC-51/NC-16 INTERSECTION</p>		<p>DRAWN BY: A.A. SADAT</p> <p>CHECKED BY: AL BECK</p> <p>SURVEY SUPV.R. <i>Allen E. Beck</i></p>	<p>FILE NO.</p>
<p>PROPERTY OF STANDARD PROPERTIES OF CHAR LTD. PARTNERSHIP</p>		<p>DATE: 9/03/87</p> <p>SCALE: 1" = 400'</p>	<p>SHEET 124 A/4</p>
			<p>19</p>

227-26/227-04