

PARCEL AREA = 2,458,090.80 SQ. FT. 56.43 AC.  
 PERM. DRAIN. ESM'T. = 9497.813 SQ. FT. 0.218 AC.

TEMP. CONST. ESM'T. = 27,064,054 SQ. FT. 0.621 AC.  
 PREVIOUS TEMP. ESM'T. AREA = 18,455,679 SQ. FT. 0.424 AC.  
 ADDITIONAL TEMP. ESM'T. AREA = 8,608,375 SQ. FT. 0.198 AC.  
 THIS PARCEL.

NOTE.: SEE SHEETS 2 OF 4, 3 OF 4, AND 4 OF 4 FOR ESM'T. AREAS

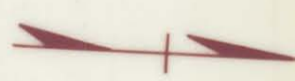
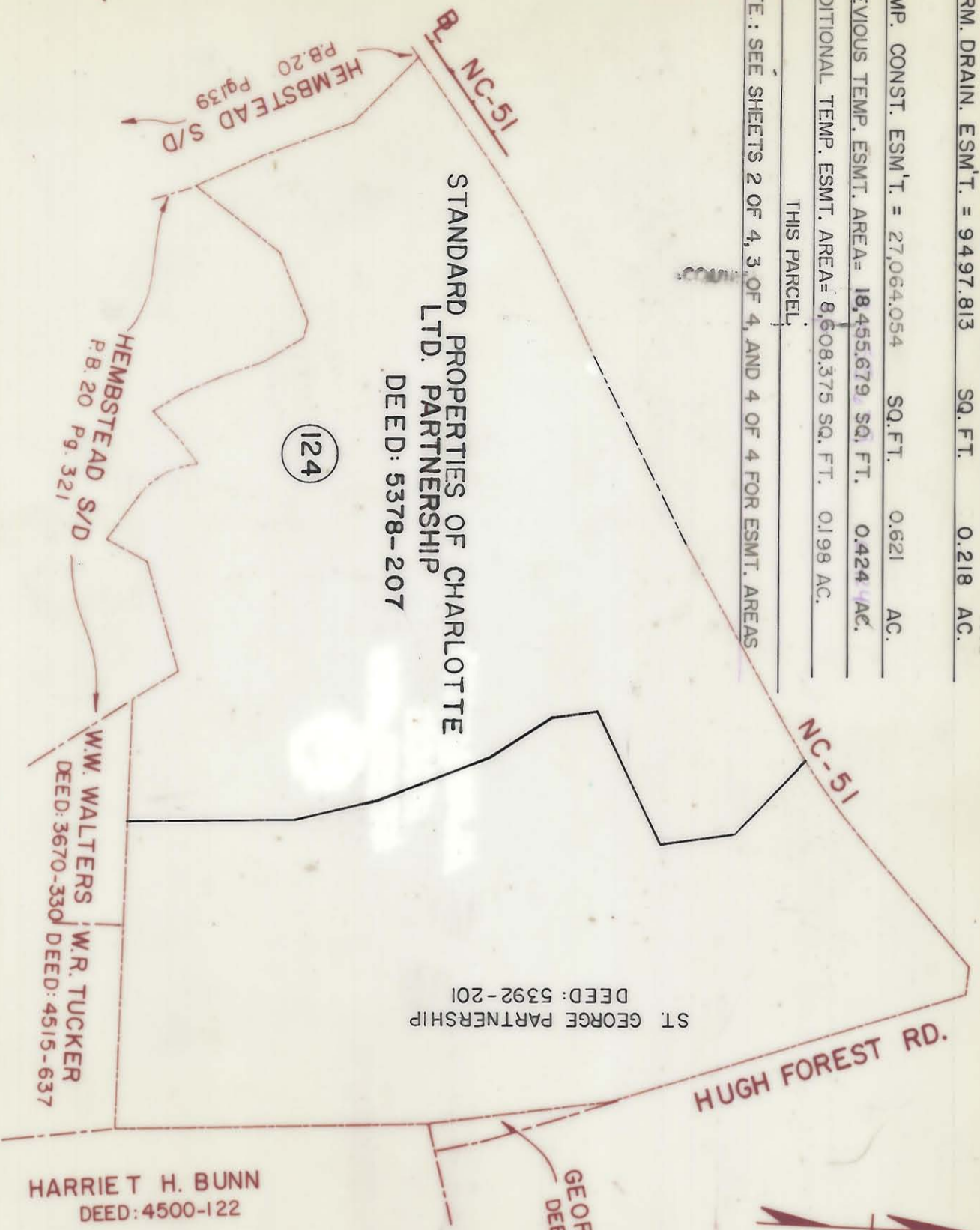

NOTE: Property corners shown circled were located by actual survey. Bearings and distances shown in parenthesis are based on deed information. Bearings are based on

N.C. COORDINATE SYSTEM

This map was prepared for the purpose of right-of-way or easement acquisition only, and is not intended to be a boundary survey of the property shown.

This plat was prepared under my supervision  
 9-03-87  
 N.C. Reg. Surveyor No. L-3028  
Allen E. Beck

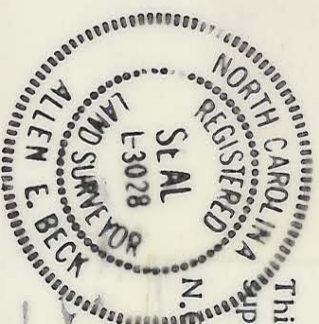

5688-0152  
 ACQUIRED 1/28/88

PARCEL ID. # 227-0X-00

**CHARLOTTE**  
 ENGINEERING DEPARTMENT

PROPOSED R/W  
 NC-51/NC-16  
 INTERSECTION

PROPERTY OF  
 STANDARD PROPERTIES OF CHAR  
 LTD. PARTNERSHIP

REVISIONS	DATE	SCALE	SHEET
10/13/87 OWNER ACJ	9/03/87	1" = 400'	124 A/4
11/18/87 OWNER ACJ			19
DRAWN BY: A.A. SADAT			
CHECKED BY: AL BECK			
SURVEY SUPERVISOR: <i>Allen E. Beck</i>			

227-26/227-04