

Curve Table				
Curve #	Length	Radius	CHORD BEARING	CHORD
C1	31.48	20.00	S67°43'14"W	28.33

027-084-44
KIM VARNER
DB 25926 PG 139
12224 CARDINAL POINT RD

I, DAVID H. SNIDER, CERTIFY THAT THIS PLAT WAS PREPARED UNDER MY SUPERVISION AND THAT THE PLAT WAS PREPARED FOR THE PURPOSE OF EASEMENTS ONLY, AND IS NOT INTENDED TO BE A BOUNDARY SURVEY OF PROPERTY SHOWN.

David H. Snider 9/11/13
DAVID H. SNIDER, NC P.L.S. L-2942 DATE

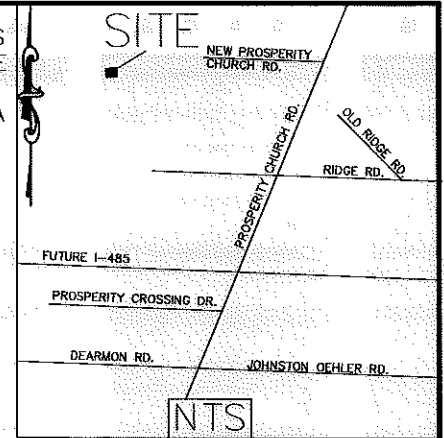
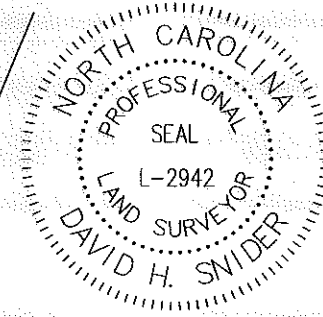

NC GRID NAD 83/2001 MRS

RED CLOVER LN.
50' PUBLIC RIGHT-OF-WAY

LEGEND

- CALCULATED POINT ●
- ____ LINES SURVEYED
- LINES NOT SURVEYED
- [Pattern] TEMP. CONSTRUCTION EASEMENT
- [Pattern] SIDEWALK UTILITY EASEMENT

CARDINAL POINT RD.
50' PUBLIC RIGHT-OF-WAY

N67°15'14"W 110.40' TOTAL
(N68°08'24"W 110.15') TOTAL

027-084-45
JOHN D. BENJAMIN AND JOHN W. BENJAMIN AND ELAINE BENJAMIN
DB 27604 PG 218
6246 RED CLOVER LN

- 1) BEARINGS AND DISTANCES SHOWN IN PARENTHESES ARE BASED ON RECORDED MAP INFORMATION.
- 2) TOTAL AREA 11,023 SQ. FT.
- 3) TEMP CONSTRUCTION EASEMENT 150 SQ. FT.
- 4) SIDEWALK UTILITY EASEMENT 7 SQ. FT.
- 5) AREA REMAINING 11,023 SQ. FT.

STATE OF NORTH CAROLINA
COUNTY OF MECKLENBURG

I, _____, REVIEW OFFICER OF MECKLENBURG COUNTY, CERTIFY THAT THE MAP OR PLAT TO WHICH THIS CERTIFICATION IS AFFIXED MEETS ALL STATUTORY REQUIREMENTS FOR RECORDING.

REVIEW OFFICER _____ DATE _____

COMBINED GRID
FACTOR= 0.999841662
N: 596407.97
E: 1466490.81

Line Table		
Line #	Length	Direction
L1	25.23	N19°47'52"W
L2	10.92	N67°15'14"W
L3	6.03	N67°15'14"W
L4	6.46	N46°23'01"W
L5	16.21	S22°37'46"W
L6	2.30	S22°37'46"W

027-084-46
TODD A. TUCKER AND SABRINA A. PAGAN
DB 10931 PG 4
6240 RED CLOVER LN

N67°27'35"W 130.46'
(N68°19'10"W 130.21') TOTAL

027-561-04
EASON FAMILY PROPERTIES LLC
DB 26941 PG 261
5901 PROSPERITY CHURCH RD

PREPARED BY:
CITY OF CHARLOTTE
ENGINEERING DEPARTMENT
600 EAST FOURTH STREET
CHARLOTTE, NC 28202
704-336-2291

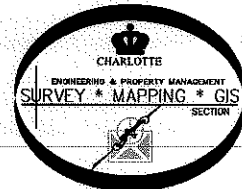

		CHARLOTTE ENGINEERING DEPARTMENT	
REVISIONS		PROSPERITY VILLAGE NW ARC B	
SCALE 0 1" = 20" 1"			
DRAWN BY P.S.		PROPERTY OF JOHN D. BENJAMIN AND JOHN W. BENJAMIN AND ELAINE BENJAMIN CHARLOTTE, MECKLENBURG CO., NC	
DATE			
CHECKED BY DS		SURVEY SUPVR. <i>DK</i>	
JOB NO. 512-14-003		214003	
SHEET 1		OF 1	
K: \AutoCad\En_su-LD4\214003 Prosperity Village NW B\Plats\#9 027-566-01			