

I, DAVID H. SNIDER, CERTIFY THAT THIS PLAT WAS PREPARED UNDER MY SUPERVISION AND THAT THE PLAT WAS PREPARED FOR THE PURPOSE OF ACQUISITION AND EASEMENTS ONLY, AND IS NOT INTENDED TO BE A BOUNDARY SURVEY OF PROPERTY SHOWN.

David H. Snider 10/17/13
 DAVID H. SNIDER, NC P.L.S. L-2942 DATE

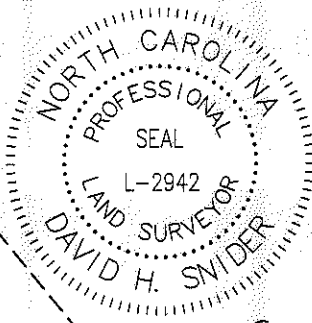
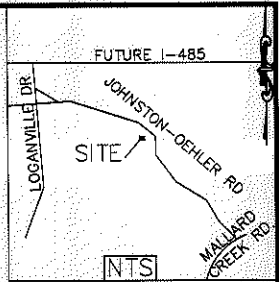

REVIEW OFFICER OF MECKLENBURG COUNTY, CERTIFY THAT THE MAP OR PLAT TO WHICH THIS CERTIFICATION IS AFFIXED MEETS ALL STATUTORY REQUIREMENTS FOR RECORDING.

REVIEW OFFICER _____ DATE _____

MALLARD CREEK REGIONAL PARK
 MECKLENBURG COUNTY
 TAX CODE: 029-342-33
 DB 5353 PG 858
 MAP BOOK 47 PAGE 327 (PARCEL 2)
 2530 JOHNSTON-OEHLER RD

33

(N00°20'50"E 1160.75')
 N21°19'E 1069.35'

JEFFERY O. RABORN
 JOAN MCANULTY
 TAX PARCEL: 029-331-18
 DB 24510 PG 925
 2915 JOHNSTON OEHLER RD

#3REBAR FOUND
 N40°32'10"W 171.45'
 (N42°22'56"W 171.37')
 S49°26'58"W 249.90'
 (S47°37'04"W 252.74')
 188.16'
 (N47°37'04"E 257.30')
 (S43°48'28"E 291.57')
 (S45°39'00"E 292.49')

42

JEFFREY O. RABORN
 JAY SCOTT RABORN
 TAX CODE: 029-331-02
 DB 13779 PG 802
 LESS MB 47 PG 543
 LESS MB 25 PG 844
 2821 JOHNSTON OEHLER RD

SEE DETAIL PAGE 2

(VARIABLE RIGHT-OF-WAY)
 JOHNSTON-OEHLER ROAD

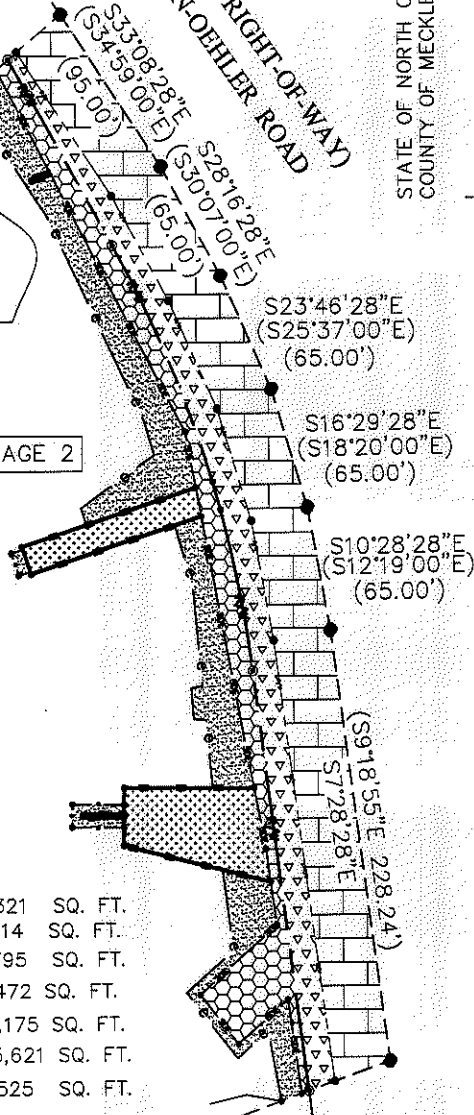

NOTES:

- 1.) BEARINGS AND DISTANCES SHOWN IN PARENTHESES ARE BASED ON RECORDED MAP INFORMATION.
- 2.) TOTAL AREA 320,321 SQ. FT.
- 3.) TEMP CONSTRUCTION EASEMENT 13,314 SQ. FT.
- 4.) STORM DRAINAGE EASEMENT 7,795 SQ. FT.
- 5.) UTILITY EASEMENT 4,472 SQ. FT.
- 6.) FEE SIMPLE OUTSIDE EXISTING R/W 10,175 SQ. FT.
- 7.) FEE SIMPLE INSIDE EXISTING R/W 25,621 SQ. FT.
- 8.) AREA REMAINING 284,525 SQ. FT.

WALTER SAMUEL RABORN AND JOHNSIE R. RABORN
 TAX PARCEL: 029-331-17
 DB 10878 PG 553
 R/W MB 25 PG844
 2801 JOHNSTON OEHLER RD

N20°09'20"W
 (N22°00'00"W)
 (70.00')

S69°50'29"W 320.09'
 (S68°00'00"W 380.76' total)

flat iron found
 NAD 83(2007)
 COMBINED GRID
 FACTOR=0.999842
 N.590082.46
 E.1475301.97

WALTER S. RABORN AND JOHNSIE R. RABORN
 TAX PARCEL: 029-331-01
 DB 1427 PG 489
 2715 JOHNSTON OEHLER RD

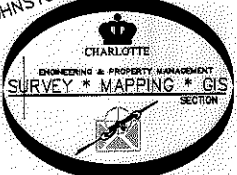

PREPARED BY:
 CITY OF CHARLOTTE
 ENGINEERING DEPARTMENT
 600 EAST FOURTH STREET
 CHARLOTTE, NC 28202
 704-336-2291

		CHARLOTTE ENGINEERING DEPARTMENT	
REVISIONS	JOHNSTON-OEHLER ROAD FTM	JOB NO.	512-09-023
10/17/13 OWNERSHIP		209023	SHEET
SCALE 0 1"=100' 1"	PROPERTY OF JEFFREY O. RABORN JAY SCOTT RABORN	OF	4
DRAWN BY P.S.	CHARLOTTE, MECKLENBURG CO., NC	DATE	CHECKED BY DS SURVEY SUPVR. <i>DSR</i>
K:\AutoCad\En-su-LD4\209023 JOHNSON OEHLER RD\Plat-42			

I, DAVID H. SNIDER, CERTIFY THAT THIS PLAT WAS PREPARED UNDER MY SUPERVISION AND THAT THE PLAT WAS PREPARED FOR THE PURPOSE OF ACQUISITION AND EASEMENTS ONLY, AND IS NOT INTENDED TO BE A BOUNDARY SURVEY OF PROPERTY SHOWN.

David H. Snider 10/17/13
 DAVID H. SNIDER, NC P.L.S. L-2942 DATE

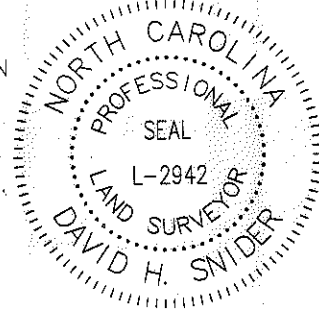

STATE OF NORTH CAROLINA
 COUNTY OF MECKLENBURG

I, _____, REVIEW OFFICER OF MECKLENBURG COUNTY, CERTIFY THAT THE MAP OR PLAT TO WHICH THIS CERTIFICATION IS AFFIXED MEETS ALL STATUTORY REQUIREMENTS FOR RECORDING.

REVIEW OFFICER _____ DATE _____

(VARIABLE RIGHT-OF-WAY)
 JOHNSTON-OEHLER ROAD

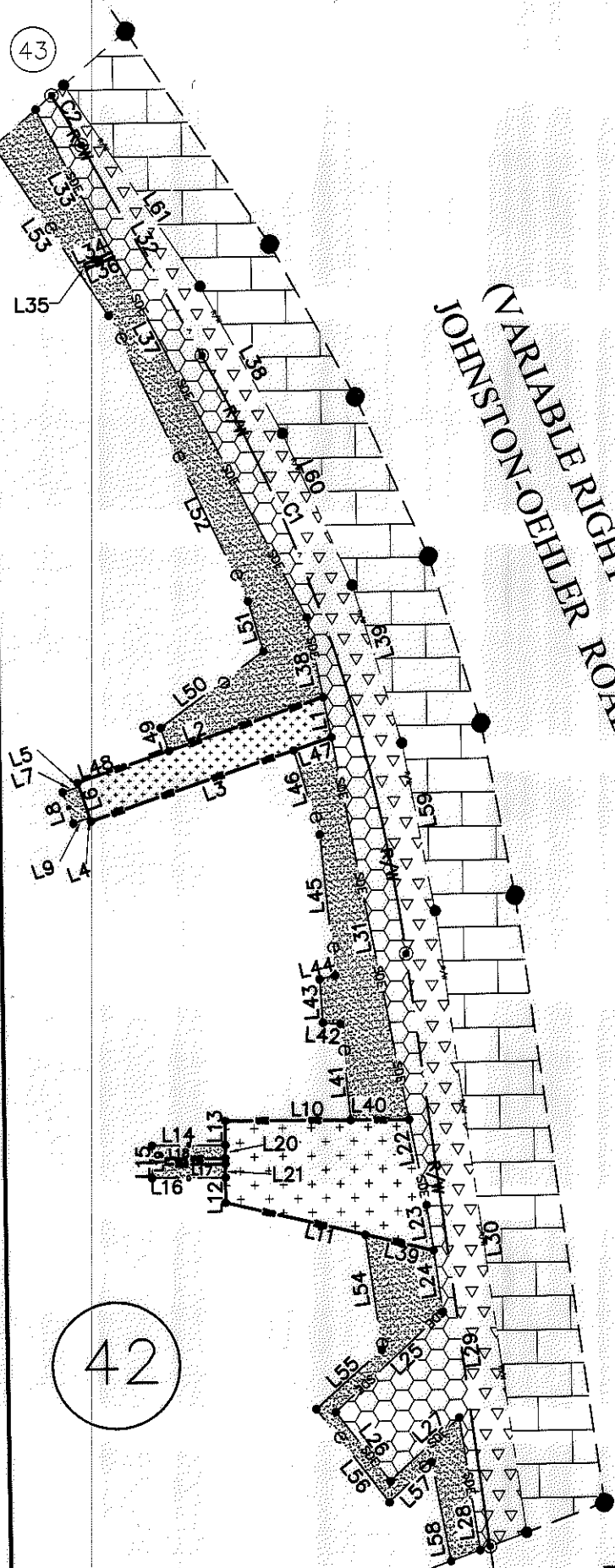

LEGEND

- IRON PIN SET
- IRON PIN FOUND
- CALCULATED POINT
- LINE SURVEYED
- LINE NOT SURVEYED
- TEMP. CONSTRUCTION EASEMENT
- STORM DRAINAGE EASEMENT
- UTILITY EASEMENT
- FEE SIMPLE INSIDE EXISTING R/W
- FEE SIMPLE OUTSIDE EXISTING R/W



42

S69°50'29"W 320.09'

PREPARED BY:
 CITY OF CHARLOTTE
 ENGINEERING DEPARTMENT
 600 EAST FOURTH STREET
 CHARLOTTE, NC 28202
 704-336-2291

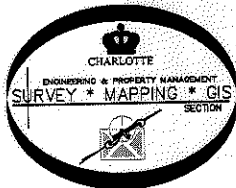

CHARLOTTE ENGINEERING DEPARTMENT		JOB NO. 512-09-023
JOHNSTON-OEHLER ROAD FTM		209023
10/17/13 OWNERSHIP	PROPERTY OF JEFFREY O. RABORN JAY SCOTT RABORN CHARLOTTE, MECKLENBURG CO., NC	SHEET 2
SCALE 0 1" = 60' 1"	DRAWN BY P.S.	OF 4
DATE	CHECKED BY DS	SURVEY SUPVR. <i>DH</i>
K:\AutoCad\En_su-LD4\209023 JOHNSON OEHLER RD\Plat-42		

ACQUISITION BY DB 29047 PG 654

I, DAVID H. SNIDER, CERTIFY THAT THIS PLAT WAS PREPARED UNDER MY SUPERVISION AND THAT THE PLAT WAS PREPARED FOR THE PURPOSE OF ACQUISITION AND EASEMENTS ONLY, AND IS NOT INTENDED TO BE A BOUNDARY SURVEY OF PROPERTY SHOWN.

David H. Snider 10/17/13
 DAVID H. SNIDER, NC P.L.S. L-2942 DATE

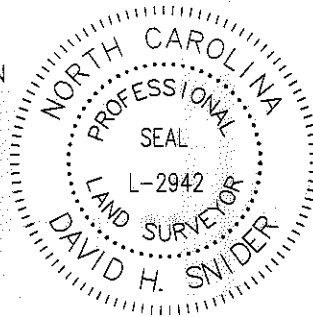

STATE OF NORTH CAROLINA
 COUNTY OF MECKLENBURG

I, _____, REVIEW OFFICER OF MECKLENBURG COUNTY, CERTIFY THAT THE MAP OR PLAT TO WHICH THIS CERTIFICATION IS AFFIXED MEETS ALL STATUTORY REQUIREMENTS FOR RECORDING.

REVIEW OFFICER _____ DATE _____

Line Table		
Line #	Length	Direction
L1	15.14	S10°39'58"E
L2	60.22	S71°29'14"W
L3	79.00	N71°29'14"E
L4	1.50	S18°30'46"E
L5	1.50	S18°30'46"E
L6	12.00	S18°30'46"E
L7	6.33	S71°29'14"W
L8	12.00	S18°30'46"E
L9	6.33	N71°29'14"E
L10	46.25	S89°32'35"E
L11	52.86	N76°00'00"W
L12	9.42	N00°32'26"E
L13	9.00	N00°32'26"E
L14	26.99	S89°27'13"E
L15	12.00	N00°32'47"E
L16	26.99	N89°27'13"W
L17	21.99	N89°27'13"W
L18	21.99	S89°27'34"E
L19	2.00	N00°32'47"E
L20	5.00	N00°32'26"E
L21	5.00	N00°32'26"E
L22	32.52	S10°39'58"E
L23	17.13	S07°51'43"E
L24	22.87	S07°51'43"E
L25	54.33	S47°34'24"W
L26	32.67	S37°03'41"E
L27	34.78	N48°01'36"E
L28	49.94	S07°51'43"E
L29	222.34	S07°09'55"E
L30	233.43	S07°27'54"E
L31	144.66	S10°39'58"E
L32	89.81	S28°45'07"E
L33	59.63	S27°07'19"E
L34	10.96	S66°19'13"W
L35	2.00	S23°40'47"E

L36	11.08	N66°19'13"E
L37	151.53	S27°07'19"E
L38	62.55	S28°16'31"E
L39	61.51	S16°29'31"E
L40	21.51	S89°32'35"E
L41	35.74	S05°22'54"E
L42	6.42	S85°28'07"E
L43	16.27	S03°38'15"E
L44	5.87	S78°07'12"W
L45	52.87	S05°22'54"E
L46	32.48	S16°29'05"E
L47	14.71	N71°29'14"E
L48	35.56	S71°29'14"W
L49	9.07	S18°31'00"E
L50	47.32	S53°58'23"W
L51	19.65	S16°12'51"E
L52	117.74	S25°00'27"E
L53	75.73	S33°03'31"E
L54	42.86	S07°16'32"E
L55	32.81	S48°10'52"W
L56	43.79	S37°03'41"E
L57	21.47	N47°26'13"E
L58	37.56	S10°09'03"E
L59	63.42	S10°28'31"E
L60	61.91	S23°46'31"E
L61	89.81	S33°08'31"E

Curve Table				
Curve #	Length	Radius	CHORD BEARING	CHORD
C1	235.85	626.00	N17°57'31"W	234.46
C2	21.38	471.00	S30°03'09"E	21.38

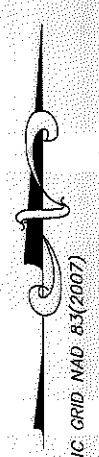

PREPARED BY:
 CITY OF CHARLOTTE
 ENGINEERING DEPARTMENT
 600 EAST FOURTH STREET
 CHARLOTTE, NC 28202
 704-336-2291



REVISIONS		JOB NO.	
10/17/13 OWNERSHIP SCALE 1"=60'		512-09-023	
DRAWN BY P.S.		209023	
DATE _____		SHEET 3	
CHECKED BY DS		OF 4	
SURVEY SUPR. <i>DSR</i>			
K:\AutoCad\En_su-LD4\209023 JOHNSON OEHLER RD\Plat-42			

I, DAVID H. SNIDER, CERTIFY THAT THIS PLAT WAS PREPARED UNDER MY SUPERVISION AND THAT THE PLAT WAS PREPARED FOR THE PURPOSE OF ACQUISITION AND EASEMENTS ONLY, AND IS NOT INTENDED TO BE A BOUNDARY SURVEY OF PROPERTY SHOWN.

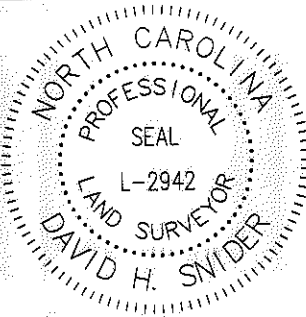

David H. Snider 10/17/13
 DAVID H. SNIDER, NC P.L.S. L-2942 DATE

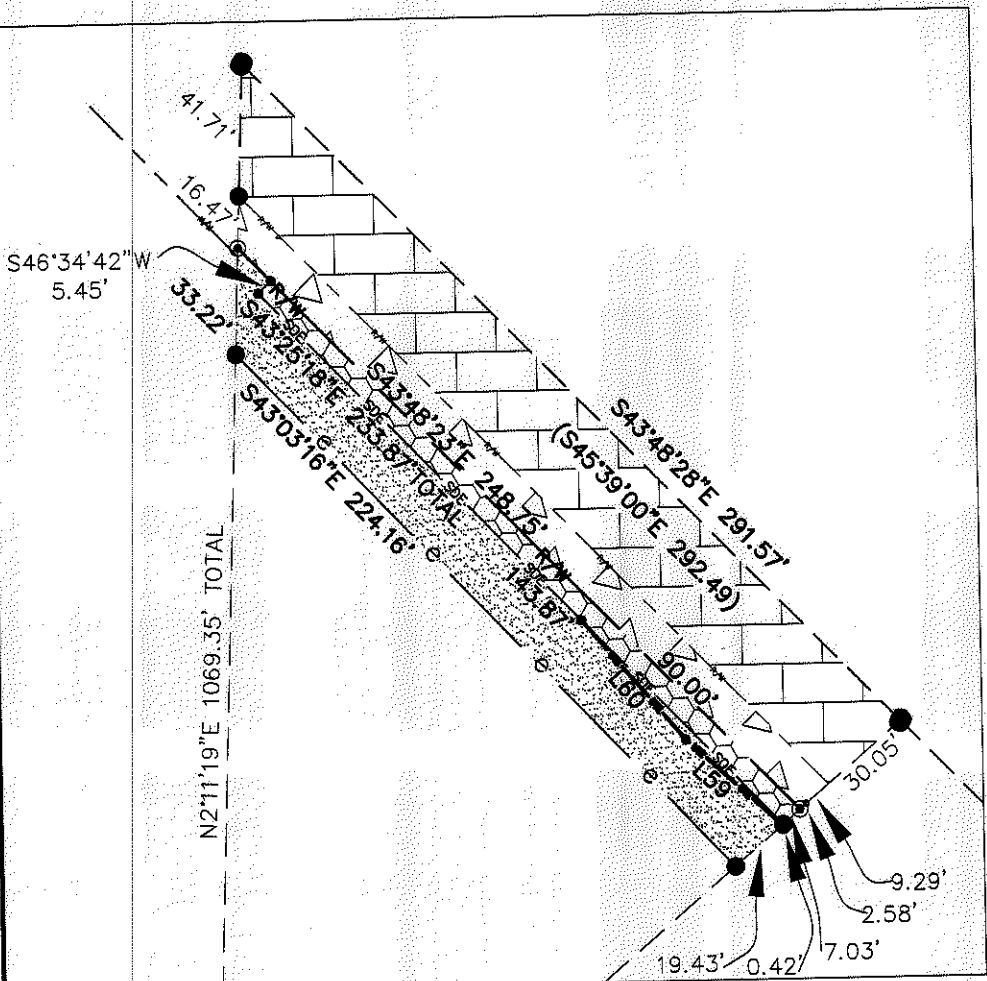

Line Table		
Line #	Length	Direction
L59	40.39	S47°07'44\"E
L60	49.76	S39°55'39\"E

STATE OF NORTH CAROLINA
 COUNTY OF MECKLENBURG

I, _____ REVIEW OFFICER OF MECKLENBURG COUNTY, CERTIFY THAT THE MAP OR PLAT TO WHICH THIS CERTIFICATION IS AFFIXED MEETS ALL STATUTORY REQUIREMENTS FOR RECORDING.

REVIEW OFFICER _____ DATE _____

PREPARED BY:
 CITY OF CHARLOTTE
 ENGINEERING DEPARTMENT
 600 EAST FOURTH STREET
 CHARLOTTE, NC 28202
 704-336-2291

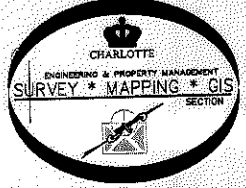

REVISIONS		JOB NO. 512-09-023
10/17/13 OWNERSHIP		
SCALE 1"=60'		SHEET 4
DRAWN BY P.S.		OF 4
DATE		PROPERTY OF JEFFREY O. RABORN JAY SCOTT RABORN CHARLOTTE, MECKLENBURG CO., NC
CHECKED BY DS		SURVEY SUPVR. <i>DH</i>
K:\AutoCad\En_su-LD4\209023 JOHNSON-OEHLER RD\Plat-42		