

I, DAVID H. SNIDER, CERTIFY THAT THIS PLAT WAS PREPARED UNDER MY SUPERVISION AND THAT THE PLAT WAS PREPARED FOR THE PURPOSE OF EASEMENTS ONLY, AND IS NOT INTENDED TO BE A BOUNDARY SURVEY OF PROPERTY SHOWN.

David H. Snider 10/11/13
 DAVID H. SNIDER, NC P.L.S. L-2942 DATE

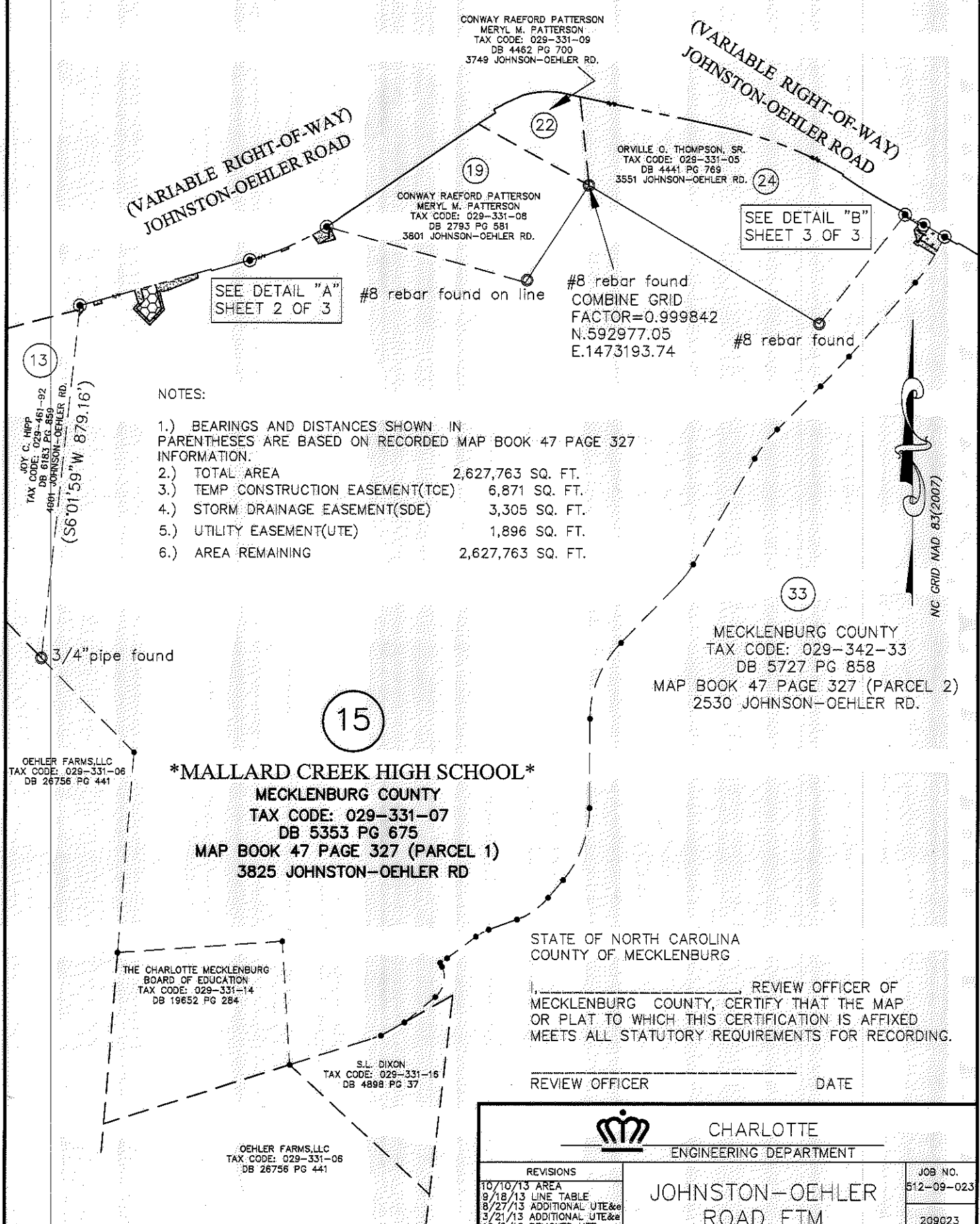

- NOTES:
- 1.) BEARINGS AND DISTANCES SHOWN IN PARENTHESES ARE BASED ON RECORDED MAP BOOK 47 PAGE 327 INFORMATION.
 - 2.) TOTAL AREA 2,627,763 SQ. FT.
 - 3.) TEMP CONSTRUCTION EASEMENT(TCE) 6,871 SQ. FT.
 - 4.) STORM DRAINAGE EASEMENT(SDE) 3,305 SQ. FT.
 - 5.) UTILITY EASEMENT(UTE) 1,896 SQ. FT.
 - 6.) AREA REMAINING 2,627,763 SQ. FT.

PREPARED BY:
 CITY OF CHARLOTTE
 ENGINEERING DEPARTMENT
 600 EAST FOURTH STREET
 CHARLOTTE, NC 28202
 704-336-2291

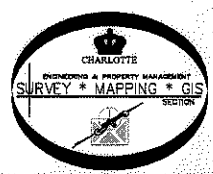

 CHARLOTTE ENGINEERING DEPARTMENT		JOB NO. 512-09-023
JOHNSTON-OEHLER ROAD FTM		209023
PROPERTY OF MECKLENBURG COUNTY		SHEET 1
CHARLOTTE, MECKLENBURG CO., NC		OF 3
K: \AutoCad\En_su-LD4\209023.JOHNSON OEHLER RD\Plat-15		

I, DAVID H. SNIDER, CERTIFY THAT THIS PLAT WAS PREPARED UNDER MY SUPERVISION AND THAT THE PLAT WAS PREPARED FOR THE PURPOSE OF EASEMENTS ONLY, AND IS NOT INTENDED TO BE A BOUNDARY SURVEY OF PROPERTY SHOWN.

David H. Snider 10/11/13
 DAVID H. SNIDER, NC P.L.S. L-2942 DATE

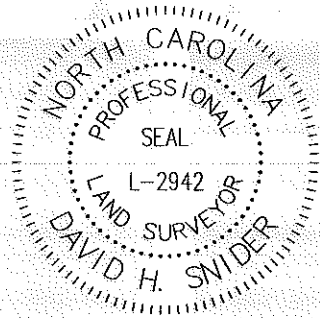

Curve Table				
Curve #	Length	Radius	CHORD BEARING	CHORD
C1	40.17	718.48	N59°22'13"E	40.16
C2	68.08	718.48	N63°41'11"E	68.06
C3	19.00	718.48	N67°09'32"E	19.00
C4	80.76	718.48	N71°08'12"E	80.72

LEGEND

- IRON PIN SET ●
- IRON PIN FOUND ○
- CALCULATED POINT ●
- LINES SURVEYED _____
- LINES NOT SURVEYED - - - - -

- TEMP. CONSTRUCTION EASEMENT
- STORM DRAINAGE EASEMENT
- UTILITY EASEMENT

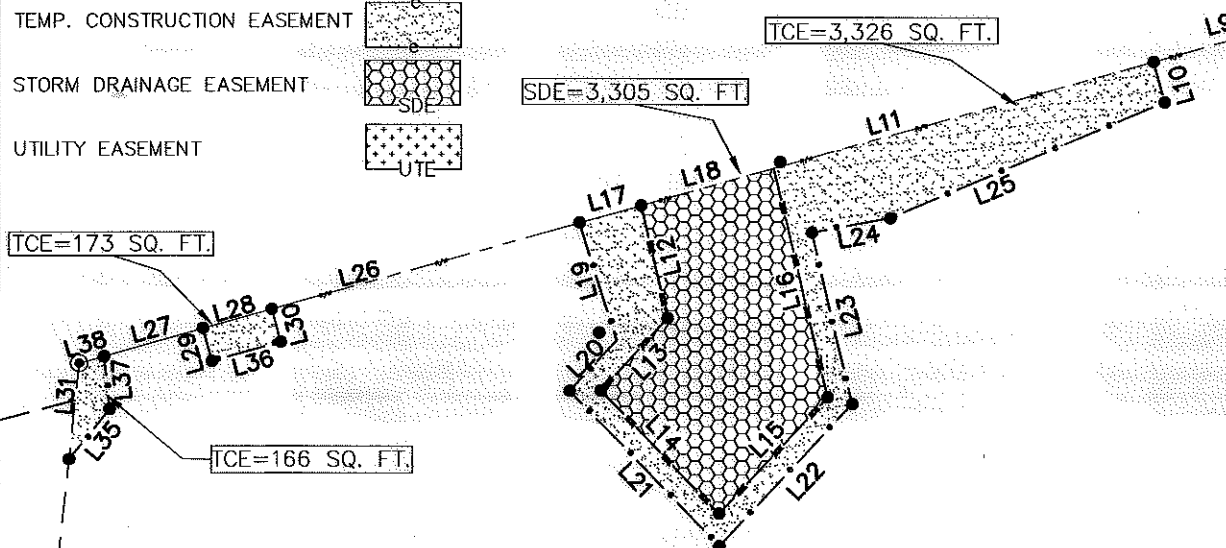

Line Table		
Line #	Length	Direction
L1	9.18	N74°22'28"W
L2	42.91	N74°31'58"E
L3	31.31	N24°04'03"W
L4	26.56	S33°55'06"E
L5	4.66	N23°11'45"W
L6	4.78	S23°11'45"E
L7	19.00	N66°48'15"E
L8	4.00	S15°38'36"E
L9	35.99	N74°21'24"E
L10	11.23	N15°34'53"W
L11	105.73	N74°21'24"E
L12	30.79	N13°25'42"W
L13	26.34	S42°50'11"W
L14	45.64	S44°08'49"E
L15	42.58	N43°16'07"E

L16	62.71	S13°25'42"E
L17	17.04	N74°21'24"E
L18	37.03	N74°21'24"E
L19	32.82	S17°27'50"E
L20	18.34	S42°50'11"W
L21	57.61	S44°08'49"E
L22	52.10	N43°16'07"E
L23	46.91	N13°25'42"W
L24	21.29	N79°30'58"E
L25	79.88	N67°12'21"E
L26	85.52	N74°21'24"E

L27	27.67	N74°21'24"E
L28	19.01	N74°21'24"E
L29	9.08	S15°26'25"E
L30	9.10	N15°26'25"W
L31	25.71	S06°01'59"W
L32	22.00	N01°22'17"W
L33	2.00	S88°37'43"E
L34	28.19	S59°27'49"W
L35	17.09	S38°39'12"W
L36	19.00	N74°33'35"E
L37	14.12	S05°57'13"E
L38	6.76	N74°21'24"E
L39	22.00	S56°34'24"E
L40	4.05	S41°12'11"W

DETAIL "A"

PREPARED BY:
 CITY OF CHARLOTTE
 ENGINEERING DEPARTMENT
 600 EAST FOURTH STREET
 CHARLOTTE, NC 28202
 704-336-2291

CHARLOTTE
ENGINEERING DEPARTMENT

REVISIONS 10/10/13 AREA 9/18/13 LINE TABLE 8/27/13 ADDITIONAL UTE&c 3/21/13 ADDITIONAL UTE&c 12/5/12 REMOVED UTE	JOHNSTON-OEHLER ROAD FTM	JOB NO. 512-09-023 209023
SCALE 0' NOT TO SCALE 0' 	PROPERTY OF MECKLENBURG COUNTY CHARLOTTE, MECKLENBURG CO., NC	SHEET 2 OF 3
DRAWN BY: G.F. DATE:	CHECKED BY DS SURVEY SUPVR. <i>DH</i>	

K: \AutoCad\En_su-LD4\209023 JOHNSON OEHLER RD\Plat-15

I, DAVID H. SNIDER, CERTIFY THAT THIS PLAT WAS PREPARED UNDER MY SUPERVISION AND THAT THE PLAT WAS PREPARED FOR THE PURPOSE OF EASEMENTS ONLY, AND IS NOT INTENDED TO BE A BOUNDARY SURVEY OF PROPERTY SHOWN.

David H. Snider 10/11/13
 DAVID H. SNIDER, NC P.L.S. L-2942 DATE

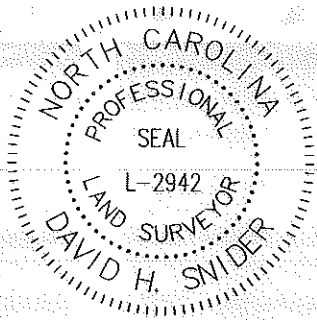

(24)
 ORVILLE O. THOMPSON, SR.
 TAX CODE: 029-331-05
 DB 4441 PG 769
 3551 JOHNSON-OEHLER RD.

DETAIL "B"

TCE=1,760 SQ. FT.

UTE=1,852 SQ. FT.

Line Table		
Line #	Length	Direction
L41	47.56	S59°00'11"E
L42	24.28	S16°38'22"E
L43	18.44	S37°07'46"W
L44	22.00	N01°22'17"W
L45	2.00	S88°37'43"E
L46	3.51	S37°45'00"W
L47	41.06	S59°24'27"E
L48	11.22	S41°12'11"W
L49	12.00	S48°47'49"E
L50	38.80	S28°05'42"W
L51	9.99	S28°05'42"W
L52	49.62	N56°40'31"W
L53	2.00	N48°47'49"W
L54	25.94	N41°12'11"E
L55	20.96	N56°40'31"W
L56	2.00	N33°19'29"E
L57	97.69	N74°21'24"E
L58	20.20	N33°46'20"E

Curve Table				
Curve #	Length	Radius	CHORD BEARING	CHORD
C5	52.19	2160.88	N61°32'09"W	52.19
C6	44.97	2133.88	N59°50'22"W	44.97
C7	1.73	370.28	N28°13'45"E	1.73
C8	15.06	2133.88	N60°38'44"W	15.06
C9	84.92	370.28	S34°56'01"W	84.74

CHARLOTTE
ENGINEERING DEPARTMENT

REVISIONS 10/10/13 AREA 9/18/13 LINE TABLE 8/27/13 ADDITIONAL UTE&e 3/21/13 ADDITIONAL UTE&e 12/5/12 REMOVED UTE	JOHNSTON-OEHLER ROAD FTM PROPERTY OF MECKLENBURG COUNTY CHARLOTTE, MECKLENBURG CO., NC	JOB NO. 512-09-023 209023 SHEET 3 OF 3
SCALE 0' NOT TO SCALE 0' DRAWN BY: G.F. DATE: _____ CHECKED BY DS SURVEY SUPVR.		

K:\AutoCad\En_su-LD4\209023 JOHNSTON OEHLER RD\Plat-15

NC GRID NAD 83(2007)

PREPARED BY:
 CITY OF CHARLOTTE
 ENGINEERING DEPARTMENT
 600 EAST FOURTH STREET
 CHARLOTTE, NC 28202
 704-336-2291