

I, DAVID H. SNIDER, CERTIFY THAT THIS PLAT WAS PREPARED UNDER MY SUPERVISION AND THAT THE PLAT WAS PREPARED FOR THE PURPOSE OF ACQUISITION AND EASEMENTS ONLY, AND IS NOT INTENDED TO BE A BOUNDARY SURVEY OF PROPERTY SHOWN.

*David H. Snider* 1/16/13  
 DAVID H. SNIDER, NC P.L.S. L-2942 DATE

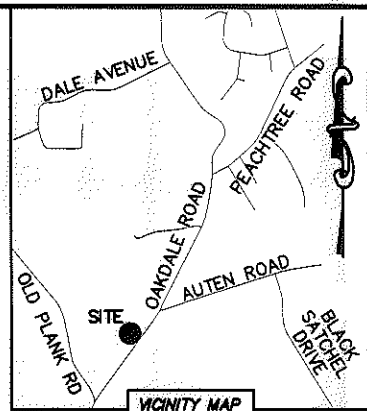
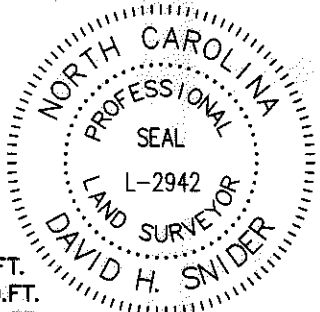

NOTE:

- 1) BEARINGS AND DISTANCE SHOWN IN PARENTHESIS ARE BASED ON RECORDED INFORMATION.
- 2) COMPUTED PROJECT DISTANCE - \*
- 3) TOTAL AREA 35,342 SQ.FT.
- 4) TEMP. CONSTRUCTION EASEMENT 3,231 SQ.FT.
- 5) UTILITY EASEMENT 25 SQ.FT.
- 6) FEE SIMPLE OUTSIDE EXISTING R/W 3,215 SQ.FT.
- 7) SIDEWALK/UTILITY EASEMENT 2,338 SQ.FT.
- 8) STORM DRAINAGE EASEMENT 382 SQ.FT.
- 9) TCE AND EXISTING EASEMENT OVERLAP AREA 672 SQ.FT.
- 10) SUE AND EXISTING EASEMENT OVERLAP AREA 375 SQ.FT.
- 11) SUE AND SDE OVERLAP AREA 187 SQ.FT.
- 12) FEE SIMPLE INSIDE EXISTING R/W 1,744 SQ.FT.

NOTE: (CONTINUED)

- 13) WATER LINE EASEMENT 198 SQ.FT.
- 14) WLE AND SUE OVERLAP AREA 2,338 SQ.FT.
- 15) WLE AND UTE OVERLAP AREA 4 SQ.FT.
- 16) WLE AND SDE OVERLAP AREA 15 SQ.FT.
- 17) TOTAL AREA REMAINING 30,383 SQ.FT.
- 18) SEE PAGE TWO FOR DETAILS AND TABLES.

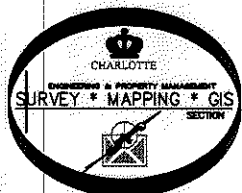

03503128  
 ROBERT CAROL YARBROUGH AND SARA DUNN  
 DB 8622/Pg 718  
 OAKDALE ROAD

03503120  
 ROBERT CAROL YARBROUGH AND WIFE SARA DUNN YARBROUGH  
 DB 1766/Pg 127  
 515 OAKDALE ROAD

03503119  
 ROBERT C. YARBOROUGH AND WIFE SARA D. YARBOROUGH  
 DB 3628/Pg 915  
 507 OAKDALE ROAD

LEGEND

REBAR OR IRON PIN FOUND	○
#5 REBAR SET OR PK NAIL	●
COMPUTED POINT	□
PROPERTY LINES	---
EXISTING RIGHT-OF-WAY	---
EXISTING R/W BY MAINTENANCE	---
NEW RIGHT-OF-WAY	---
STORM DRAINAGE EASEMENT	SDE SDE
UTILITY EASEMENT	UTE UTE UTE
SIDEWALK/UTILITY EASEMENT	SUE SUE
TEMP. CONSTRUCTION EASEMENT	e e
WATER LINE EASEMENT	WLE
EXIST EASEMENTS	E
TEMP. CONSTRUCTION EASEMENT	[Pattern]
STORM DRAINAGE EASEMENT	[Pattern]
UTILITY EASEMENT	[Pattern]
SIDEWALK/UTILITY EASEMENT	[Pattern]
WATER LINE EASEMENT	[Pattern]
FEE SIMPLE OUTSIDE EXIST R/W	[Pattern]
FEE SIMPLE INSIDE EXIST R/W	[Pattern]

PREPARED BY:  
 CITY OF CHARLOTTE  
 ENGINEERING & PROPERTY MANAGEMENT  
 600 EAST FOURTH STREET  
 CHARLOTTE, NC 28202  
 704-336-2291

STATE OF NORTH CAROLINA  
 COUNTY OF MECKLENBURG

I, REVIEW OFFICER OF MECKLENBURG COUNTY, CERTIFY THAT THE MAP OR PLAT TO WHICH THIS CERTIFICATION IS AFFIXED MEETS ALL STATUTORY REQUIREMENTS FOR RECORDING.

REVIEW OFFICER \_\_\_\_\_ DATE \_\_\_\_\_

<p>CHARLOTTE ENGINEERING &amp; PROPERTY MANAGEMENT</p>		
REVISIONS 01-15-13-correct owners name	<p>OAKDALE ROAD WIDENING PROJECT</p>	JOB NO. 512-07-010 FILE NO. 035-031-20 SHEET 1 OF 2
SCALE 1"=40' DRAWN BY LG DATE	PROPERTY ACQUISITION OWNERS: ROBERT CAROL YARBROUGH AND WIFE SARA DUNN YARBROUGH CHARLOTTE, MECKLENBURG CO., NC	CHECKED BY DHS SURVEY SUPVR. <i>DHS</i>
K:\AUTOCAD\EN_SU-LD4\OAKDALEROADFTMPLATSC3D2010.DWG		

ACQUISITION BY DB 28191 PG 411-418 419-420

NC GRID, NAD 83/2011 VRS

I, DAVID H. SNIDER, CERTIFY THAT THIS PLAT WAS PREPARED UNDER MY SUPERVISION AND THAT THE PLAT WAS PREPARED FOR THE PURPOSE OF ACQUISITION AND EASEMENTS ONLY, AND IS NOT INTENDED TO BE A BOUNDARY SURVEY OF PROPERTY SHOWN.

*David H. Snider* 1/16/13  
 DAVID H. SNIDER, NC P.L.S. L-2942 DATE

STATE OF NORTH CAROLINA  
 COUNTY OF MECKLENBURG

I, \_\_\_\_\_ REVIEW OFFICER OF MECKLENBURG COUNTY, CERTIFY THAT THE MAP OR PLAT TO WHICH THIS CERTIFICATION IS AFFIXED MEETS ALL STATUTORY REQUIREMENTS FOR RECORDING.

REVIEW OFFICER \_\_\_\_\_ DATE \_\_\_\_\_

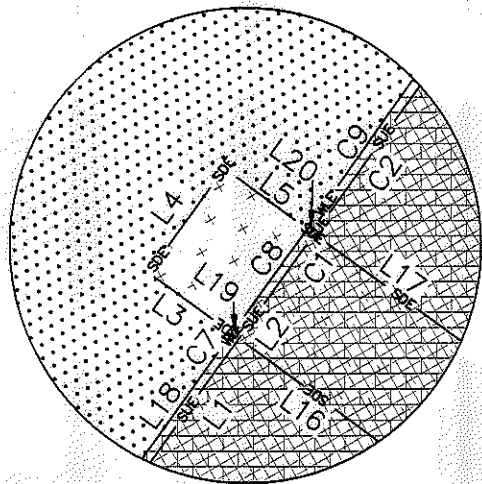
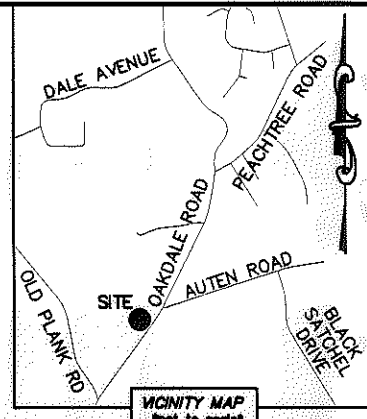
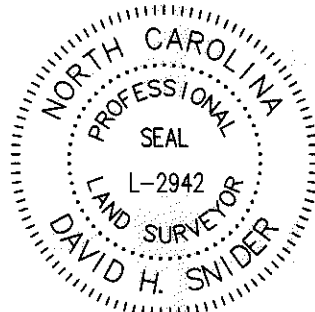

DETAIL A:  
 (NOT TO SCALE)

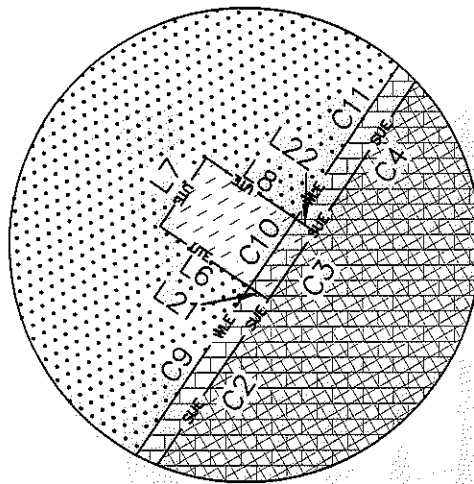

DETAIL B:  
 (NOT TO SCALE)

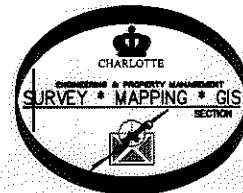

CURVE TABLE		
CURVE	RADIUS & ARC	CHORD
C1	R=2464.00 L=8.49'	N 36°00'33" E 8.49'
C2	R=2464.00 L=69.60'	N 35°06'05" E 69.59'
C3	R=2464.00 L=4.00'	N 34°14'45" E 4.00'
C4	R=2464.00 L=64.43'	N 33°27'01" E 64.42'
C5	R=2476.50 L=8.49'	N 36°00'35" E 8.49'
C6	R=2476.00 L=138.05'	N 34°18'52" E 138.03'
C7	R=2654.67 L=6.59'	N 36°10'41" E 6.59'
C8	R=2654.67 L=15.00'	N 35°56'42" E 15.00'
C9	R=2654.67 L=69.56'	N 35°01'57" E 69.56'
C10	R=2654.67 L=4.00'	N 34°14'19" E 4.00'
C11	R=2654.67 L=64.46'	N 33°30'00" E 64.46'

LINE TABLE		
LINE	LENGTH	BEARING
L1	34.02'	N 36°06'29" E
L2	6.51'	N 36°06'29" E
L3	12.00'	N 53°54'55" W
L4	15.00'	N 36°05'05" E
L5	11.97'	S 53°54'55" E
L6	5.26'	N 55°45'15" W
L7	4.00'	N 34°14'45" E
L8	5.26'	S 55°45'15" E
L9	42.14'	N 36°52'02" E
L10	26.43'	N 89°29'06" E
L11	84.87'	N 34°14'45" E
L12	11.05'	N 54°42'29" W
L13	44.62'	N 33°00'33" E
L14	33.94'	N 36°06'29" E
L15	6.51'	N 36°06'29" E
L16	12.50'	N 53°54'55" W
L17	12.50'	S 53°54'55" E
L18	27.44'	N 36°06'29" E
L19	0.99'	N 53°54'55" W
L20	1.02'	S 53°54'55" E
L21	1.10'	N 55°45'15" W
L22	1.10'	S 55°45'15" E

LEGEND

- REBAR OR IRON PIN FOUND
- #5 REBAR SET OR PK NAIL
- COMPUTED POINT
- PROPERTY LINES
- EXISTING RIGHT-OF-WAY
- EXISTING R/W BY MAINTENANCE
- NEW RIGHT-OF-WAY
- STORM DRAINAGE EASEMENT
- UTILITY EASEMENT
- SIDEWALK/UTILITY EASEMENT
- TEMP. CONSTRUCTION EASEMENT
- WATER LINE EASEMENT
- EXIST EASEMENTS
- TEMP. CONSTRUCTION EASEMENT
- STORM DRAINAGE EASEMENT
- UTILITY EASEMENT
- SIDEWALK/UTILITY EASEMENT
- WATER LINE EASEMENT
- FEE SIMPLE OUTSIDE EXIST R/W
- FEE SIMPLE INSIDE EXIST R/W

PREPARED BY:  
 CITY OF CHARLOTTE  
 ENGINEERING & PROPERTY MANAGEMENT  
 600 EAST FOURTH STREET  
 CHARLOTTE, NC 28202  
 704-336-2291

CHARLOTTE ENGINEERING & PROPERTY MANAGEMENT		
REVISIONS	OAKDALE ROAD WIDENING PROJECT	JOB NO. 512-07-010
01-15-13-correct owners name.		FILE NO. 035-031-20
	PROPERTY ACQUISITION OWNERS: ROBERT CAROL YARBROUGH AND WIFE SARA DUNN YARBROUGH CHARLOTTE, MECKLENBURG CO., NC	SHEET 2
DRAWN BY LG		OF 2
DATE	CHECKED BY DHS SURVEY SUPVR. <i>DHS</i>	
K:\AUTOCAD\EN_SU-LD4\OAKDALEROADFTMPLATSC3D2010.DWG		

ACQUISITION BY DB 28191 PG 411-418 419-423