

**VICINITY**  
N.T.S.

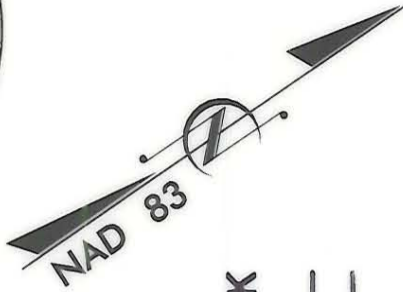

**ACQUISITION BY CITY**  
**RECORDED IN DEED BOOK**  
**DB 16912/796**  
**DATE 3/17/04**

LINE	DIRECTION	DISTANCE
L1	N 31° 41' 55" E	100.56 FT.
L2	S 57° 56' 40" E	12.00 FT.
L3	S 57° 56' 40" E	24.43 FT.
L4	S 57° 56' 40" E	66.37 FT.
L5	N 57° 49' 20" W	61.47 FT.
L6	N 57° 49' 20" W	55.27 FT.
L7	N 49° 42' 47" W	28.43 FT.
L8	N 40° 17' 13" E	24.43 FT.

DONALD J. ELIZER  
 7403 OLD STATESVILLE RD.  
 DB 9988 PG 077  
 TAX \*03721316

(57A)  
 MICHAEL W. WARD  
 HENDERSON CR.  
 DB 10314 PG 011  
 TAX \*03721315

DONALD RAY WRIGHT  
 7425 OLD STATESVILLE RD.  
 DB 8964 PG 369  
 TAX \*03721319

TEMPORARY CONSTRUCTION EASEMENT

PERMANENT UTILITY EASEMENT

I, MARK FUNKHOUSER, CERTIFY THAT THIS PLAT WAS PREPARED UNDER MY SUPERVISION AND THAT THE PLAT WAS PREPARED FOR THE PURPOSE OF ACQUISITION AND EASEMENTS ONLY, AND IS NOT INTENDED TO BE A BOUNDARY SURVEY OF ANY KIND SHOWN

*Mark Funkhouser 6-19-01*

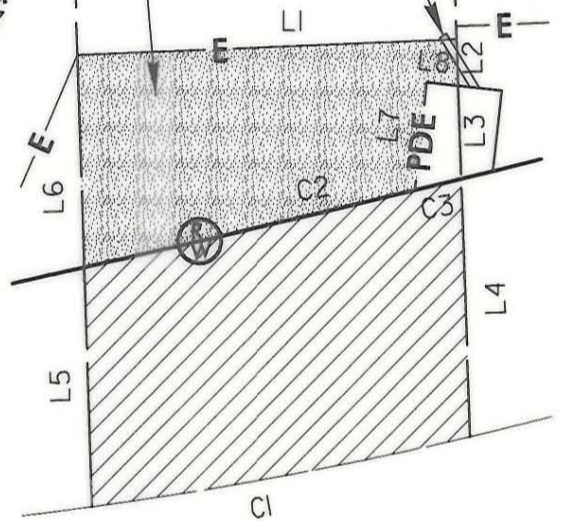

**OLD STATESVILLE ROAD**

CURVE	RADIUS	LENGTH	CHORD	BEARING
C1	1103.98 FT.	101.89 FT.	101.85 FT.	S 23° 50' 12" W
C2	4724.65 FT.	89.94 FT.	89.94 FT.	N 21° 11' 31" E
C3	4724.65 FT.	12.61 FT.	12.61 FT.	N 20° 34' 09" E

AREA FROM DEED OR TAX OFFICE	AREA ACQUIRED	RECORD AREA LESS AREA ACQUIRED	TEMPORARY CONSTRUCTION AREA	PERMANENT DRAINAGE EASEMENT	PERMANENT UTILITY EASEMENT
38,071 SQ. FT. 0.874 ACRES	6,499 SQ. FT. 0.149 ACRES	31,572 SQ. FT. 0.725 ACRES	4,351 SQ. FT. 0.100 ACRES	270 SQ. FT. 0.006 ACRES	14 SQ. FT.



**LEGEND**

- EXISTING IRON PIN
- SET IRON PIN
- NEW PROPERTY LINE
- AREA ACQUIRED
- TEMPORARY CONSTRUCTION EASEMENT

**PBSJ** Plans Prepared By  
 200 EAST WOODLAWN ROAD, SUITE 310  
 CHARLOTTE, NORTH CAROLINA 28217

<b>REVISIONS</b> 6/4/01 6/19/01	<b>OLD STATESVILLE ROAD WIDENING PROJECT</b>  <b>PROPERTY ACQUISITION</b> <b>MICHAEL W. WARD</b>  CHARLOTTE, MECKLENBURG CO., NC	JOB NO. 512-99-015  FILE NO. PLAT 57A  SHEET <b>1</b>  OF <b>1</b>
DRAIN BY: CTC/CRT CHECKED BY: MED  SURVEY SUPVR.	DATE: 5/7/01      SCALE: 1"=50'	