

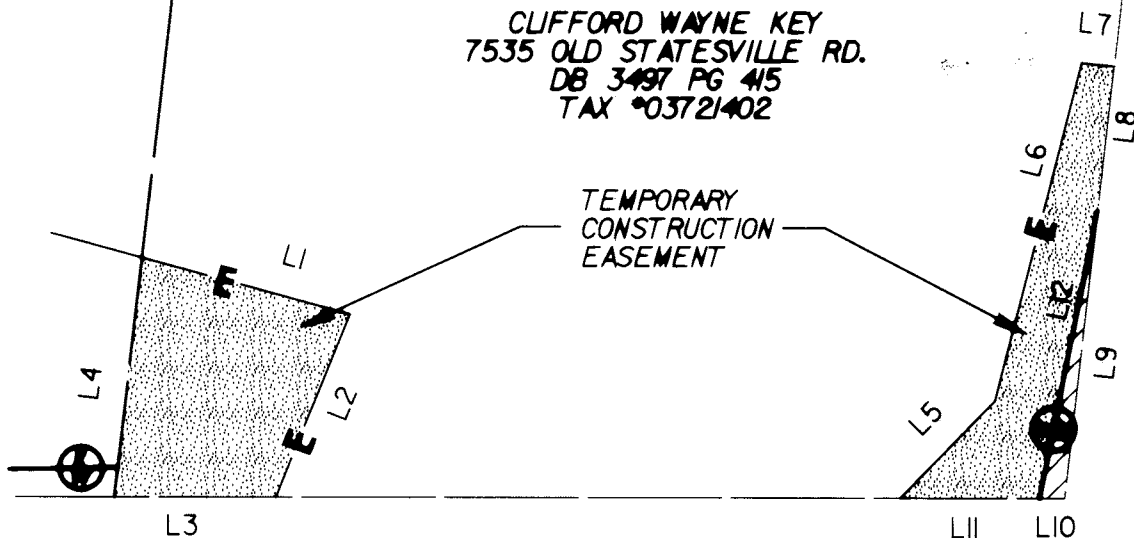

60

CLIFFORD WAYNE KEY
7535 OLD STATESVILLE RD.
DB 3497 PG 415
TAX *03721402



OLD STATESVILLE ROAD

LINE	DIRECTION	DISTANCE
L1	N 23° 40' 53" E	45.17 FT.
L2	S 59° 46' 17" E	41.30 FT.
L3	S 8° 22' 12" W	33.95 FT.
L4	N 75° 08' 20" W	50.92 FT.
L5	N 37° 34' 45" W	28.17 FT.
L6	N 67° 21' 39" W	73.57 FT.
L7	N 13° 50' 42" E	6.90 FT.
L8	S 75° 08' 19" E	34.71 FT.
L9	S 75° 08' 19" E	61.17 FT.
L10	S 8° 22' 12" W	5.15 FT.
L11	S 8° 22' 12" W	29.34 FT.
L12	N 70° 24' 09" W	61.96 FT.

I, MARK FUNKHOUSER, CERTIFY THAT THIS PLAT WAS PREPARED UNDER MY SUPERVISION AND THAT THE PLAT WAS PREPARED FOR THE PURPOSE OF ACQUISITION AND EASEMENTS ONLY, AND IS NOT INTENDED TO BE A BOUNDARY SURVEY OF PROPERTY SHOWN

Mark Funkhouser 3-30-01



LEGEND

- EXISTING IRON PIN
- SET IRON PIN
- NEW PROPERTY LINE
- AREA ACQUIRED
- TEMPORARY CONSTRUCTION EASEMENT

FBSJ Plans Prepared By
200 EAST WOODLAWN ROAD, SUITE 200
CHARLOTTE, NORTH CAROLINA 28207

		JOB NO. 512-00-016
OLD STATESVILLE ROAD WIDENING PROJECT		FILE NO. PLAT 00
PROPERTY ACQUISITION CLIFFORD WAYNE KEY		SHEET 2
CHARLOTTE, MECKLENBURG CO., NC		OF 2
REVISIONS	DATE: 3/30/01	SCALE: 1"=40'
DESIGNED BY: GWS/GW		
DRAWN BY: MB		
SURVEY SUPERVISOR:		