

VICINITY MAP (NOT TO SCALE)

I, TONY B. SANDERS, CERTIFY THAT THIS PLAT WAS PREPARED UNDER MY SUPERVISION AND THAT THE PLAT WAS PREPARED FOR THE PURPOSE OF THE ACQUISITION AND EASEMENTS ONLY, AND IS NOT INTENDED TO BE A BOUNDARY SURVEY OF PROPERTY SHOWN.

*Tony B. Sanders* 12.14.01  
 TONY B. SANDERS, NC P.L.S. L-3222, DATE

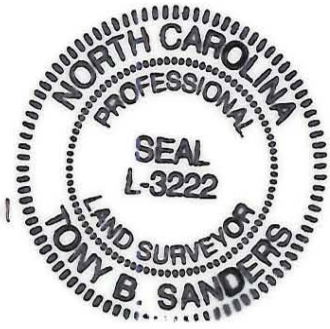

INSET A

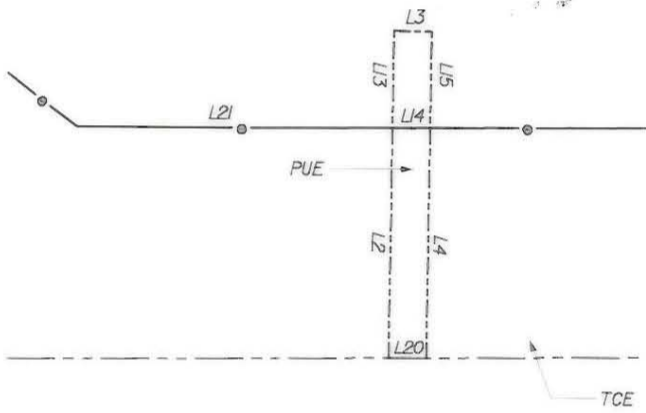

INSET B

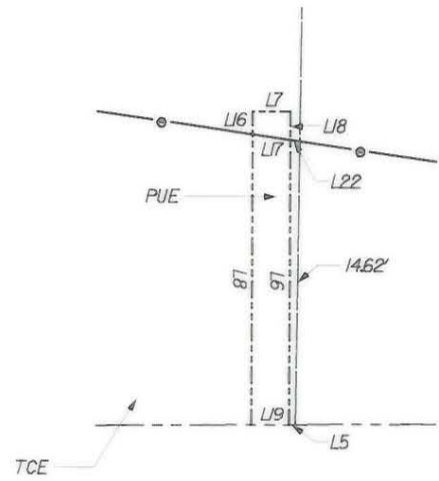

LINE TABLE		
LINE	LENGTH	BEARING
L2	11.86'	N 72° 56' 05" E
L3	2.00'	N 17° 03' 55" W
L4	11.85'	N 72° 56' 05" E
L5	0.36'	N 18° 08' 57" W
L6	14.69'	N 72° 14' 4" E
L7	2.00'	N 17° 45' 19" W
L8	14.99'	N 72° 14' 4" E
L13	5.01'	N 72° 56' 05" E
L14	2.00'	N 17° 58' 11" W
L15	4.98'	N 72° 56' 05" E
L16	1.19'	N 72° 14' 4" E
L17	2.02'	N 9° 43' 39" W
L18	1.47'	N 72° 14' 4" E
L19	2.00'	N 18° 08' 57" W
L20	2.00'	N 18° 08' 57" W
L22	0.52'	N 9° 43' 39" W

ACQUISITION BY CITY  
 RECORDED IN DEED BOOK  
**13695-398**  
 DATE **6-13-02**

GRAPHIC SCALE



LEGEND	
○ EIP	EXISTING IRON PIN
⊙ R/M	R/W MONUMENT
—	PROPERTY LINE
- - -	EXISTING R/W
— · — ·	NEW R/W
— — — —	EXISTING DUKE POWER EASEMENT
- - - - -	PERMANENT UTILITY EASEMENT (PUE)
— E — E —	PERMANENT DRAINAGE EASEMENT (PDB)
— · — · — ·	TEMPORARY CONSTRUCTION EASEMENT (TCE)
▨	BUILDING TO BE REMOVED

PREPARED BY:  
**CTE ENGINEERS**  
 CONSER TOWNSEND ENVIRONMENTAL ENGINEERS, INC.  
 13325 SOUTH POINT BOULEVARD, SUITE 400  
 CHARLOTTE, NC 28273  
 704-583-0902

CHECKED BY:  
 SURVEY AND MAPPING CONTROL, INC.  
 1000 PARK CEDAR DRIVE, SUITE 162  
 CHARLOTTE, NC 28260  
 704-542-9095

<b>CHARLOTTE</b> ENGINEERING AND PROPERTY MANAGEMENT		
512-99-014 JOB NO.	FILE NO.	<b>BROOKSHIRE BOULEVARD (NC16)</b> <b>PROPERTY ACQUISITION</b>
AS BUILT	DATE	
SCALE 1" = 10'		<b>PARCEL 30</b> <b>W. H. JR. &amp; WF. DOROTHY KEISTLER</b>
TBS SURVEYED BY	MKA PREPARED BY	
TBS APPROVED BY		12/14/01 DATE
SHEET 2		OF 2