

I, DAVID H. SNIDER, CERTIFY THAT THIS PLAT WAS PREPARED UNDER MY SUPERVISION AND THAT THE PLAT WAS PREPARED FOR THE PURPOSE OF EASEMENTS ONLY, AND IS NOT INTENDED TO BE A BOUNDARY SURVEY OF PROPERTY SHOWN.

David H. Snider 8/1/11
 DAVID H. SNIDER, NC P.L.S. L-2942 DATE

STATE OF NORTH CAROLINA
 COUNTY OF MECKLENBURG

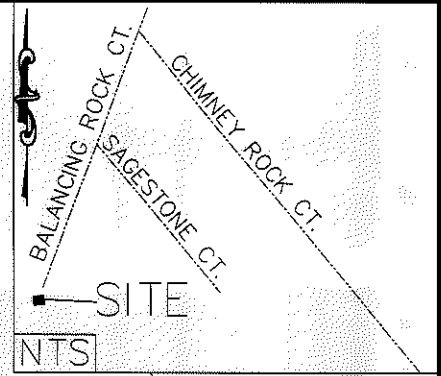
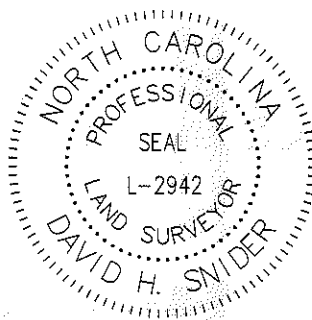

_____, REVIEW OFFICER OF MECKLENBURG COUNTY, CERTIFY THAT THE MAP OR PLAT TO WHICH THIS CERTIFICATION IS AFFIXED MEETS ALL STATUTORY REQUIREMENTS FOR RECORDING.

REVIEW OFFICER _____ DATE _____

1) BEARINGS AND DISTANCES SHOWN IN PARENTHESES ARE BASED ON RECORDED MAP INFORMATION.

- 2) TOTAL AREA 6,917 SQ. FT.
- 3) TEMP CONSTRUCTION EASEMENT 24 SQ. FT.
- 4) AREA REMAINING 6,917 SQ. FT.

047-074-44
 MILTON J RICARTE AND
 MONICA P RICARTE
 DB 25691 PG 86
 7317 BALANCING ROCK CT

(22)
 047-074-43
 ABIZAR RANGWALA AND LUBAINA RANGWALA
 DB 22516 /PG 632
 7313 BALANCING ROCK CT

EIP
 COMBINED GRID
 FACTOR=0.99984104
 N 567851.55
 E 1467951.69

(N43°19'05"W 73.51') TOTAL
 (N44°06'38"W 63.60')

S68°54'52"E
 11.33'

-L-
 40+89.47
 LT 164.30'

111.11'

(N50°22'44"E 115.88') TOTAL
 (N51°10'36"E 115.88')

(36)
 047-074-42
 DONALD BLACKWELL AND DIANA B MORGAN
 DB 10081 /PG 185
 7309 BALANCING ROCK CT

CURVE TABLE				
CURVE	LENGTH	RADIUS	CHORD	BEARING
C1	41.84	170.00	41.74'	S32°34'13"E

(15)
 047-472-82
 WATERHAVEN HOMEOWNERS ASSO INC.
 DB 21833 /PG 903
 STONEY CREEK LN

(TIE)
 (N43°56'33"W 76.60')

LEGEND

- IRON PIN FOUND
- CALCULATED POINT
- LINES SURVEYED
- LINES NOT SURVEYED
- TEMP. CONSTRUCTION EASEMENT

PREPARED BY:
 CITY OF CHARLOTTE
 ENGINEERING DEPARTMENT
 600 EAST FOURTH STREET
 CHARLOTTE, NC 28202
 704-336-2291

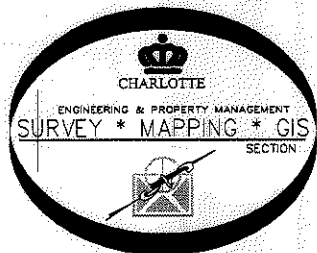

		CHARLOTTE ENGINEERING DEPARTMENT	
REVISIONS	CITY BOULEVARD EXTENSION	JOB NO. 512-08-012	
8/1/11 PROJECT #		208012	
SCALE 0 1' = 20"	PROPERTY OF ABIZAR RANGWALA AND LUBAINA RANGWALA CHARLOTTE, MECKLENBURG CO., NC	SHEET 1	
DRAWN BY P.S.		OF 1	
DATE	CHECKED BY DS	SURVEY SUPVR. <i>DK</i>	
K:\AutoCad\En_su-LD4\208012 City Blvd. Extension\Plats\#22_047-074-43			

DB 26847-544