

I, DAVID H. SNIDER, CERTIFY THAT THIS PLAT WAS PREPARED UNDER MY SUPERVISION AND THAT THE PLAT WAS PREPARED FOR THE PURPOSE OF EASEMENTS ONLY, AND IS NOT INTENDED TO BE A BOUNDARY SURVEY OF PROPERTY SHOWN.

David H. Snider 5/4/12
 DAVID H. SNIDER, NC P.L.S. L-2942 DATE

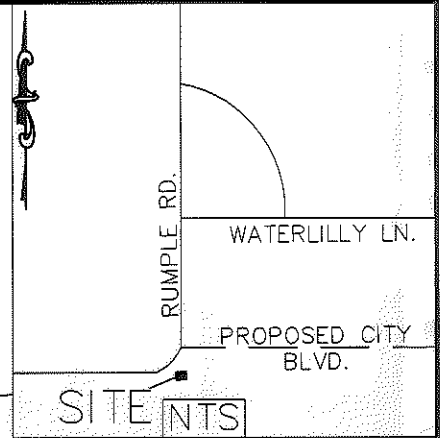
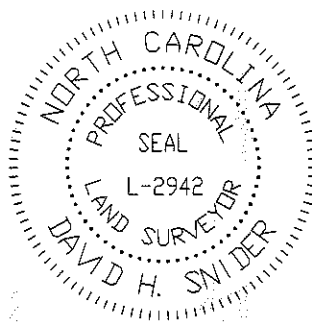

STATE OF NORTH CAROLINA
 COUNTY OF MECKLENBURG

I, _____, REVIEW OFFICER OF MECKLENBURG COUNTY, CERTIFY THAT THE MAP OR PLAT TO WHICH THIS CERTIFICATION IS AFFIXED MEETS ALL STATUTORY REQUIREMENTS FOR RECORDING.

REVIEW OFFICER _____ DATE _____

LEGEND

- IRON PIN FOUND ○
- CALCULATED POINT ●
- LINES SURVEYED ———
- LINES NOT SURVEYED - - - - -
- TEMP. CONSTRUCTION EASEMENT [stippled box]



33
 047-032-22
 MICHAEL LANDING, LLC
 DB 12310 PG 208
 6412 QUARTERBRIDGE LN.

37
 047-281-25
 LEO JR KELLY AND ALICE W KELLY
 DB 10543 PG 953
 2302 BARN BOARD LN.

60
 047-281-24
 LEE LYLES AND NANCY LYLES
 DB 8362 PG 269
 2304 BARN BOARD LN.

22+2.18
 233.61' RT

S04°48'57"W 33.21'
 R=45.00
 L=34.01'

NO3°54'07"E 121.604 TOTAL
 (N04°11'58"E 121.61') TOTAL
 S85°58'23"E 25.00'
 S03°54'07"W 39.95'
 S54°40'40"E 156.55' TOTAL
 (S54°24'26"E 156.30') TOTAL
 S89°01'06"E 133.24'
 (S88°48'18"E 133.15')

COMBINED GRID
 FACTOR=0.99984104
 N: 567202.64
 E: 1466010.80

047-281-23
 FREDERICK LEE FEASTER
 DB 7178 PG 328
 2310 BARN BOARD LN.

- 1) BEARINGS AND DISTANCES SHOWN IN PARENTHESES ARE BASED ON RECORDED MAP INFORMATION.
- 2) TOTAL AREA 10,259 SQ. FT.
- 3) TEMP CONSTRUCTION EASEMENT 1,189 SQ. FT.
- 4) AREA REMAINING 10,259 SQ. FT.

PREPARED BY:
 CITY OF CHARLOTTE
 ENGINEERING DEPARTMENT
 600 EAST FOURTH STREET
 CHARLOTTE, NC 28202
 704-336-2291

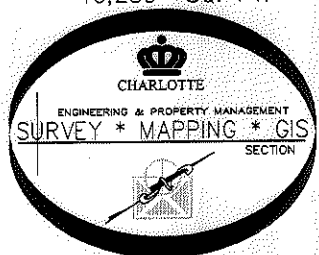

		CHARLOTTE ENGINEERING DEPARTMENT	
REVISIONS		CITY BOULEVARD EXTENSION	JOB NO. 512-08-012
SCALE 1"=30"			208012
DRAWN BY P.S.		PROPERTY OF LEE LYLES AND NANCY LYLES CHARLOTTE, MECKLENBURG CO., NC	SHEET 1
DATE			OF 1
CHECKED BY DS		SURVEY SUPVR. <i>DS</i>	
K:\AutoCad\En_su-LD4\208012 City Blvd. Extension\Plats\#60 047-281-24			

ACQUISITION BY DB 27766 PG 394