

I, DAVID H. SNIDER, CERTIFY THAT THIS PLAT WAS PREPARED UNDER MY SUPERVISION AND THAT THE PLAT WAS PREPARED FOR THE PURPOSE OF EASEMENTS ONLY, AND IS NOT INTENDED TO BE A BOUNDARY SURVEY OF PROPERTY SHOWN.

David H. Snider 8/1/11
 DAVID H. SNIDER, NC P.L.S. L-2942 DATE

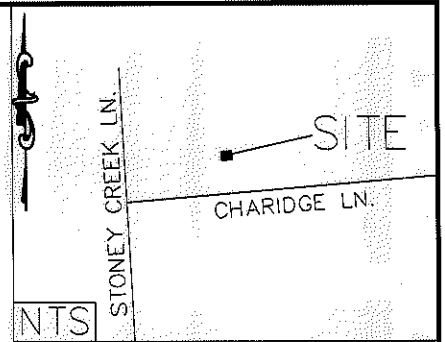
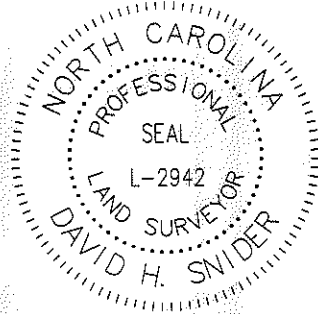

(16)

047-471-07
 SIKH HERITAGE SOCIETY OF GREATER CHARLOTTE
 DB 25605 PG 76
 RUMPLE RD

-L-
 29+78.87
 RT 63.08'

N80°40'29"E 60.10'
 (N80°42'04"E 60.00') TOTAL

(TIE)
 N80°33'47"E
 59.99'

STATE OF NORTH CAROLINA
 COUNTY OF MECKLENBURG

_____, REVIEW OFFICER OF MECKLENBURG COUNTY, CERTIFY THAT THE MAP OR PLAT TO WHICH THIS CERTIFICATION IS AFFIXED MEETS ALL STATUTORY REQUIREMENTS FOR RECORDING.

REVIEW OFFICER _____ DATE _____

(46)

047-283-40
 CARLOS A HERNANDEZ
 AND EDITH Y OCHOA
 DB 23101 PG 173
 1338 CHARIDGE LN

LEGEND

- IRON PIN FOUND ○
- CALCULATED POINT ●
- LINES SURVEYED ———
- LINES NOT SURVEYED - - -
- TEMP. CONSTRUCTION EASEMENT

(45)

047-283-39
 HEATHER WILSON AND
 O.W. DESMOND WILSON
 DB 21378 PG 399
 1342 CHARIDGE LN

(44)

047-283-38
 EDWIN F GUTERREZ PEREZ
 AND ERIKA ZARATE PAVON
 DB 22649 PG 340
 1346 CHARIDGE LN

118.91'

S09°28'32"E 134.10' TOTAL
 (S09°17'56"E 134.00' TOTAL)

114.27'
 S09°25'53"E 133.97' TOTAL
 (S09°17'56"E 134.00' TOTAL)

N80°33'17"E
 (N80°42'04"E 60.00')

CHARIDGE LN.
 50' RIGHT-OF-WAY

COMBINED GRID
 FACTOR=0.99984104
 N 567396.7326
 E 1466916.9675

- 1) BEARINGS AND DISTANCES SHOWN IN PARENTHESES ARE BASED ON RECORDED MAP INFORMATION.
- 2) TOTAL AREA 8,049 SQ. FT.
- 3) TEMP CONSTRUCTION EASEMENT 1,048 SQ. FT.
- 4) AREA REMAINING 8,049 SQ. FT.

PREPARED BY:
 CITY OF CHARLOTTE
 ENGINEERING DEPARTMENT
 600 EAST FOURTH STREET
 CHARLOTTE, NC 28202
 704-336-2291

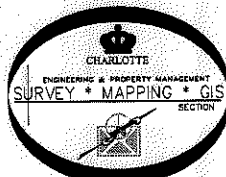

		CHARLOTTE ENGINEERING DEPARTMENT
REVISIONS	CITY BOULEVARD EXTENSION	JOB NO. 512-08-012
8/1/11-PROJECT #		208012
SCALE 0 1" = 20'	PROPERTY OF HEATHER WILSON AND O.W. DESMOND WILSON CHARLOTTE, MECKLENBURG CO., NC	SHEET 1
DRAWN BY P.S.		OF 1
DATE	CHECKED BY DS	SURVEY SUPVR. <i>SW</i>
K:\AutoCad\En_su-LD4\208012 City Blvd. Extension\Plots\#45 047-283-39		

DB 26847 - 569