

SEE SHEET 2 OF 2 FOR DETAIL "A"

JSK INVESTMENTS  
 TAX CODE: 049-081-03  
 DB 6098 PG 180 (TRACT 1)  
 6736 N. TRYON ST.

S81°20'19"E 732.60'  
 (S81°20'21"E 733.49' total)  
 724.15'

ROCKY NAD83  
 N 565174.49  
 E 1475764.55  
 GRID FACTOR = 0.9998410

21

UNITED STATES POSTAL SERVICE  
 TAX CODE: 049-081-09  
 DB 5271 PG 212  
 6700 N. TRYON ST.

State of North Carolina  
 County of Mecklenburg

I, \_\_\_\_\_, Review Officer of Mecklenburg County, certify that the map or plat to which this certification is affixed meets all statutory requirements for recording.

Review Officer \_\_\_\_\_ Date \_\_\_\_\_

I, DAVID H. SNIDER, CERTIFY THAT THIS PLAT WAS PREPARED UNDER MY SUPERVISION AND THAT THE PLAT WAS PREPARED FOR THE PURPOSE OF ACQUISITION AND EASEMENTS ONLY, AND IS NOT INTENDED TO BE A BOUNDARY SURVEY OF PROPERTY SHOWN.

*David H. Snider* 12/2/08  
 DAVID H. SNIDER, NC P.L.S. L-2942 DATE

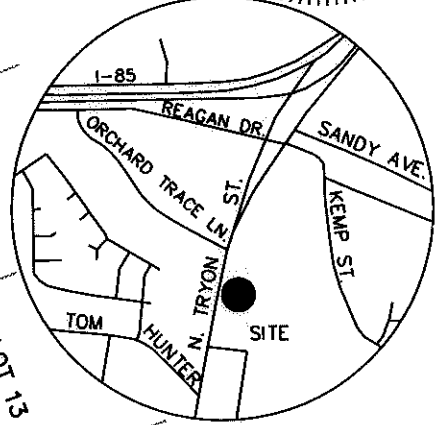
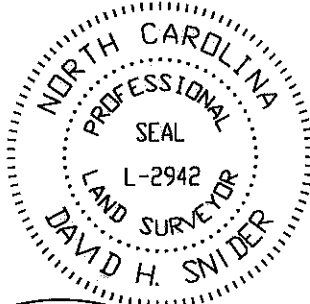

VICINITY MAP  
 not to scale

NC GRID, NAD 1983  
 N 561220.15  
 E 1473058.08

6624 NORTH TRYON, LLC  
 TAX CODE: 049-081-04  
 DB 10505 PG 377  
 6624 N. TRYON ST.

N81°20'22"W 978.33'  
 (N81°20'21"W 977.72' total)

19

GLORYLAND BAPTIST CHURCH  
 TAX CODE: 049-081-06  
 DB 3465 PG 505

SINKOE BROTHERS  
 TAX CODE: 049-081-05  
 DB 7075 PG 725  
 6600 N. TRYON ST.

ACQUISITION BY DB 25521 PG 214

ACQUISITION BY DB 25521 PG 220

ACQUISITION BY DB 25521 PG 226

PREPARED BY:  
 CITY OF CHARLOTTE  
 ENGINEERING DEPARTMENT  
 600 EAST FOURTH STREET  
 CHARLOTTE, NC 28202  
 704-336-2291

- 5. REVISED (11-05-08)
- 4. ADDED UE (10/01-03)
- 3. ADDED SHEET 2 (7/24/03)
- 2. ADDED GUY EASEMENTS (7/24/03)
- 1. CHANGED R/W (07-24-03)

		CHARLOTTE ENGINEERING & PROPERTY MANAGEMENT	
REVISIONS		<b>NC. 49 / US 29 INTERCHANGE RECONSTRUCTION</b>	
SCALE 0 1"=100' 1"			
DRAWN BY G.F.		OWNER: U.S. POSTAL SERVICE TAX CODE: 049-081-09 CHARLOTTE, MECKLENBURG CO., NC	
DATE			
CHECKED BY		SURVEY SUPVR. <i>DS</i>	
		JOB NO. 512-99-009	
		FILE NO. LAN #299009 PLAT-21.dwg	
		SHEET 1	
		OF 2	

Sta. "Y-2"  
105+15.71  
67.94' RT.

NORTH TRYON ST. (U.S. HWY. 29 & N.C. 49)  
(PUBLIC R/W VARIES)



I, DAVID H. SNIDER, CERTIFY THAT THIS PLAT WAS PREPARED UNDER MY SUPERVISION AND THAT THE PLAT WAS PREPARED FOR THE PURPOSE OF ACQUISITION AND EASEMENTS ONLY, AND IS NOT INTENDED TO BE A BOUNDARY SURVEY OF PROPERTY SHOWN.  
*David H. Snider* 12/02/08  
DAVID H. SNIDER, NC P.L.S. L-2942 DATE

CURVE TABLE				
CURVE	LENGTH	RADIUS	CHORD	CHORD BEARING
(C1)	(153.98)	2827.79	(153.96)	(S11°59'36"W)
C1				S12°34'38"W
C2	154.27	2805.79	154.25	S12°53'14"W
C3	137.18	2805.79	137.16	S12°42'45"W
C4	17.10	2805.79	17.10	S14°17'16"W

DETAIL "A"  
N.T.S.

TEMPORARY CONSTRUCTION EASEMENT



- LEGEND**
- NCGS CONTROL MONUMENT
  - IRON PIN FOUND
  - IRON PIN SET #6 rebar & cap
  - CONCRETE MONUMENT FOUND
  - TEMP. CONSTRUCTION EASEMENT
  - FEE SIMPLE OUTSIDE EXISTING R/W
  - STORM DRAINAGE EASEMENT
  - LINES SURVEYED
  - LINES NOT SURVEYED

- NOTE:**
- BEARINGS AND DISTANCES SHOWN IN PARENTHESES ARE BASED ON RECORDED MAP INFORMATION.
  - TOTAL AREA 342,570 SQ.FT.
  - TEMP. CONSTRUCTION EASEMENT 5,435 SQ.FT.
  - FEE SIMPLE OUTSIDE EXISTING R/W 1,233 SQ.FT.
  - STORM DRAINAGE EASEMENT 1,295 SQ.FT.
  - AREA REMAINING 341,377 SQ.FT.

OLD PROPERTY LINE

NEW PROPERTY LINE

TEMPORARY CONSTRUCTION EASEMENT

STORM DRAINAGE EASEMENT

Sta. "Y-2"  
103+58.23  
57.18' RT.

S79°34'01"E  
7.60'

ACQUISITION BY DB 25521 PG 214

ACQUISITION BY DB 25521 PG 220

ACQUISITION BY DB 25521 PG 226

- 5. REVISED (11-05-08)
- 4. ADDED UE (10/01-03)
- 3. ADDED SHEET 2 (7/24/03)
- 2. ADDED GUY EASEMENTS (7/24/03)
- 1. CHANGED R/W (07-24-03)

		CHARLOTTE ENGINEERING DEPARTMENT	
REVISIONS		NC. 49 / US 29 INTERCHANGE RECONSTRUCTION	
		OWNER: U.S. POSTAL SERVICE TAX CODE: 049-081-09 CHARLOTTE, MECKLENBURG CO., NC	
SCALE N.T.S.		JOB NO. 512-99-009	
DRAWN BY G.F.		FILE NO. LAN #299009 PLAT-21.dwg	
DATE		SHEET 2	
CHECKED BY		OF 2	
SURVEY SUPV. <i>DN</i>			

CITY OF CHARLOTTE  
ENGINEERING DEPARTMENT  
600 EAST FOURTH STREET  
CHARLOTTE, NC 28202  
704-336-2291