

JSK INVESTMENTS
 TAX CODE: 049-081-03
 DB 6098 PG 180 (TRACT 1)
 6736 N. TRYON ST.

SEE DETAIL "A"
 SHEET 2 OF 2

UNITED STATES POSTAL SERVICE
 TAX CODE:
 049-081-09
 DB 5271 PG 212
 6700 N. TRYON ST.

ROCKY NAD83
 N 565174.49
 E 1475764.55
 GRID FACTOR = 0.9998410

6624 NORTH TRYON, LLC
 TAX CODE: 049-081-04
 DB 10505 PG 377
 6624 N. TRYON ST.

SINKOE BROTHERS
 TAX CODE: 049-081-05
 DB 7075 PG 725
 6600 N. TRYON ST.

- NOTE:
- 1) BEARINGS AND DISTANCES SHOWN IN PARENTHESES ARE BASED ON RECORDED MAP INFORMATION.
 - 2) TOTAL AREA 342,570 SQ.FT.
 - 3) TEMP. CONSTRUCTION EASEMENT 10,290 SQ.FT.
 - 4) FEE SIMPLE OUTSIDE EXISTING R/W 4,292 SQ.FT.
 - 5) STORM DRAINAGE EASEMENT 1,009 SQ.FT.
 - 6) UTILITY EASEMENT 154 SQ.FT.
 - 7) AREA REMAINING 338,278 SQ.FT.

State of North Carolina
 County of Mecklenburg

I, _____, Review Officer of Mecklenburg County, certify that the map or plat to which this certification is affixed meets all statutory requirements for recording.

Review Officer _____ Date _____

GLORYLAND BAPTIST CHURCH
 TAX CODE: 049-081-06
 DB 3465 PG 505

CURVE TABLE				
CURVE	LENGTH	RADIUS	CHORD	CHORD DISTANCE
C1	(153.98')	(2827.79')	S12°34'38"W	(153.96')
C2	88.86'	2796.29'	S12°14'55"W	88.86'
C4	10.19'	2796.29'	S13°03'17"W	10.19'
C5	36.76'	2796.29'	S12°34'25"W	36.76'
C6	2.00'	2796.29'	S12°10'36"W	2.00'
C7	39.91'	2796.29'	S11°44'50"W	39.91'

I, DAVID H. SNIDER, CERTIFY THAT THIS PLAT WAS PREPARED UNDER MY SUPERVISION AND THAT THE PLAT WAS PREPARED FOR THE PURPOSE OF ACQUISITION AND EASEMENTS ONLY, AND IS NOT INTENDED TO BE A BOUNDARY SURVEY OF PROPERTY SHOWN.

David H. Snider 10/07/03
 DAVID H. SNIDER, NC P.L.S. L-2942 DATE

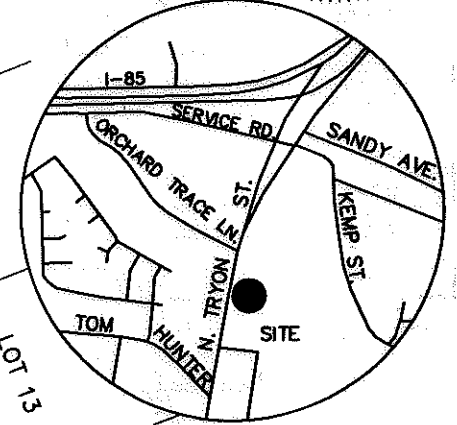
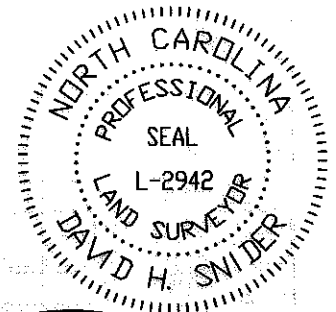

VICINITY MAP
 not to scale

PREPARED BY:
 CITY OF CHARLOTTE
 ENGINEERING DEPARTMENT
 600 EAST FOURTH STREET
 CHARLOTTE, NC 28202
 704-336-2291

CHARLOTTE
 ENGINEERING & PROPERTY MANAGEMENT

REVISIONS <small> 1. ADDED SHEET 2/24/03 2. ADDED GUY EASEMENTS 7/24/03 3. CHANGED R/W 07-24-05 </small>	NC. 49 / US 29 INTERCHANGE RECONSTRUCTION	JOB NO. 512-99-009 FILE NO. LAN 2299009 PLAT-21A.dwg
SCALE 1"=100' 	OWNER: U.S. POSTAL SERVICE TAX PARCEL 049-081-09 CHARLOTTE, MECKLENBURG CO., NC	SHEET 1 OF 2
DRAWN BY G.C.F. DATE 06-09-03	CHECKED BY _____ SURVEY SUPVR. <i>DS</i>	

ACQUISITION BY DB 25521 214-219

NORTH TRYON ST.
(U.S. HWY. 29 & N.C. 49)
(PUBLIC R/W VARIES)

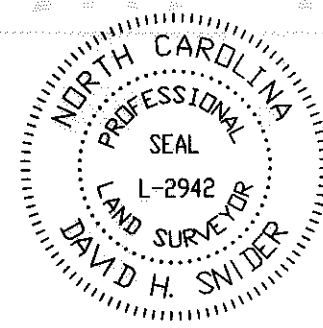

I, DAVID H. SNIDER, CERTIFY THAT THIS PLAT WAS PREPARED UNDER MY SUPERVISION AND THAT THE PLAT WAS PREPARED FOR THE PURPOSE OF ACQUISITION AND EASEMENTS ONLY, AND IS NOT INTENDED TO BE A BOUNDARY SURVEY OF PROPERTY SHOWN.

David H. Snider 10/07/03
DAVID H. SNIDER, NC P.L.S. L-2942 DATE

LINE TABLE		
LINE	LENGTH	BEARING
L1	6.17	S81°20'22"E
L2	24.42	S81°20'22"E
L3	11.65	S81°20'19"E
L4	30.50	S55°54'24"E
L5	4.00	S13°19'35"W
L6	19.31	N46°57'56"W
L7	44.03	N11°23'12"E
L8	17.72	N84°57'01"E
L9	20.09	S67°43'46"E
L10	28.23	N16°14'17"E
L11	50.01	S81°20'19"E
L12	11.43	S55°54'24"E
L13	4.00	S55°54'24"E
L14	15.07	S55°54'24"E
L15	3.36	S31°57'18"W
L16	3.21	N31°50'59"E
L17	1.00	S58°07'24"E
L18	1.00	S58°07'46"E
L19	2.00	S58°07'38"E
L20	4.00	S76°40'18"E
L21	4.00	N76°40'13"W
L22	1.00	N13°19'39"E
L23	1.00	N13°19'39"E
L24	2.00	N13°19'34"E

DETAIL "A"
N.T.S.

- LEGEND**
- ▲ NCGS CONTROL MONUMENT
 - IRON PIN FOUND
 - IRON PIN SET #6 rebar & cap
 - CONCRETE MONUMENT FOUND
 - ▨ TEMP. CONSTRUCTION EASEMENT
 - ▩ FEE SIMPLE OUTSIDE EXISTING R/W
 - ▤ STORM DRAINAGE EASEMENT
 - ▥ UTILITY EASEMENT
 - LINES SURVEYED
 - - - LINES NOT SURVEYED



CITY OF CHARLOTTE
ENGINEERING DEPARTMENT
600 EAST FOURTH STREET
CHARLOTTE, NC 28202
704-338-2291

		CHARLOTTE ENGINEERING DEPARTMENT	
REVISIONS <small> 1. ADDED UE 10/01-03 2. ADDED SHEET 2 7/24/03 3. ADDED GUY EASEMENTS 7/24/03 4. CHANGED R/W 07-24-03 </small>		NC. 49 / US 29 INTERCHANGE RECONSTRUCTION	
<small> SCALE 0' N.T.S. 0' </small>		OWNER: U.S. POSTAL SERVICE TAX PARCEL 049-081-09 CHARLOTTE, MECKLENBURG CO., NC	
<small> DRAWN BY G.C.F. DATE 06-09-03 </small>	<small> CHECKED BY SURVEY SUPVR. </small>	<small> JOB NO. 512-99-009 </small>	<small> FILE NO. LAN #289009 PLAT-21A.dwg </small>
		<small> SHEET 2 </small>	<small> OF 2 </small>