

CHARLOTTE-MECKLENBURG
BOARD OF EDUCATION
TAX CODE: 055-133-09
DB 1870 PG 471

I, DAVID H. SNIDER, CERTIFY THAT THIS PLAT WAS PREPARED UNDER MY SUPERVISION AND THAT THE PLAT WAS PREPARED FOR THE PURPOSE OF EASEMENTS ONLY, AND IS NOT INTENDED TO BE A BOUNDARY SURVEY OF PROPERTY SHOWN.

David H. Snider 4/15/11
DAVID H. SNIDER, NC P.L.S. L-2942 DATE

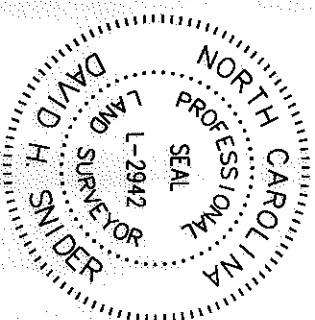

EXISTING 10' DRAINAGE & UTILITIES EASEMENT PER MB 14-563
(583°11'28"W 70.00')
584°14'19"W
(S83°11'28"W 70.00')

LINE	LENGTH	BEARING
L1	21.96	N84°12'10"E
L2	12.24	S06°14'26"E
L3	42.66	N84°12'10"E
L4	14.79	N06°02'08"W
L5	5.25	N84°12'10"E

LEGEND
CALCULATED POINT
IRON PIN FOUND
TEMP. CONSTRUCTION EASEMENT
LINES SURVEYED
LINES NOT SURVEYED



(S06°52'00"E 154.92')
S05°51'35"E

(16)

JAMES L. HOWZE
TAX CODE: 055-133-17
DB 5409 PG 592
8614 STONEHURST DRIVE

HARRY L. BENTON
TAX CODE: 055-133-18
DB 4887 PG 675
8608 STONEHURST DRIVE

(15)

(S06°52'00"E 154.85')
S05°49'09"E

MICHAEL S. BOZEMAN & JUDY U. BOZEMAN
TAX CODE: 055-133-16
DB 5459 PG 058
8620 STONEHURST DRIVE

(17)

- NOTE:**
- 1) BEARINGS AND DISTANCES SHOWN IN PARENTHESES ARE BASED ON RECORDED MAP INFORMATION.
 - 2) COMPUTED PROJECT DISTANCE *
 - 3) TOTAL AREA 10,834 SQ.FT.
 - 4) TEMP. CONSTRUCTION EASEMENT 917 SQ.FT.
 - 5) AREA REMAINING 10,834 SQ.FT.

B 7+84.78 - stonehurst-
35.82' RT.

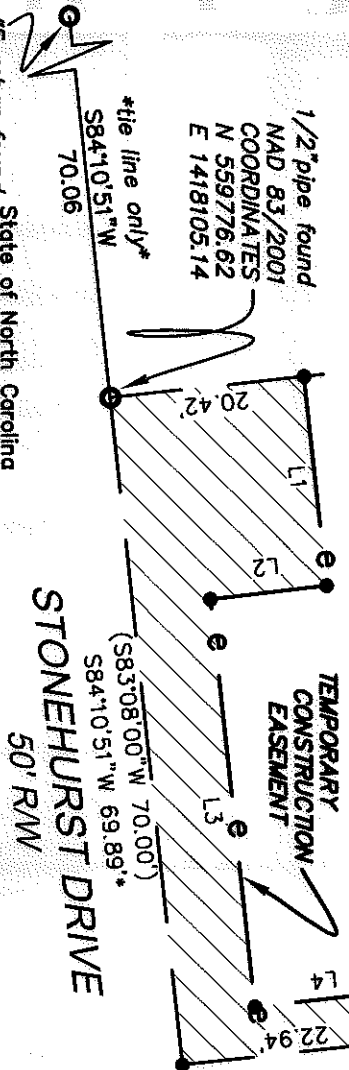

I, Review Officer of Mecklenburg County, certify that the map or plat to which this certification is affixed meets all statutory requirements for recording.

Review Officer _____ Date _____

PREPARED BY:
CITY OF CHARLOTTE
ENGINEERING DEPARTMENT
600 EAST FOURTH STREET
CHARLOTTE, NC 28209
704-336-2291

<p>CHARLOTTE ENGINEERING DEPARTMENT</p>		<p>OWNER: JAMES L. HOWZE TAX CODE: 055-133-17 CHARLOTTE, MECKLENBURG CO., NC</p>	
REVISIONS	<p>PAWTUCKETT NIP</p>	JOB NO.	512-08-052
SCALE 0 1" = 20'		FILE NO.	LW 820002
DRAWN BY G.F.		SHEET	1
DATE		OF	1
<p>CHECKED BY SURVEY SUPERVISOR</p>		<p>LAW 820002</p>	
<p>K:\AUTOCAD\en_spl-164\lwn_208052 PHASE 2\PLAT MAPS and THERE INFORMATION\Plat-16</p>			