

STANDARD TEXTILE MILLS, INC
 TAX CODE: 055-159-01
 DB 3630 PG 694
 MB 8 PG 265

171

I, DAVID H. SNIDER, CERTIFY THAT THIS PLAT WAS PREPARED UNDER MY SUPERVISION AND THAT THE PLAT WAS PREPARED FOR THE PURPOSE OF EASEMENTS ONLY, AND IS NOT INTENDED TO BE A BOUNDARY SURVEY OF PROPERTY SHOWN.
 David H. Snider 01/15/11
 DAVID H. SNIDER, NC P.L.S. L-2942 DATE

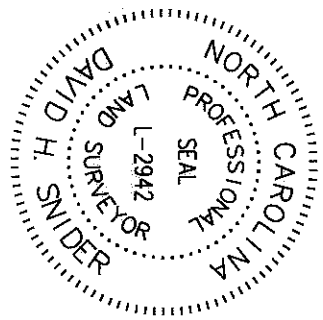

LINE	LENGTH	BEARING
L1	46.21	S65.35°42'W
L2	39.37	S48.03°27'W
L3	33.43	S29.05°44'W
L4	32.34	N29.05°44'E
L5	40.81	N48.03°27'E
L6	35.36	N61.47°50'E
L7	26.43	N01°09'39"E

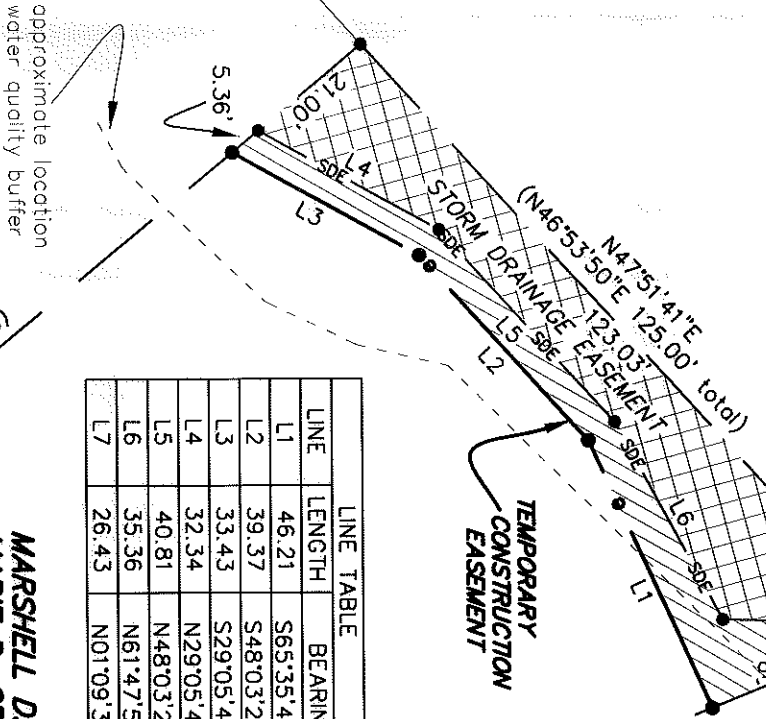

approximate location water quality buffer

approximate location water quality buffer

(S21°51'00"E 212.03'
 (S22°53'44"E 211.67'
 180.27)

JANIS GRAHAM
 TAX CODE: 055-155-35
 DB 6424 PG 019
 6728 WILD TURKEY LANE

137

1" PIPE FOUND
 NAD 83/2001
 COORDINATES
 N 558,655.25
 E 1,419,767.10

(S40°56'01"E 190.05'
 (S39°51'10"E 190.27' total)
 164.05

MARSHALL D. GRIFFIN
 MARIE D. GRIFFIN
 TAX CODE: 055-155-36
 DB 6277 PG 834
 6732 WILD TURKEY LANE

136

NC GRID
 NAD 83/2001

CHANDRA Y. BROWN
 ALDRIC E. BROWN
 TAX CODE: 055-155-37
 DB 14428 PG 858
 6734 WILD TURKEY LANE

135

State of North Carolina
 County of Mecklenburg

Review Officer of Mecklenburg County, certify that the map or plat to which this certification is affixed meets all statutory requirements for recording.

Review Officer _____ Date _____

- LEGEND
- IRON PIN FOUND
 - CALCULATED POINT
 - TEMP. CONSTRUCTION EASEMENT
 - STORM DRAINAGE EASEMENT
 - LINES SURVEYED
 - LINES NOT SURVEYED

CURVE	LENGTH	RADIUS	CHORD	CHORD BEARING
C1	(60.00)	(172.00)	59.70	S56°09'44"W

PAWTUCKETT NIP
 CHARLOTTE
 ENGINEERING DEPARTMENT

- NOTE:
- 1) BEARINGS AND DISTANCES SHOWN IN PARENTHESES ARE BASED ON RECORDED MAP INFORMATION.
 - 2) COMPUTED PROJECT DISTANCE _____*
 - 3) TOTAL AREA 17,978 SQ.FT.
 - 4) TEMP. CONSTRUCTION EASEMENT 834 SQ.FT.
 - 5) STORM DRAINAGE EASEMENT 1,597 SQ.FT.
 - 6) AREA REMAINING 17,978 SQ.FT.

PREPARED BY:
 CITY OF CHARLOTTE
 ENGINEERING DEPARTMENT
 600 EAST FOURTH STREET
 CHARLOTTE, NC 28208
 704-336-2291



REVISIONS	DATE	DESCRIPTION	CHECKED BY	DATE	SCALE	DATE
1. REVISED EASEMENTS	8-11-11				1" = 30'	
OWNER:		MARSHALL D. GRIFFIN and MARIE D. GRIFFIN				
DRAWN BY:		G.F.				
CHECKED BY:						
DATE						