

I, DAVID H. SNIDER, CERTIFY THAT THIS PLAT WAS PREPARED UNDER MY SUPERVISION AND THAT THE PLAT WAS PREPARED FOR THE PURPOSE OF EASEMENTS ONLY, AND IS NOT INTENDED TO BE A BOUNDARY SURVEY OF PROPERTY SHOWN.

*David H. Snider* 6/13/11  
 DAVID H. SNIDER, NC P.L.S. L-2942 DATE

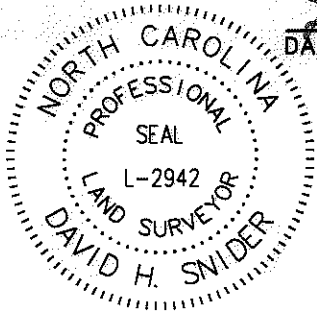

State of North Carolina  
 County of Mecklenburg

Review Officer of Mecklenburg County, certify that the map or plat to which this certification is affixed meets all statutory requirements for recording.

Review Officer \_\_\_\_\_ Date \_\_\_\_\_

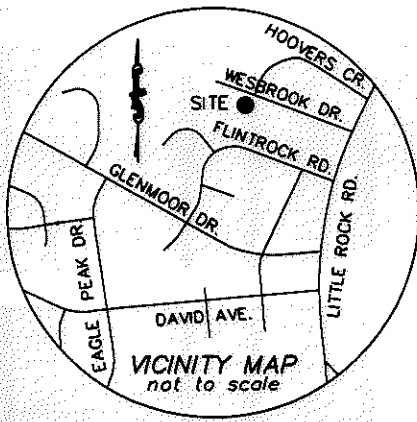

**NOTE:**

- 1) BEARINGS AND DISTANCES SHOWN IN PARENTHESES ARE BASED ON RECORDED MAP INFORMATION.
- 2) COMPUTED PROJECT DISTANCE \_\_\_\_\_\*
- 3) TOTAL AREA 28,039 SQ.FT.
- 4) TEMP. CONSTRUCTION EASEMENT 1,556 SQ.FT.
- 5) AREA REMAINING 28,039 SQ.FT.

171

STANDARD TEXTILE MILLS, INC  
 TAX CODE: 055-159-01  
 DB 3630 PG 694  
 MB 8 PG 265  
 WESBROOK DRIVE



S46°54'00"W  
 (S47°51'00"W 269.62')

98

DOUGLAS E. BOYCE and DORIS P. BOYCE  
 TAX CODE: 055-157-01  
 DB 14216 PG 439  
 6622 WESBROOK DRIVE

@ 11+74.59 - WESBROOK -  
 55.49' RT.

approximate location water quality buffer

TEMPORARY CONSTRUCTION EASEMENT

(N68°35'00"W)  
 N69°32'00"W  
 76.18'

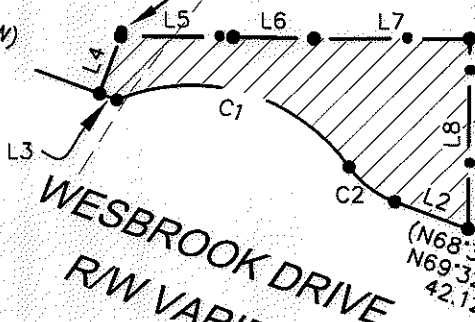

WESBROOK DRIVE  
 RW VARIES

(N68°35'00"W)  
 N69°32'00"W  
 42.12'

\*tie line\*  
 N69°32'00"W  
 120.26'

FRANK WRIGHT, JR.  
 STEPHANIE HARRIS  
 TAX CODE: 055-157-04  
 DB 26299 PG 385  
 6538 HOOVER CIRCLE

101

approximate location water quality buffer

S53°26'25"E  
 (S52°31'30"E)  
 (62.42')

(N21°25'00"E 224.17')  
 N20°28'00"E 224.13'

99

AVIS J. MEEKS  
 TAX CODE: 055-157-02  
 DB 19379 PG 440  
 6610 WESBROOK DRIVE

LINE	LENGTH	BEARING
L1	25.91	N69°32'00"W
L2	16.22	N69°32'00"W
L3	3.85	N69°32'00"W
L4	12.80	N20°28'00"E
L5	23.47	S89°27'32"E
L6	16.78	S88°50'35"E
L7	32.37	S89°48'25"E
L8	39.91	S00°40'57"W

found #3 rebar  
 NAD 83/2001  
 COORDINATES  
 N 558,966.16  
 E 1,420,162.45

CURVE	LENGTH	RADIUS	CHORD	CHORD BEARING
C1	54.50	(40.00)	50.38	N73°38'03"W
C2	12.19	20.00	12.00	S52°04'09"E

**LEGEND**

- IRON PIN FOUND
- CALCULATED POINT
- TEMP. CONSTRUCTION EASEMENT
- LINES SURVEYED
- LINES NOT SURVEYED

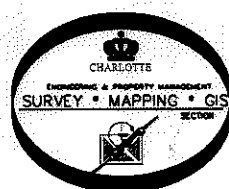

PREPARED BY:  
 CITY OF CHARLOTTE  
 ENGINEERING DEPARTMENT  
 600 EAST FOURTH STREET  
 CHARLOTTE, NC 28208  
 704-336-2291

		<b>CHARLOTTE</b> ENGINEERING DEPARTMENT	
REVISIONS		<b>PAWTUCKETT NIP</b>	
SCALE 1" = 40'			
DRAWN BY G.F.		<b>OWNER:</b> DOUGLAS E. BOYCE and DORIS P. BOYCE TAX CODE: 055-157-01 CHARLOTTE, MECKLENBURG CO., NC	
DATE			
CHECKED BY		SURVEY SUPERVISOR <i>[Signature]</i>	
K:\AUTOCAD\en_su-1d4\lan.208052 PHASE 2\PLAT MAPS and THERE INFORMATION\Plat-98			
JOB NO. 512-08-052		FILE NO.	
LAN #208052		SHEET 1	
		OF 1	

ACQUISITION BY DE 26692 388