

I, _____ REVIEW OFFICER OF MECKLENBURG COUNTY, CERTIFY THAT THE MAP OR PLAT TO WHICH THIS CERTIFICATION IS AFFIXED MEETS ALL STATUTORY REQUIREMENTS OF NORTH CAROLINA GENERAL STATUTES FOR RECORDING.

REVIEW OFFICER _____ DATE _____

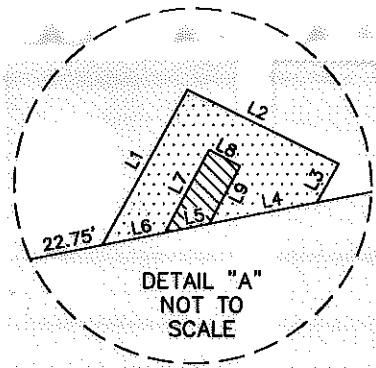

LINE	LENGTH	BEARING
L1	18.54	N28°35'27\"E
L2	21.93	S63°44'47\"E
L3	1.16	S28°35'27\"W
L4	19.32	S78°45'23\"W
L5	2.58	S78°45'23\"W
L6	6.63	S78°45'23\"W
L7	9.86	N28°03'36\"E
L8	2.00	S61°56'24\"E
L9	8.22	S28°03'36\"W

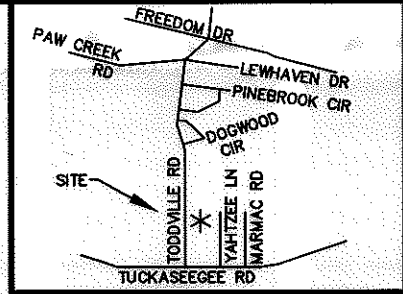
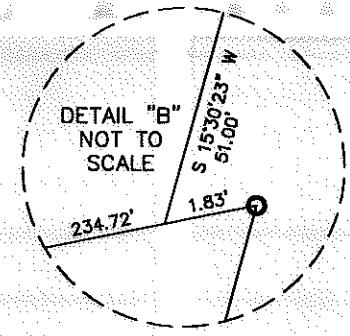

LEGEND

TCE = TEMPORARY CONSTRUCTION EASEMENT
 PUE = PERMANENT UTILITY EASEMENT

- = TCE
- = PUE
- = TCE
- = EXISTING R/W
- = PUE
- = IRON PIN FOUND

15
 TAX # 05911352
 JOSHUA A. BENFIELD
 LOT 2, MB 30, PG 181
 DB 19363, PG 50
 TODDVILLE ROAD

12
 TAX # 05911335
 RHONDA S. BENFIELD
 DB 13514, PG 61
 LOT 3, MB 30, PG 181
 2534 TODDVILLE ROAD

11
 TAX # 05911353
 RHONDA S. BENFIELD
 DB 13514, PG 61
 LOT 1, MB 30, PG 181
 TODDVILLE ROAD

TAX # 05908120
 RICHARD R. GREENE AND
 TERESA R. GREENE
 DB 15361/PG 454
 LOT 57
 MB. 6, PG 283
 2527 TODDVILLE ROAD

14
 TAX # 05908121
 RICHARD R. GREENE AND WIFE
 TERESA R. GREENE
 DB 15361/PG 508
 LOT 56
 MB 6/PG 283
 2533 TODDVILLE ROAD

13
 TAX # 05908122
 SAM SYSONGDETH
 DB 17507/PG 507
 2605 TODDVILLE ROAD

- NOTE:
- 1) BEARINGS AND DISTANCES SHOWN IN PARENTHESES ARE BASED ON RECORDED MAP OR DEED INFORMATION.
 - 2) TOTAL AREA: 15,798 SF, 0.363 AC
 - 3) AREA IN TCE: 198 SF, 0.005 AC
 - 4) AREA IN PUE: 18 SF
 - 5) FEE AREA REMAINING: 15,798 SF, 0.363 AC

I, CHARLES J. DUNBAR, CERTIFY THAT THIS PLAT WAS PREPARED UNDER MY SUPERVISION AND THAT THIS PLAT WAS PREPARED FOR THE PURPOSE OF EASEMENTS ONLY, AND IS NOT INTENDED TO BE A BOUNDARY SURVEY OF PROPERTY SHOWN.

CHARLES J. DUNBAR NC PLS L-4159

DATE 6/22/10

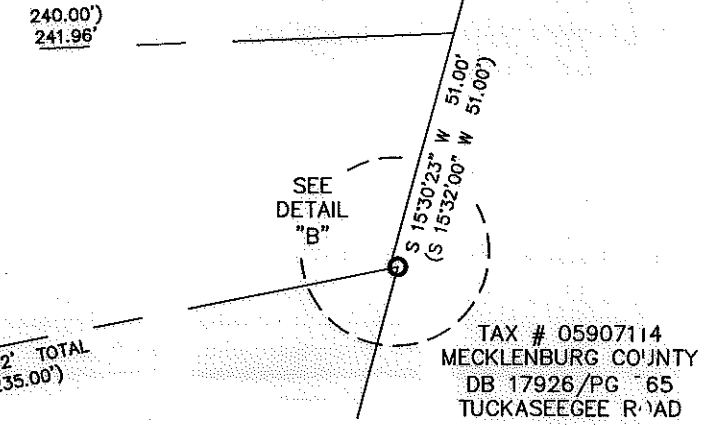
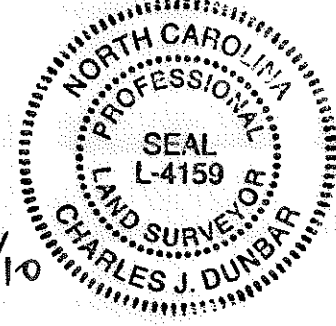

NC GRID NAD 83/2007

PBSJ Plans Prepared By:
 5200 77 CENTER DRIVE, SUITE 500
 CHARLOTTE, NORTH CAROLINA 28217
 (704) 522-7275 NCCOA: F-0326

		JOB NO. 512-08-024	
REVISIONS		FILE NO. PARCEL 14	
TODDVILLE ROAD SIDEWALK		SHEET 1	
PROPERTY ACQUISITION		OWNER: RICHARD R. GREENE AND WIFE TERESA R. GREENE CHARLOTTE, MECKLENBURG CO., NC	
DRAWN BY: TTB		OF 1	
DATE: 06/22/2010		CHECKED BY: CJD SURVEY SUPVR.: CJD	