

I, \_\_\_\_\_, REVIEW OFFICER OF MECKLENBURG COUNTY, CERTIFY THAT THE MAP OR PLAT TO WHICH THIS CERTIFICATION IS AFFIXED MEETS ALL STATUTORY REQUIREMENTS OF NORTH CAROLINA GENERAL STATUTES FOR RECORDING.

REVIEW OFFICER \_\_\_\_\_ DATE \_\_\_\_\_

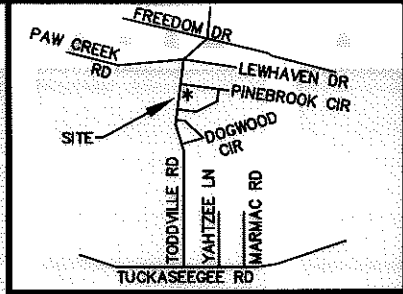

VICINITY MAP NOT TO SCALE

TAX # 05910302  
KINGSWAY REALTY CO., INC.  
PART OF LOT 1, BLOCK A  
MB 7, PG 493  
DB 13306, PG 558  
1929 TODDVILLE ROAD

TAX # 05910303  
RICHARD C. SHORT, SR.  
AND WIFE FLORENCE B. SHORT  
DB 8372, PG 317

TAX # 05913122  
HONGKHAM CHANTHAPHAENG  
DB 18774, PG 785  
2000 TODDVILLE ROAD

TAX # 05909201  
WILLIAM J. ALMOND AND WIFE  
EVELYN FRICK ALMOND  
LOT 2, MB 7, PG 7  
DB 1654, PG 578  
2001 TODDVILLE ROAD

TAX # 05909224  
THOMAS GILBERT MCKNIGHT AND  
STEPHANIE ANN MCKNIGHT  
DB 20486, PG 180

TAX # 05909202  
ROBERT H. STONE, JR  
LOT 3, MB 7, PG 7  
DB 1702, PG 183  
2029 TODDVILLE ROAD

TODDVILLE ROAD  
PUBLIC R/W  
R/W VARIES

PINEBROOK DRIVE  
(40' PUBLIC R/W)

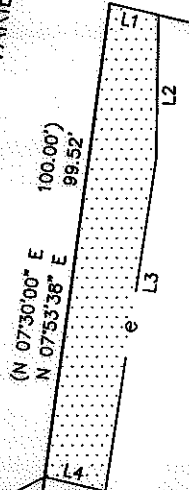

LEGEND

- TCE = TEMPORARY CONSTRUCTION EASEMENT
- = TCE
- = TCE
- = EXISTING R/W
- = IRON PIN FOUND

LINE TABLE		
LINE	LENGTH	BEARING
L1	10.36	S76°28'15"E
L2	29.55	S00°56'04"W
L3	70.45	S08°42'54"W
L4	12.94	N76°28'07"W

100004583v01\_PARCEL 46

- NOTE:
- 1) BEARINGS AND DISTANCES SHOWN IN PARENTHESES ARE BASED ON RECORDED MAP OR DEED INFORMATION.
  - 2) TOTAL AREA: 20,007 SF, 0.459 AC
  - 3) AREA IN TCE: 1,295 SF, 0.030 AC
  - 4) FEE AREA REMAINING: 20,007 SF, 0.459 AC



I, CHARLES J. DUNBAR, CERTIFY THAT THIS PLAT WAS PREPARED UNDER MY SUPERVISION AND THAT THIS PLAT WAS PREPARED FOR THE PURPOSE OF EASEMENTS ONLY, AND IS NOT INTENDED TO BE A BOUNDARY SURVEY OF PROPERTY SHOWN.

*[Signature]*  
CHARLES J. DUNBAR NC PLS L-4159 DATE 4/22/10

		JOB NO. 512-08-024
TODDVILLE ROAD SIDEWALK		FILE NO. PARCEL 46
REVISIONS	PROPERTY ACQUISITION	SHEET 1
SCALE 1" = 40'	OWNER: WILLIAM J. ALMOND AND WIFE EVELYN FRICK ALMOND CHARLOTTE, MECKLENBURG CO., NC	OF 1
DRAWN BY: TTB	DATE: 06-22-2010	CHECKED BY: CJD
DATE: 06-22-2010		SURVEY SUPVR.: CJD

**PBSJ** Plans Prepared By:  
5200 77 CENTER DRIVE, SUITE 500  
CHARLOTTE, NORTH CAROLINA 28217  
(704) 522-7275 NCCOA: F-0326

NC GRID NAD 83/2007