

I, KENNETH M. GREEN, CERTIFY THAT THIS PLAT WAS PREPARED UNDER MY SUPERVISION AND THAT THE PLAT WAS PREPARED FOR THE PURPOSE OF EASEMENT ACQUISITION ONLY, AND IS NOT INTENDED TO BE A BOUNDARY SURVEY OF THE PROPERTY SHOWN HEREON.

Kenneth M. Green
 KENNETH M. GREEN, PLS. 4-8-11



ADDITIONAL NOTE:

THE DEED DESCRIPTION DOES NOT ACCURATELY DESCRIBE THE CURRENT PROPERTY. PROPERTY LINES ARE AMBIGUOUS AND BASED ON THE BEST AVAILABLE PUBLIC INFORMATION, INCLUDING THE ADJOINING DEEDS AND GIS.

LEGEND:

- - IRON FOUND
- ⊙ - IRON SET (#5 REBAR)
- △ - MONUMENT FOUND
- (R) --- - PROPERTY LINE (R)
- (A) --- - ADJOINER
- (e) --- - TEMPORARY CONSTRUCTION EASEMENT (TCE)
- (UTE) --- - UTILITY EASEMENT (UTE)
- [Dotted Pattern] - TCE
- [Hatched Pattern] - UTE

PREPARED BY: FIRM #P-0197

R. Joe Harris & Associates, P.L.L.C.

Engineering & Land Surveying

1698 W. HWY 160, SUITE 130, FORT MILL, SC, 29708
 Phone: (803) 802-1799

NOTES:
 BEARINGS AND DISTANCES SHOWN IN PARENTHESIS ARE BASED ON RECORDED MAP INFORMATION.
 THIS PROPERTY MAY BE SUBJECT TO OTHER EASEMENTS EITHER RECORDED OR IMPLIED.
 BOUNDARY INFORMATION TAKEN FROM COMPILED MECKLENBURG CO. PUBLIC RECORD INFORMATION.

I, _____ REVIEW OFFICER OF MECKLENBURG COUNTY CERTIFY THAT THE MAP OR PLAT TO WHICH THIS CERTIFICATION IS AFFIXED MEETS ALL STATUTORY REQUIREMENTS FOR RECORDING.

REVIEW OFFICER _____ DATE _____

NCGS MONUMENT 'RESERVOIR'
 NC GRID COORDS (NAD '83)
 N=561,874.06
 E=1,434,680.70

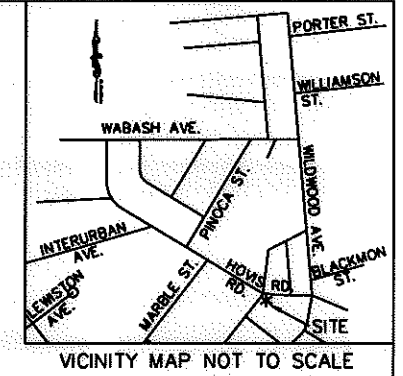
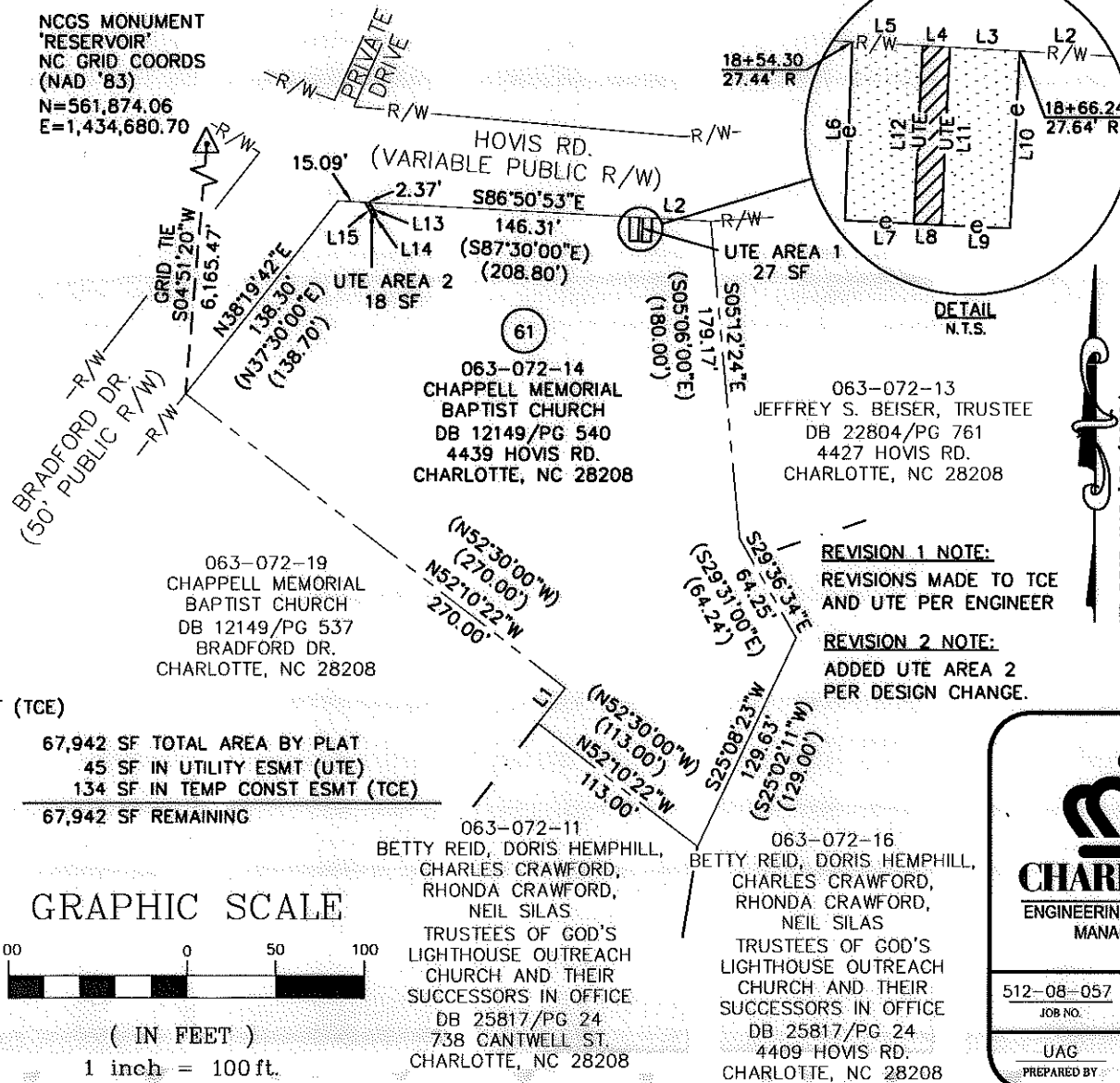

LINE TABLE		
LINE	LENGTH	BEARING
L1	25.00	N37°49'38"E
L1 (DEED)	(25.27)	(N44°38'30"E)
L2	32.83	S86°50'53"E
L3	5.10	S86°50'53"E
L4	2.00	S86°50'53"E
L5	5.10	S86°50'53"E
L6	13.38	N02°18'53"E
L7	5.00	N87°16'00"W
L8	2.00	N87°16'00"W
L9	5.00	N87°16'00"W
L10	13.29	S03°09'07"W
L11	13.33	N02°44'00"E
L12	13.34	S02°44'00"W
L13	8.37	S29°28'48"E
L14	2.00	S60°31'12"W
L15	9.65	N29°28'48"W

67,942 SF TOTAL AREA BY PLAT
 45 SF IN UTILITY ESMT (UTE)
 134 SF IN TEMP CONST ESMT (TCE)
 67,942 SF REMAINING

GRAPHIC SCALE

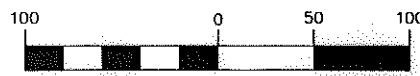

(IN FEET)

1 inch = 100 ft.

REVISION 1 NOTE:

REVISIONS MADE TO TCE AND UTE PER ENGINEER

REVISION 2 NOTE:

ADDED UTE AREA 2 PER DESIGN CHANGE.

REV 2: 04-07-11
 REV 1: 09-21-10

RJH PROJ. #1465

CHARLOTTE
ENGINEERING & PROPERTY MANAGEMENT

**EASEMENT ACQUISITION
 THOMASBORO/HOSKINS
 PHASE 4 NEIGHBORHOOD
 IMPROVEMENTS**

PROPERTY OF
**CHAPPELL MEMORIAL
 BAPTIST CHURCH**
 4439 HOVIS RD.
 CHARLOTTE, NC 28208
 PID #063-072-14

512-08-057 JOB NO.	1" = 100' SCALE
UAG PREPARED BY	06/23/10 DATE
PARCEL 61 REV 2.DWG CAD FILE NAME	
SHEET 1	OF 1