

SPECIAL NOTE:
ALL TREES AND SHRUBS IN THE EASEMENT
ARE SUBJECT TO REMOVAL EXCEPT AS NOTED.

065-03-605
ANDREW OVERTON BENNETT
AND TRACIE MILLER MAHONEY
MB 332 PG 210
DB 06490 PG 458
3809 TUCKASEEGEE RD

065-03-604
DECORUM INVESTMENTS, LLC
MB 332 PG 210
DB 23798 PG 791
3801 TUCKASEEGEE RD



Note: Property corners shown circled were located by actual field survey. Bearings are based on N.C. State Grid North. This map was prepared for the purpose of right-of-way and/or easement acquisition only, and is not intended to be a boundary survey of the property shown. This map was prepared under my supervision.

John C. Gibson
JOHN C. GIBSON
L-4818

065-03-606
ONEX10 LLC
MB 332 PG 210
DB 21839 PG 978
3819 TUCKASEEGEE RD

LOCALIZED GRID COORDINATES
N: 549587.05
E: 1435966.43
PROJECT BASELINE TIE
STA: 11+44.00
213.20 LT.

065-03-603
DAVID ELMER GRIFFITH
AND LOLLIE K. GRIFFITH
MB 332 PG 210
DB 01739 PG 585
1218 HAZEL ST

065-03-602
VICTORIA T MCGARRY
MB 332 PG 210
DB 20927 PG 386
1224 HAZEL ST

TCE/SUE TABLE		
LINE	BEARING	DISTANCE
L1	S 75°28'43" E	12.98'
L2	S 75°28'43" E	10.03'
L3	S 13°43'50" W	100.01'
L4	N 75°28'43" W	10.57'
L5	N 14°02'19" E	100.00'
L6	N 75°28'43" W	12.50'
L7	N 14°02'19" E	65.49'
L8	N 14°34'19" W	12.53'
L9	N 14°02'19" E	18.00'
L10	N 59°02'19" E	7.80'

AREA TOTALS	
Total Parcel Area	20,000 SF
Total Proposed Esmt. Area	2,439 SF
Temporary Construction Easement Total	1,409 SF
Sidewalk Utility Easement Total	1,030 SF
Total Parcel Area Remaining	20,000 SF

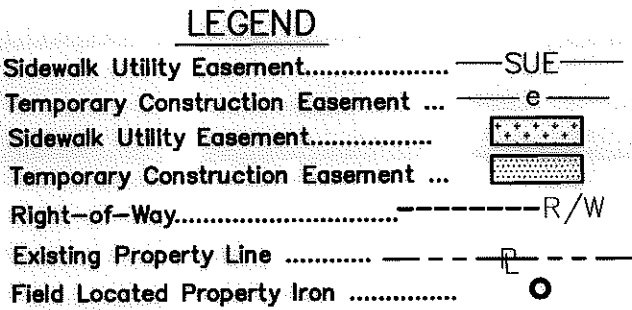

NOTE:
1) BEARINGS AND DISTANCES SHOWN IN PARENTHESES ARE BASED ON RECORDED MAP INFORMATION.



Dewberry & Davis, Inc.
LICENSE # F-0679

6135 LAKEVIEW ROAD
SUITE 400
CHARLOTTE, NC 28269-2609
PHONE: (704) 509-9918
FAX: (704) 509-9937

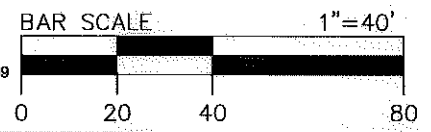

THE LOCALIZED COORDINATE SYSTEM DEVELOPED FOR THIS PROJECT IS BASED ON THE NAD 83/2001 STATE PLANE COORDINATES FOR THE NCGS MONUMENT "RESERVIOR" WITH A NORTHING OF 561,874.06, EASTING OF 1,434,680.70. THE AVERAGE COMBINED FACTOR USED ON THIS PROJECT (GROUND TO GRID) IS 0.99983851. ALL LINEAR DISTANCES ARE LOCALIZED HORIZONTAL DISTANCES.

STATE OF NORTH CAROLINA
COUNTY OF MECKLENBURG

I, _____, Review Officer of Mecklenburg County, certify that the map or plat to which this certification is attached meets all statutory requirements for recording.

Review Officer _____ Date _____

CHARLOTTE
ENGINEERING & PROPERTY
MANAGEMENT

Project Name
Enderly Park
NIP
512-07-034

Property Owner
**DAVID ELMER GRIFFITH
AND LOLLIE K. GRIFFITH**
Address
1218 HAZEL ST

512-07-034 PROJECT NO.	1"=40' SCALE	_____
RM PREPARED BY	06/2011 DATE	1 OF 1 SHEET