

**LEGEND**  
 IRON PIN FOUND  
 #6 REBAR SET  
 AREA ACQUIRED  
 TEMP. CONSTRUCTION  
 EASEMENT



(10)  
 069-093-40  
 MECKLENBURG COUNTY  
 DB 12019 / PG 304  
 ESTELLE ST  
 (N 75°59' E 323.6')  
 (N 74°27'31" E 323.60)

(10)  
 069-093-40  
 MECKLENBURG COUNTY  
 DB 12019 / PG 304  
 ESTELLE ST  
 (S 07°36' E 255.00)  
 (S 09°10'45" E 255.00)

**NOTE:**  
 1) BEARINGS AND DISTANCES SHOWN IN PARENTHESSES ARE BASED ON RECORDED MAP INFORMATION.  
 2) TOTAL AREA 71904 SQ.FT.  
 3) TEMPORARY CONSTRUCTION 1278 SQ.FT.  
 4) AREA ACQUIRED 1974 SQ.FT.  
 5) AREA REMAINING 69930 SQ.FT.

**RECORDED IN DEED BOOK**  
**17159-825 DEED**  
**DATE 05-06-04**

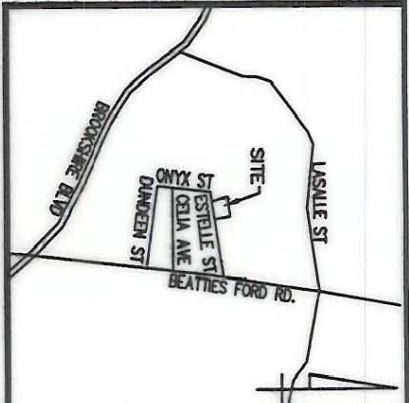

**LINE TABLE**

LINE	BEARING	LENGTH
L1	S80°49'09"W	43.98
L2	N82°53'09"E	42.95
L3	S87°59'05"E	47.37
L4	S73°35'49"E	106.13
L5	N19°25'32"W	24.76
L6	S83°48'48"E	70.04
L7	N19°25'32"W	32.73
L8	S80°49'09"W	130.90

**CURVE TABLE**

CURVE	LENGTH	RADIUS	CHORD BEARING	CHORD LENGTH
C1	23.80	221.39	S86°53'33"E	23.78
C2	46.80	280.00	S88°36'05"E	46.74

(11)  
 069-093-37  
 069-093-38  
 SINKOE BROTHERS  
 DB 03562 / PG 521  
 ESTELLE ST

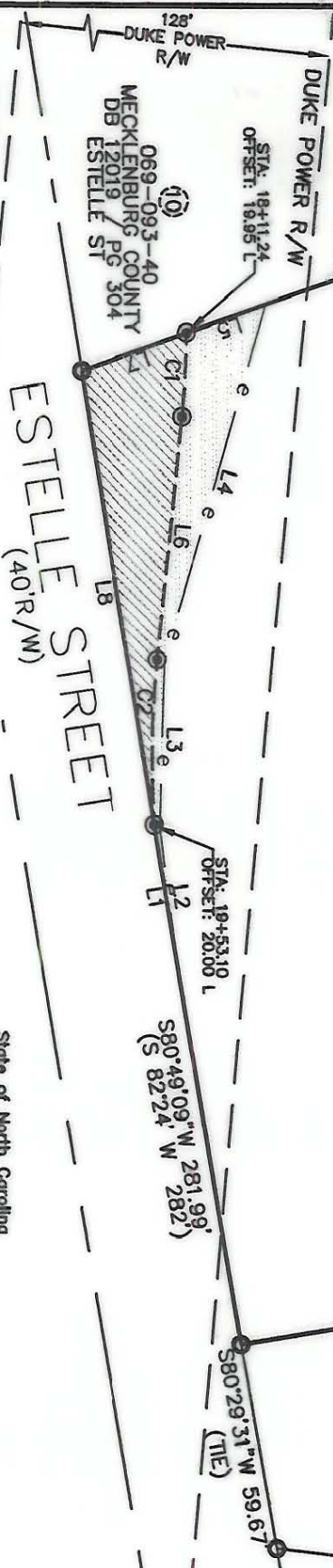

PREPARED BY:  
 CITY OF CHARLOTTE  
 ENGINEERING & PROPERTY  
 MANAGEMENT  
 600 EAST FOURTH STREET  
 CHARLOTTE, NC 28202  
 704-336-2291

ESTELLE STREET  
 (40'R/W)

State of North Carolina  
 County of Mecklenburg  
 I, \_\_\_\_\_, Review Officer of Mecklenburg County, certify that the map or plat to which this certification is affixed meets all statutory requirements for recording.

Review Officer \_\_\_\_\_ Date \_\_\_\_\_

I, DAVID H. SNIDER, CERTIFY THAT THIS PLAT WAS PREPARED UNDER MY SUPERVISION AND THAT THE PLAT WAS PREPARED FOR THE PURPOSE OF ACQUISITION AND EASEMENTS ONLY, AND IS NOT INTENDED TO BE A BOUNDARY SURVEY OF PROPERTY SHOWN.  
 David H. Snider 12/02/03  
 DAVID H. SNIDER, NC P.L.S. L-2942 DATE \_\_\_\_\_

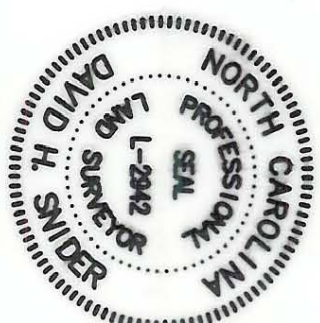

		CHARLOTTE ENGINEERING & PROPERTY MANAGEMENT	
WASHINGTON HEIGHTS SMALL AREA PLAN		JOB NO. 512-03-039	FILE NO. 06909637
PROPERTY ACQUISITION OWNER: SINKOE BROTHERS CHARLOTTE, MECKLENBURG CO., NC		SHEET 1 OF 1	DATE 11/05/03
DRAWN BY: SAA	CHECKED BY:	SURVEY SUPERVISOR:	1

069-093-37