

I, DAVID H. SNIDER, CERTIFY THAT THIS PLAT WAS PREPARED UNDER MY SUPERVISION AND THAT THE PLAT WAS PREPARED FOR THE PURPOSE OF EASEMENTS ONLY, AND IS NOT INTENDED TO BE A BOUNDARY SURVEY OF PROPERTY SHOWN.

David H. Snider 3/23/2010
 DAVID H. SNIDER, NC P.L.S. L-2942 DATE

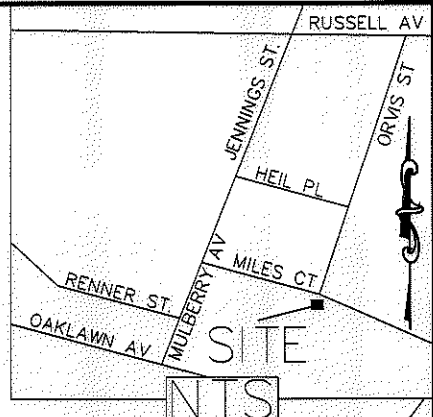

LEGEND

- NCGS MONUMENTS
- IRON PIN FOUND
- CALCULATED POINT
- LINES SURVEYED
- LINES NOT SURVEYED
- TEMP. CONSTRUCTION EASEMENT
- SIDEWALK UTILITY EASEMENT
- UTILITY EASEMENT

- 1) BEARINGS AND DISTANCES SHOWN IN PARENTHESES ARE BASED ON RECORDED MAP INFORMATION.
- 2) TOTAL AREA 9,549 SQ. FT.
- 3) TEMP CONSTRUCTION EASEMENT 925 SQ. FT.
- 4) SIDEWALK UTILITY EASEMENT 23 SQ. FT.
- 5) UTILITY EASEMENT 11 SQ. FT.
- 6) AREA REMAINING 9,549 SQ. FT.

LINE TABLE		
LINE	LENGTH	BEARING
L1	2.51	S37°45'06"W
L2	1.72	S59°57'33"E
L3	28.30	S52°24'12"E
L4	4.33	S61°36'21"E
L5	13.27	N30°21'43"E

③
 075-083-25
 ROBERT L. HOLLOWAY
 AND MAGGIE D.
 HOLLOWAY
 DB 2197-035
 1719 MILES CT

④
 075-083-24
 RAYMOND WORSLEY,
 MARIE W. MATTHEWS
 AND WILLIAM WORSLEY
 DB 9965-791
 1713 MILES CT

⑤
 075-083-23
 THERESA JONES AND
 CHARLES JONES
 DB 21250-01
 1709 MILES CT

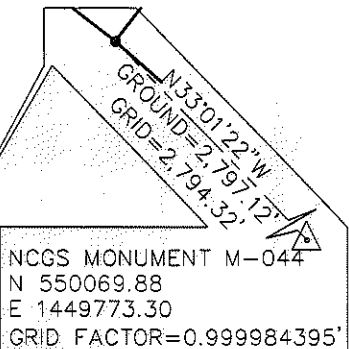

STATE OF NORTH CAROLINA
 COUNTY OF MECKLENBURG

I, _____ REVIEW OFFICER OF MECKLENBURG COUNTY, CERTIFY THAT THE MAP OR PLAT TO WHICH THIS CERTIFICATION IS AFFIXED MEETS ALL STATUTORY REQUIREMENTS FOR RECORDING.

REVIEW OFFICER _____ DATE _____

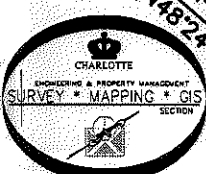

PREPARED BY:
 CITY OF CHARLOTTE
 ENGINEERING DEPARTMENT
 600 EAST FOURTH STREET
 CHARLOTTE, NC 28202
 704-336-2291

		CHARLOTTE ENGINEERING DEPARTMENT
ORVIS ST. SIDEWALK		JOB NO. 512-09-014
PROPERTY OF RAYMOND WORSLEY, MARIE W. MATTHEWS AND WILLIAM WORSLEY CHARLOTTE, MECKLENBURG CO., NC		209014
REVISIONS		SHEET 1
SCALE 1"=20'		OF 1
DRAWN BY P.S.	CHECKED BY DS	SURVEY SUPVR. <i>DKK</i>
DATE		

ACQUISITION BY DB 26763 PG 238-245