

AS-503

NOTE: Property corners shown circled were located by actual survey. Bearings are based on SIXTH ST. R/W MAPS

N CHURCH ST.

S 50-54-48 W

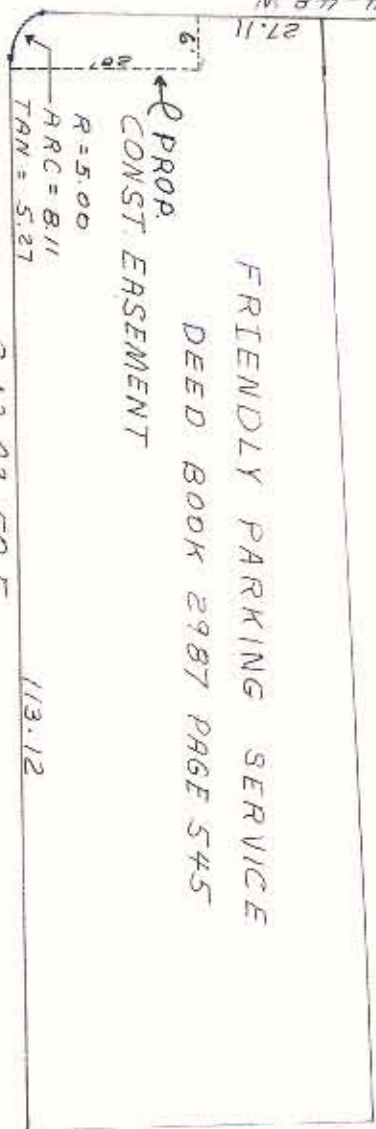

Approved by _____
R/W Agent

W SIXTH ST.

This plat was prepared under my supervision
M. Landburg
N.C. Reg. Engineer No. 36059

CITY OF CHARLOTTE
NORTH CAROLINA
ENGINEERING DEPARTMENT

REVISIONS	JOB NO.
CONST EASEMENT 5	5
NORTH-EAST COR. CHURCH-6 TH	FILE NO.
	5
DRAWN BY GCH	SHEET
CHECKED BY	1
CITY ENGINEER	OF
DATE MAY 14 1971 SCALE 1" = 20'	1

78-024-01