

I, DAVID H. SNIDER, CERTIFY THAT THIS PLAT WAS PREPARED UNDER MY SUPERVISION AND THAT THE PLAT WAS PREPARED FOR THE PURPOSE OF EASEMENTS ONLY, AND IS NOT INTENDED TO BE A BOUNDARY SURVEY OF PROPERTY SHOWN.

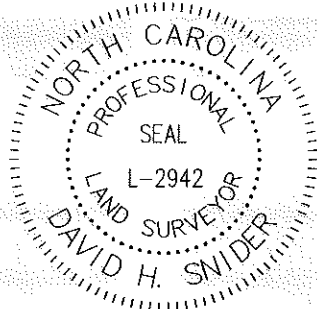

David H. Snider 1/18/13
 DAVID H. SNIDER, NC P.L.S. L-2942 DATE

NOTES

- 1) BEARINGS AND DISTANCES SHOWN IN PARENTHESES ARE BASED ON RECORDED MAP INFORMATION.
- 2) TOTAL AREA 110,203 SQ. FT.
- 3) TOTAL TEMP CONSTRUCTION EASEMENT 15,957 SQ. FT.
- 4) FEE SIMPLE OUTSIDE RIGHT OF WAY 16,289 SQ. FT.
- 5) UTILITY EASEMENT 59 SQ. FT.
- 6) TOTAL AREA REMAINING 93,914 SQ. FT.
- 7) EXISTING PERMANENT SIDEWALK EASEMENT DB 8293 PG 831

LEGEND

- IRON PIN SET
- IRON PIN FOUND
- CALCULATED POINT
- LINES SURVEYED
- LINES NOT SURVEYED
- TEMP. CONSTRUCTION EASEMENT
- FEE SIMPLE OUTSIDE RIGHT OF WAY
- UTILITY EASEMENT

PREPARED BY:
 CITY OF CHARLOTTE
 ENGINEERING DEPARTMENT
 600 EAST FOURTH STREET
 CHARLOTTE, NC 28202
 704-336-2291

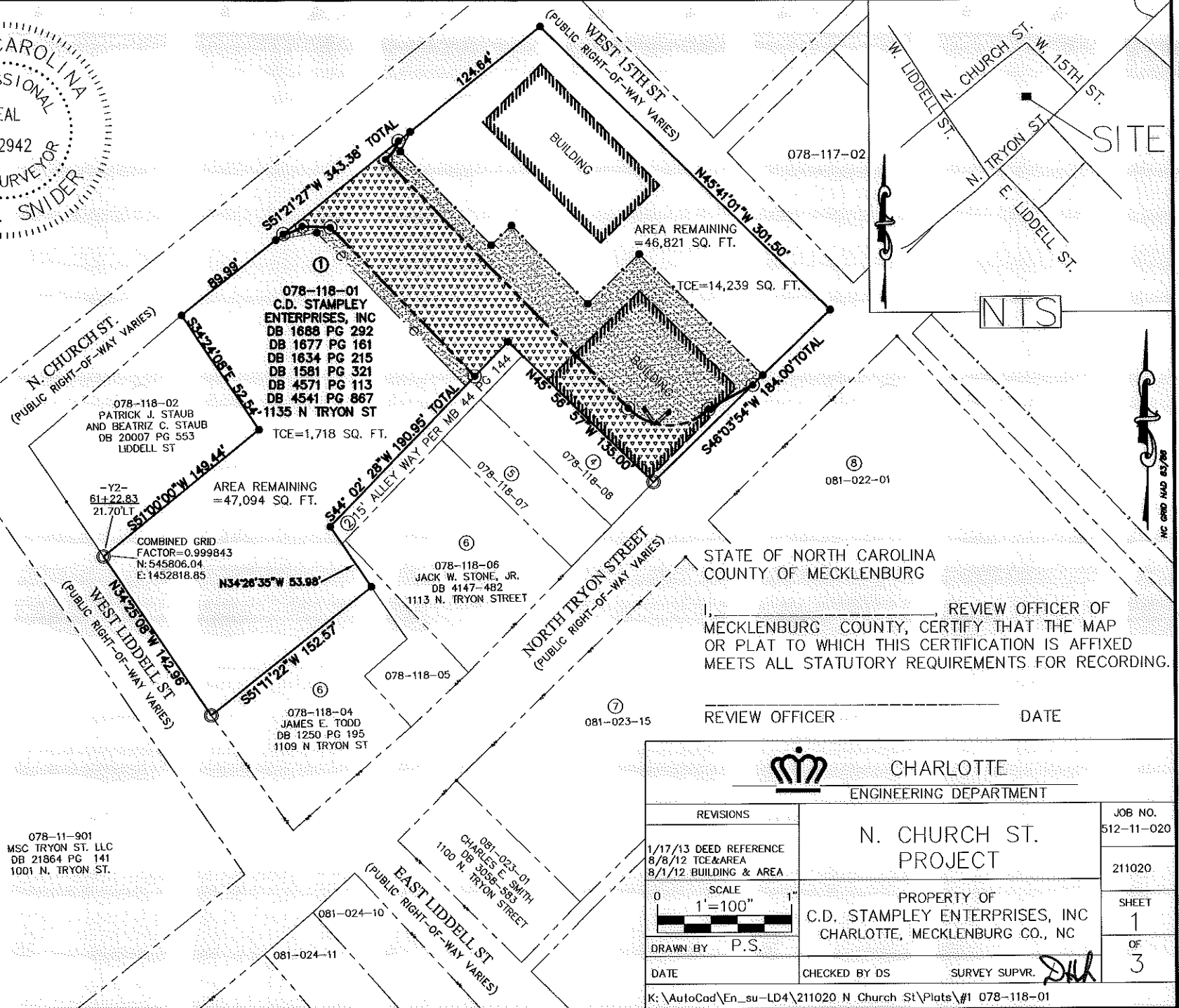
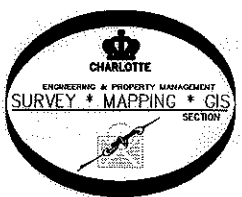

STATE OF NORTH CAROLINA
 COUNTY OF MECKLENBURG

I, _____, REVIEW OFFICER OF MECKLENBURG COUNTY, CERTIFY THAT THE MAP OR PLAT TO WHICH THIS CERTIFICATION IS AFFIXED MEETS ALL STATUTORY REQUIREMENTS FOR RECORDING.

REVIEW OFFICER _____ DATE _____

		CHARLOTTE ENGINEERING DEPARTMENT	
REVISIONS		N. CHURCH ST. PROJECT	JOB NO. 512-11-020
1/17/13 DEED REFERENCE 8/8/12 TCE&AREA 8/1/12 BUILDING & AREA			211020
SCALE 0 1' = 100"		PROPERTY OF C.D. STAMPLEY ENTERPRISES, INC CHARLOTTE, MECKLENBURG CO., NC	SHEET 1
DRAWN BY P.S.			OF 3
DATE	CHECKED BY DS	SURVEY SUPVR. <i>DHK</i>	
K:\AutoCad\En_su-LD4\211020 N Church St\Plats\#1 078-118-01			

ACQUISITION BY DB 28783 PG 452

I, DAVID H. SNIDER, CERTIFY THAT THIS PLAT WAS PREPARED UNDER MY SUPERVISION AND THAT THE PLAT WAS PREPARED FOR THE PURPOSE OF EASEMENTS ONLY, AND IS NOT INTENDED TO BE A BOUNDARY SURVEY OF PROPERTY SHOWN.

David H. Snider 1/19/13
 DAVID H. SNIDER, NC P.L.S. L-2942 DATE

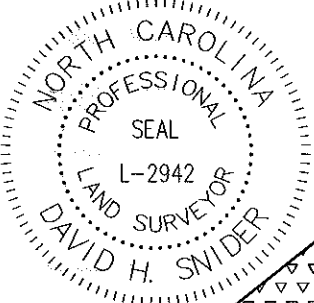

NOTES

- 1) BEARINGS AND DISTANCES SHOWN IN PARENTHESES ARE BASED ON RECORDED MAP INFORMATION.
- 2) TOTAL AREA 110,203 SQ. FT.
- 3) TOTAL TEMP CONSTRUCTION EASEMENT 15,957 SQ. FT.
- 4) FEE SIMPLE OUTSIDE RIGHT OF WAY 16,289 SQ. FT.
- 5) UTILITY EASEMENT 59 SQ. FT.
- 6) TOTAL AREA REMAINING 93,914 SQ. FT.
- 7) EXISTING PERMANENT SIDEWALK EASEMENT DB 8293 PG 831

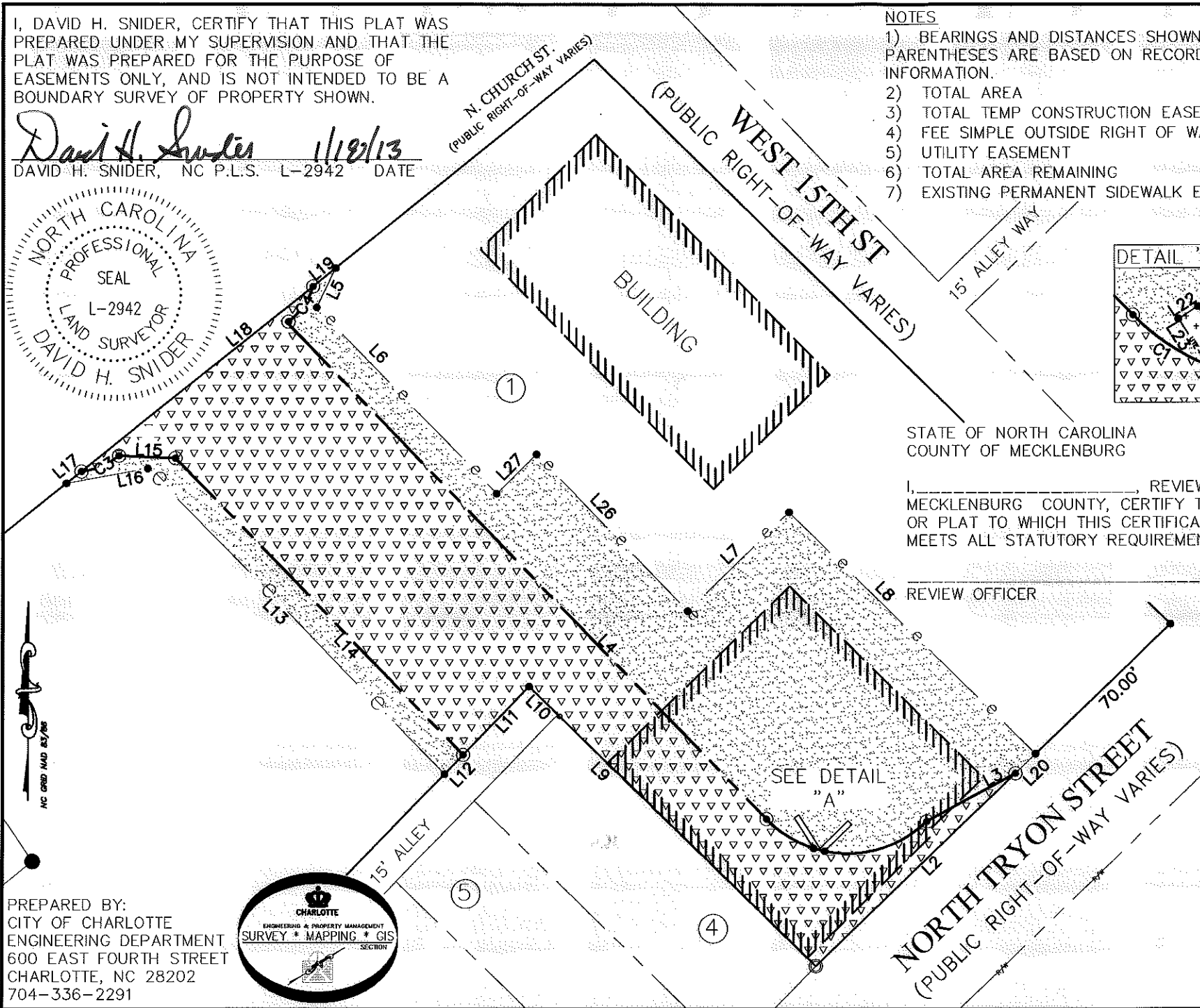
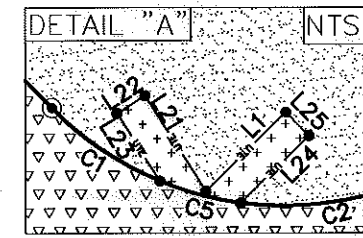
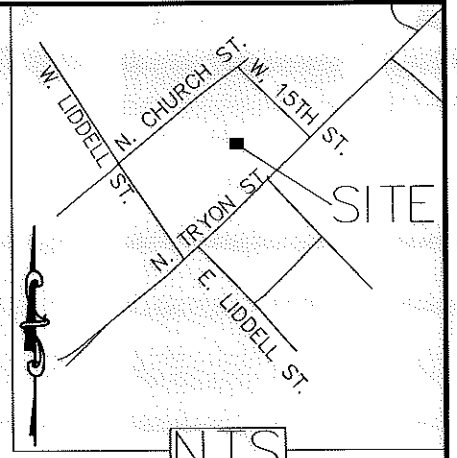

STATE OF NORTH CAROLINA
 COUNTY OF MECKLENBURG

I, _____, REVIEW OFFICER OF MECKLENBURG COUNTY, CERTIFY THAT THE MAP OR PLAT TO WHICH THIS CERTIFICATION IS AFFIXED MEETS ALL STATUTORY REQUIREMENTS FOR RECORDING.

REVIEW OFFICER _____ DATE _____

LEGEND

- IRON PIN SET
- IRON PIN FOUND
- CALCULATED POINT
- LINE SURVEYED
- LINE NOT SURVEYED
- TEMP. CONSTRUCTION EASEMENT
- FEE SIMPLE OUTSIDE RIGHT OF WAY
- UTILITY EASEMENT

PREPARED BY:
 CITY OF CHARLOTTE
 ENGINEERING DEPARTMENT
 600 EAST FOURTH STREET
 CHARLOTTE, NC 28202
 704-336-2291

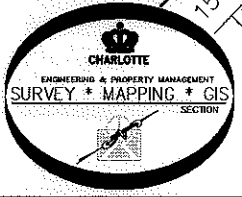

		CHARLOTTE ENGINEERING DEPARTMENT
REVISIONS 1/17/13 DEED REFERENCE 8/8/12 TCE & AREA 8/1/12 BUILDING & AREA		JOB NO. 512-11-020 211020
SCALE 0 1' = 50" 1"		PROPERTY OF C.D. STAMPLEY ENTERPRISES, INC CHARLOTTE, MECKLENBURG CO., NC
DRAWN BY P.S.	CHECKED BY DS	SURVEY SUPVR. <i>DSK</i>
DATE	SHEET 2 OF 3	
K:\AutoCad\En_su-LD4\211020 N Church St\Plats\#1 078-118-01		

I, DAVID H. SNIDER, CERTIFY THAT THIS PLAT WAS PREPARED UNDER MY SUPERVISION AND THAT THE PLAT WAS PREPARED FOR THE PURPOSE OF EASEMENTS ONLY, AND IS NOT INTENDED TO BE A BOUNDARY SURVEY OF PROPERTY SHOWN.

David H. Snider 1/19/13
 DAVID H. SNIDER, NC P.L.S. L-2942 DATE

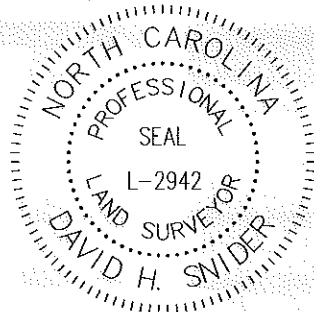

Curve Table				
Curve #	Length	Radius	CHORD BEARING	CHORD
C1	20.93	42.50	S58°20'11"E	20.72
C2	41.46	42.50	N73°49'26"E	39.83
C3	15.46	27.00	S67°26'22"W	15.25
C4	16.35	27.00	S34°59'21"W	16.10
C5	4.29	42.50	S75°20'19"E	4.29

Line Table		
Line #	Length	Direction
L1	14.24	N45°49'29"E
L2	103.51	S46°03'54"W
L3	37.63	N61°32'30"E
L4	258.52	S44°13'40"E
L5	16.38	S26°00'37"W
L6	97.02	S44°13'40"E
L7	53.00	N45°53'02"E
L8	129.06	S45°37'02"E
L9	135.00	N45°56'57"W
L10	15.00	N45°56'57"W
L11	35.64	S44°02'28"W
L12	9.98	S44°02'28"W
L13	159.25	S44°14'16"E
L14	168.61	S44°13'40"E
L15	21.15	N87°31'03"W
L16	31.01	N79°44'00"E
L17	7.08	S51°21'27"W
L18	110.66	S51°21'27"W
L19	11.03	S51°21'27"W
L20	10.49	S46°03'54"W
L21	14.77	S32°16'09"E
L22	2.00	S57°43'51"W
L23	13.48	S32°16'09"E
L24	14.23	S45°49'29"W
L25	2.00	N44°10'31"W
L26	81.50	S44°13'40"E
L27	21.00	N45°46'20"E

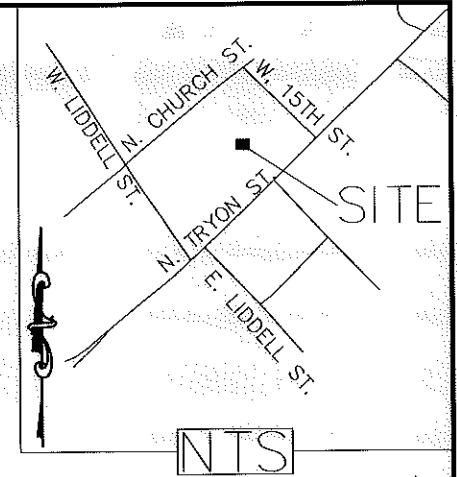

STATE OF NORTH CAROLINA
 COUNTY OF MECKLENBURG

_____, REVIEW OFFICER OF
 MECKLENBURG COUNTY, CERTIFY THAT THE MAP
 OR PLAT TO WHICH THIS CERTIFICATION IS AFFIXED
 MEETS ALL STATUTORY REQUIREMENTS FOR RECORDING.

REVIEW OFFICER _____ DATE _____

NOTES

- BEARINGS AND DISTANCES SHOWN IN PARENTHESES ARE BASED ON RECORDED MAP INFORMATION.
- TOTAL AREA 110,203 SQ. FT.
- TOTAL TEMP CONSTRUCTION EASEMENT 15,957 SQ. FT.
- FEE SIMPLE OUTSIDE RIGHT OF WAY 16,289 SQ. FT.
- UTILITY EASEMENT 59 SQ. FT.
- TOTAL AREA REMAINING 93,914 SQ. FT.
- EXISTING PERMANENT SIDEWALK EASEMENT DB 8293 PG 831

LEGEND

- IRON PIN SET
- IRON PIN FOUND
- CALCULATED POINT
- LINES SURVEYED
- LINES NOT SURVEYED
- TEMP. CONSTRUCTION EASEMENT
- FEE SIMPLE OUTSIDE R/W
- UTILITY EASEMENT

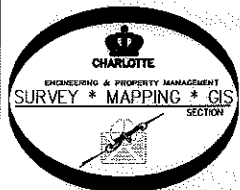

PREPARED BY:
 CITY OF CHARLOTTE
 ENGINEERING DEPARTMENT
 600 EAST FOURTH STREET
 CHARLOTTE, NC 28202
 704-336-2291

		CHARLOTTE ENGINEERING DEPARTMENT	
REVISIONS		N. CHURCH ST. PROJECT	JOB NO. 512-11-020
1/17/13 DEED REFERENCE 8/8/12 TCE&AREA 8/1/12 BUILDING & AREA			211020
SCALE 1"=50" 		PROPERTY OF C.D. STAMPLEY ENTERPRISES, INC CHARLOTTE, MECKLENBURG CO., NC	SHEET 3
DRAWN BY P.S.			OF 3
DATE	CHECKED BY DS	SURVEY SUPVR <i>DH</i>	
K:\AutoCad\En_su-LD4\211020 N Church St\Plats\#1 078-118-01			