

I, R. DENNIS SMITH, CERTIFY THAT THIS PLAT WAS PREPARED UNDER MY SUPERVISION AND THAT THE PLAT WAS PREPARED FOR THE PURPOSE OF ACQUISITION AND EASEMENTS ONLY, AND IS NOT INTENDED TO BE A BOUNDARY SURVEY OF PROPERTY SHOWN.

*R. Dennis Smith 4/1/98*  
 R. DENNIS SMITH, NC R.L.S. L-1482 DATE

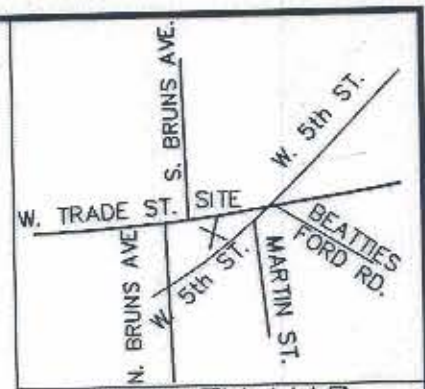

VICINITY MAP  
NOT TO SCALE

NC GRID NAD 83

NOTE:

- 1) LINES NOT SURVEYED ARE SHOWN AS BROKEN LINES
- 2) TOTAL AREA 7,431 SQ. FT.
- 3) PERMANENT UTILITY EASEMENT 48 SQ. FT.
- 4) TEMPORARY CONSTRUCTION EASEMENT 15 SQ. FT.

W. TRADE STREET  
R/W VARIES

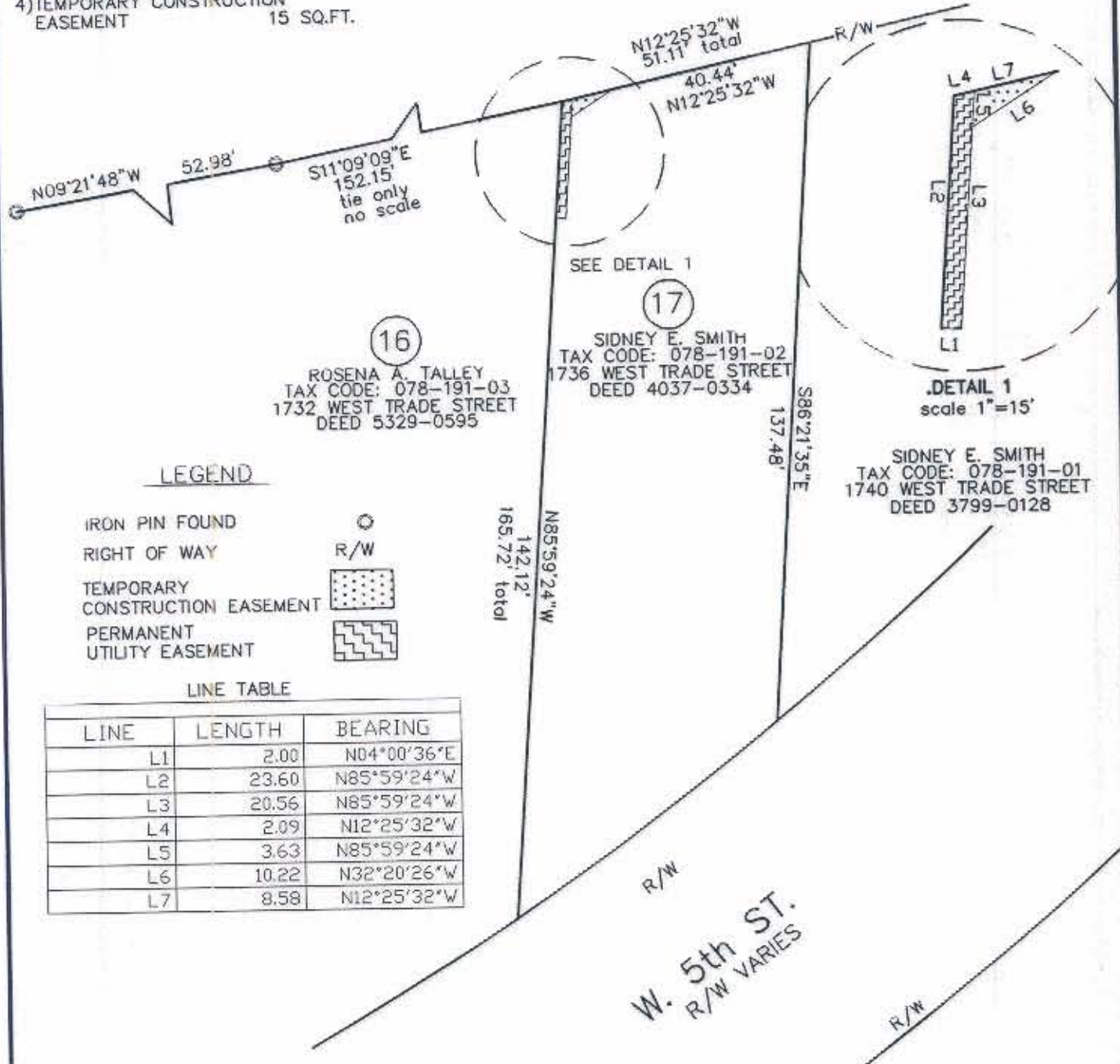

LEGEND

- IRON PIN FOUND
- RIGHT OF WAY
- TEMPORARY CONSTRUCTION EASEMENT
- PERMANENT UTILITY EASEMENT

LINE TABLE

LINE	LENGTH	BEARING
L1	2.00	N04°00'36"E
L2	23.60	N85°59'24"W
L3	20.56	N85°59'24"W
L4	2.09	N12°25'32"W
L5	3.63	N85°59'24"W
L6	10.22	N32°20'26"W
L7	8.58	N12°25'32"W

GRAPHIC SCALE

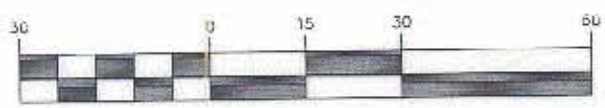

( IN FEET )

PREPARED BY: 1 inch = 30 ft.  
 CITY OF CHARLOTTE  
 ENGINEERING DEPARTMENT  
 600 EAST FOURTH STREET  
 CHARLOTTE, NC 28208  
 704-336-2291

		CHARLOTTE ENGINEERING DEPARTMENT	
REVISIONS	WEST TRADE STREET IMPROVEMENTS		JOB NO. 51296039
	EASEMENT ACQUISITION SIDNEY E. SMITH		FILE NO. PARCEL17
DRAWN BY GAI	CHARLOTTE, MECKLENBURG CO., NC		SHEET 1
CHECKED BY <i>RDS</i>	DATE 03/30/98		OF 1
SURVEY SUPERV.	SCALE 1" = 30'		