

MARTIN STREET

588.00-00E  
129.00 TOTAL

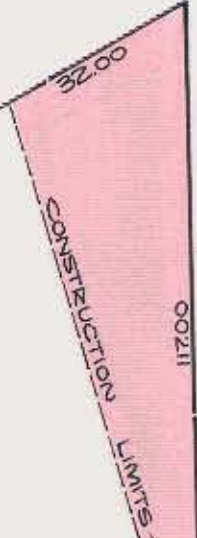

300.00-00E

SUMMIT AVE.

216.00 TOTAL

ZOEL SYLVESTER HARGRAVE  
LOTS # 1-2-3 BLOCK 4  
MAP BOOK 230-PAGE 181

N 32-45-00E  
181.00

116.70  
S 70-15-00E

OWENS

PETTUS



This plat was prepared under my supervision *Kb Billis*  
N.C. Reg. Engineer No. 4343

NOTE: Property corners shown circled were located by actual survey. Bearings are based on MAGNETIC NORTH FROM FIELD SURVEY MAY 5, 1972

CITY OF CHARLOTTE NORTH CAROLINA DEPARTMENT OF PUBLIC WORKS ENGINEERING DIVISION		
REVISIONS	CONSTRUCTION EASEMENT FOR SIGHT LINE	JOB NO.
		FILE NO.
DRAWN BY MAM.	PROPERTY OF ZOEL SYLVESTER HARGRAVE, SR. 435 N. SUMMIT AVE.	SHEET
CHECKED BY GCH		1
CITY ENGINEER	DATE MAY 4, 1972 SCALE 1"=30'	OF
		1

78-195-38 To 41