

Approved by \_\_\_\_\_  
R/W Agent

Harold L. Walker  
Deed 1385-581

R.P. Boulding  
Deed 1684-68

This plat was prepared under my  
supervision C. D. Dreading  
N.C. Reg. Engineer No. 3659

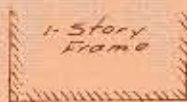

#1030

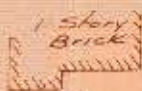

1 Story Brick  
Prop Construction Easement

#1032

NOTE: Property corners shown circled were located by actual survey. Bearings are based on RECORD MAP DRUID HILLS

DRUID

CIRCLE

Prop Storm Drainage

N-76-37-28E  
90' Turn

#1037



Prop Construction Easement

#1029

N-13-22-32 W  
180'

Mrs Brennie Anderson

180' Turn  
N-13-22-32 W

Edward Camp  
Deed 2107-463

90'  
N-76-37-28E

CITY OF CHARLOTTE  
NORTH CAROLINA  
ENGINEERING DEPARTMENT

REVISIONS	PROP. CONSTRUCTION EASEMENT DRUID CIRCLE	JOB NO. 513
		FILE NO. 68-345
DRAWN BY J.S.B.	Property of MRS. BRENNIE ANDERSON	SHEET 3
CHECKED BY J.T.K.		OF 5
CITY ENGINEER	DATE Feb 1969	SCALE 1"=40'

79-048-47

A-7-K-75 (3)