

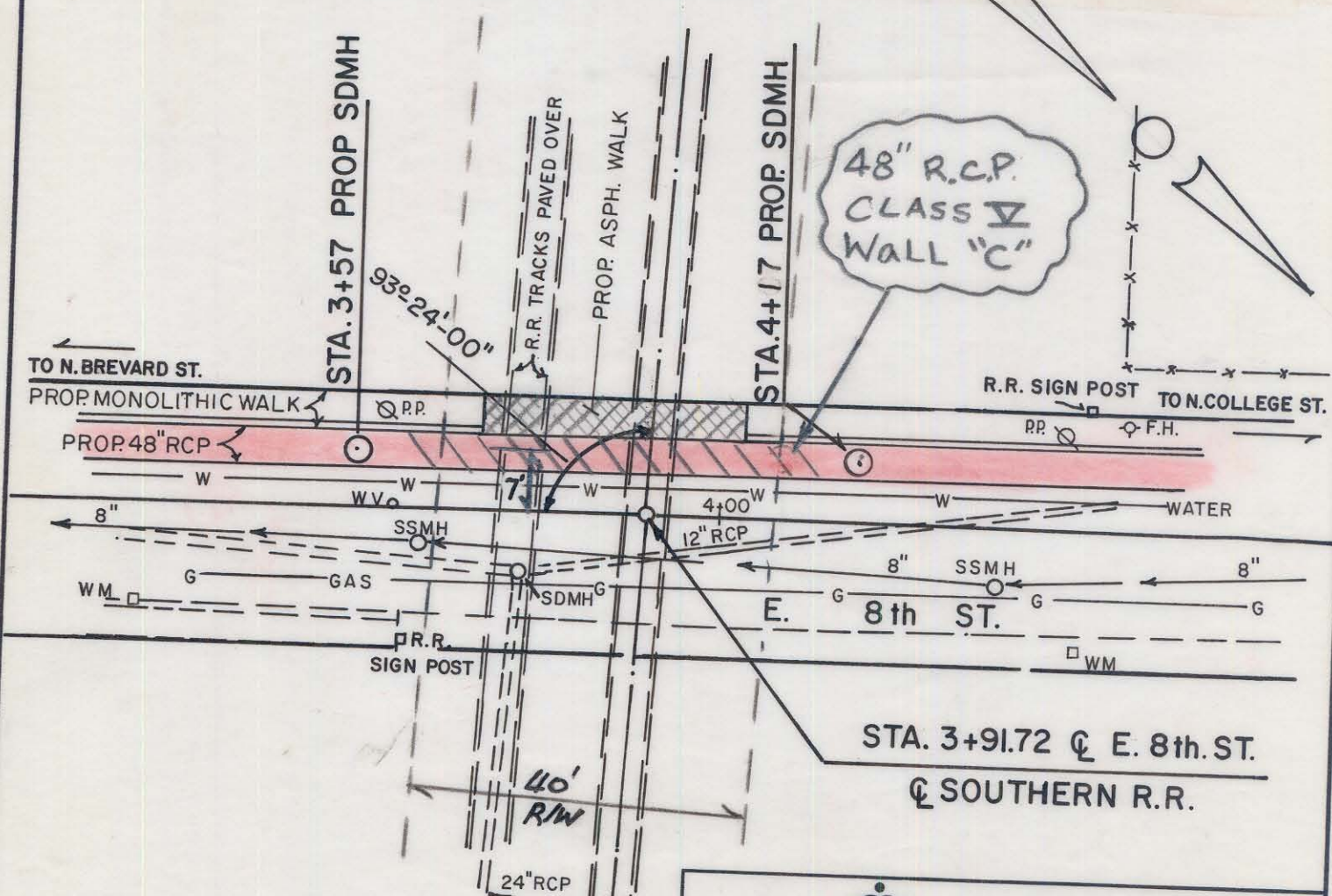

Pipe Line and Crossing to be installed and maintained in accordance with latest approved AMERICAN RAILWAY ENGINEERING ASSOCIATION'S "Specifications for Pipelines for Conveying Flammable and Non-flammable Substances".



 CHARLOTTE ENGINEERING DEPARTMENT		JOB NO.
REVISIONS 4-24-68 Notes From S. RAILWAY System	SOUTHERN RAILWAY CROSSING E. 8th ST.	FILE NO.
DRAWN BY MAS CHECKED BY	PROPOSED PIPE ENCROACHMENT	SHEET 1
CITY ENGINEER	DATE JUNE 17 1985 SCALE 1" = 20'	OF 2

Charlotte, N.C.
 120-3-350
 Sou Ry V-9/3

080-024-