

81-075

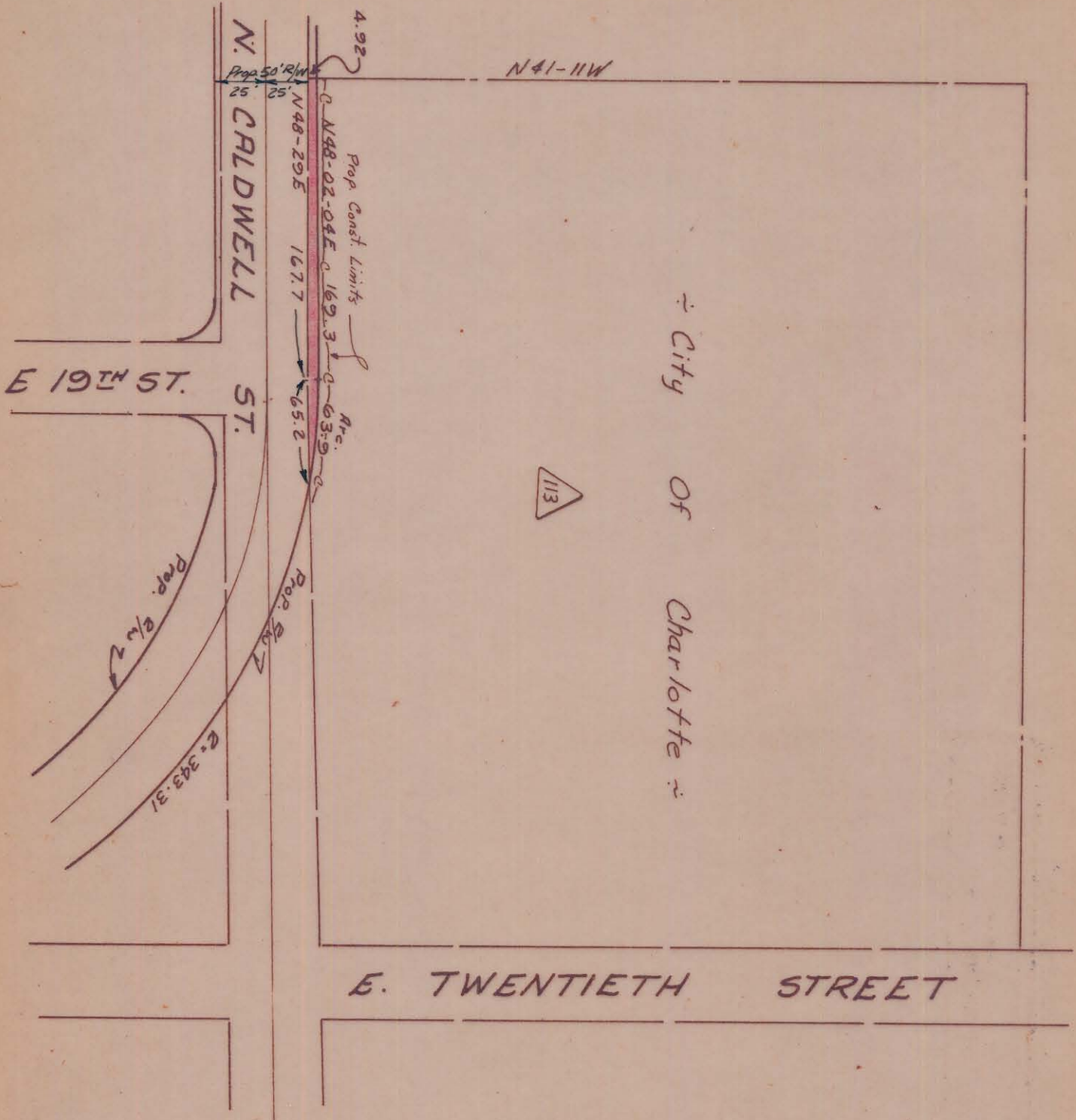

City of Charlotte

113

E. TWENTIETH STREET

Approved by \_\_\_\_\_  
R/W Agent

This plat was prepared under my supervision  
*C. D. Leadley*  
N.C. Reg. Engineer No. 3659

NOTE: Property corners shown circled were located by actual survey. Bearings are based on Eight-57-Way Maps By Ralph Whitehead & Assoc.

Total Area	194,200	Sq. Ft.
Area Taken	1,431	Sq. Ft.
Area Remaining	192,769	Sq. Ft.

<b>CITY OF CHARLOTTE</b> NORTH CAROLINA ENGINEERING DEPARTMENT		JOB NO. 573-48
REVISIONS	Belmont Neighborhood Improvement Project	FILE NO. 472
DRAWN BY <i>C. Hoffer</i> CHECKED BY <i>YTT</i> CITY ENGINEER	Property of City of Charlotte	SHEET 107 OF 118
DATE <i>Aug. 1969</i> SCALE <i>1" = 80'</i>		