

NORTH BREVARD STREET

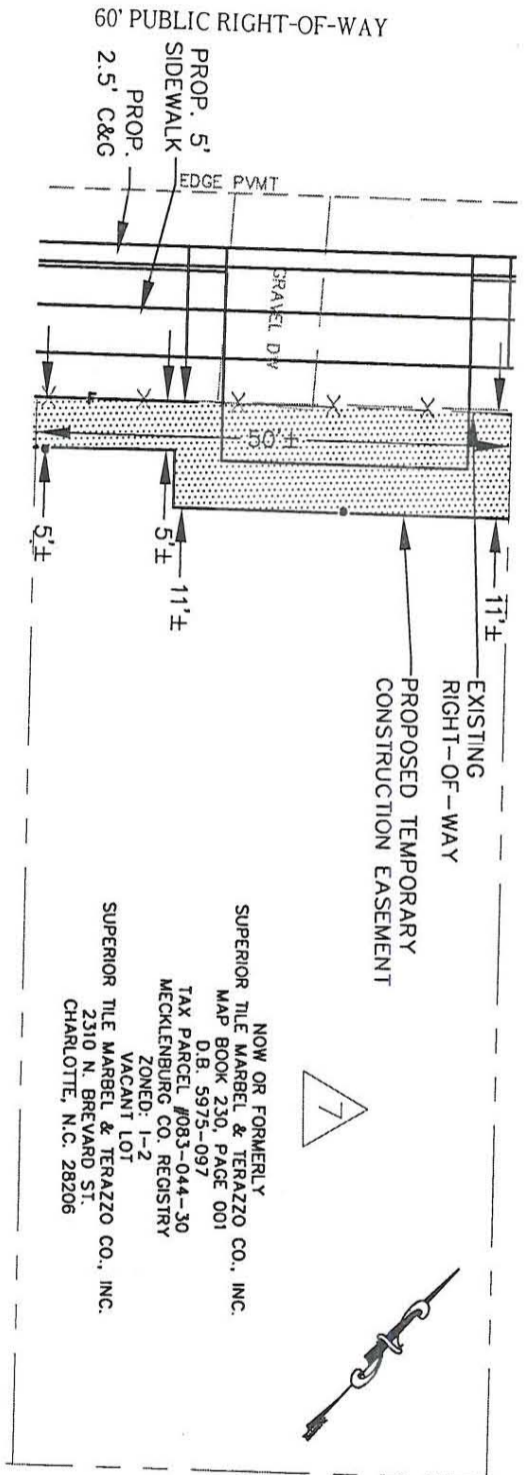

NOW OR FORMERLY
 SUPERIOR TILE MARBEL & TERAZZO CO., INC.
 MAP BOOK 230, PAGE 001
 D.B. 5975-097
 TAX PARCEL #083-044-30
 MECKLENBURG CO. REGISTRY
 ZONED: 1-2
 VACANT LOT
 SUPERIOR TILE MARBEL & TERAZZO CO., INC.
 2310 N. BREVARD ST.
 CHARLOTTE, N.C. 28206

- 1) TOTAL AREA = ±5,524 SQ. FT.
- 2) TEMPORARY CONSTRUCTION EASEMENT = ±462 SQ. FT.

LEGEND

- Temporary Construction Easement
- Temporary Construction Easement
- Existing Edge of Pavement
- Existing Property Line



Note:

This map is not a certified survey and has not been reviewed by a local government agency for compliance with any applicable land development regulations.

ACQUISITION BY CITY
 RECORDED IN DEED BOOK
 17217-705
 DATE 05/19/2004

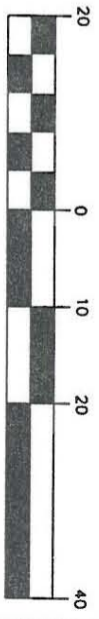

GRAPHIC SCALE



Kimley-Horn
 and Associates, Inc.
 © 2003

4601 CHARLOTTE PARK DR, STE 350
 Charlotte, North Carolina 28217
 TEL: (704) 333-5131
 FAX: (704) 333-0845

<p>CHARLOTTE, ENGINEERING & PROPERTY MANAGEMENT</p>		<p>SUPERIOR TILE MARBEL & TERAZZO CO., INC. 2310 N. BREVARD ST. CHARLOTTE, N.C. 28206</p>
<p>512-02-047 JOB NO.</p>	<p>1" = 20' SCALE</p>	<p>TAX ID# 083-044-30 D.B. 5975 - P.G. 097</p>
<p>SS PREPARED BY</p>	<p>09/23/03 DATE</p>	<p>015016\037\CADD\015016037PLATS.DWG CAD FILE PATH</p>

083-044-30