

ACQUISITION BY CITY

RECORDED IN DEED BOOK

8740 Pg 013

DATE 9/16/96

PER N.C.D.O.T.
PROJECT NO.
8.1636601 (I-85)

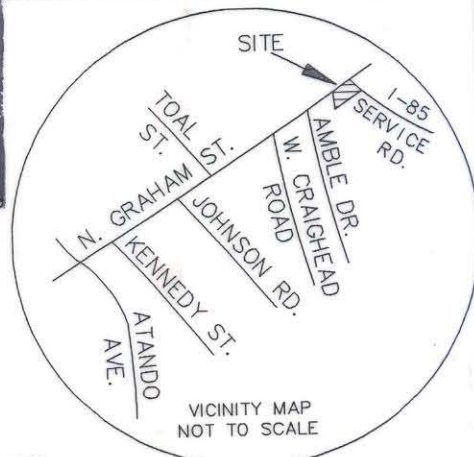

THIS PLAT WAS PREPARED UNDER MY SUPERVISION

R. Dennis Smith 5/2/93

N.C. REG. LAND SURVEYOR No. 1482



THIS PLAT WAS PREPARED FOR THE PURPOSE OF ACQUISITION ONLY, AND IS NOT INTENDED TO BE A BOUNDARY SURVEY OF THE PROPERTY SHOWN.

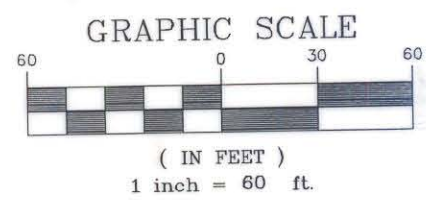
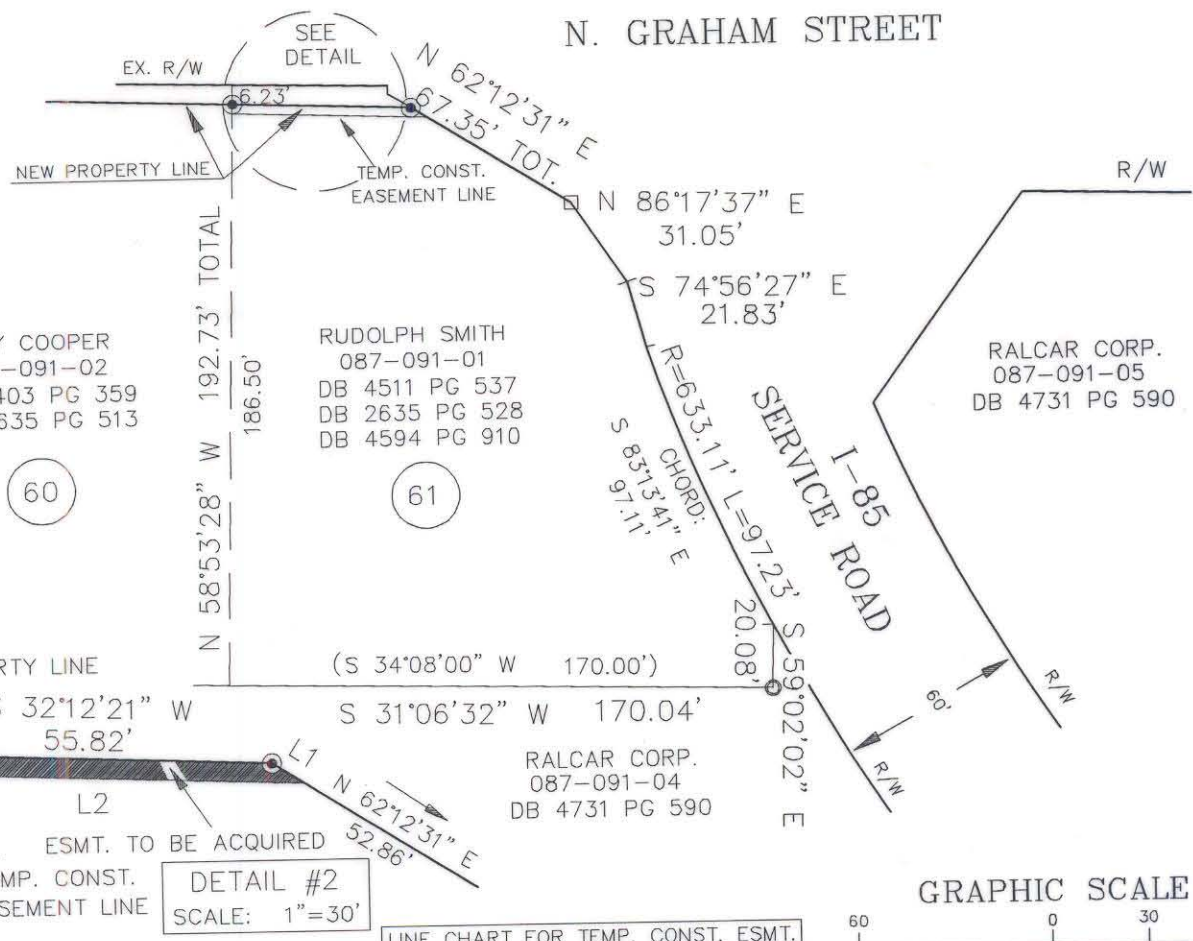
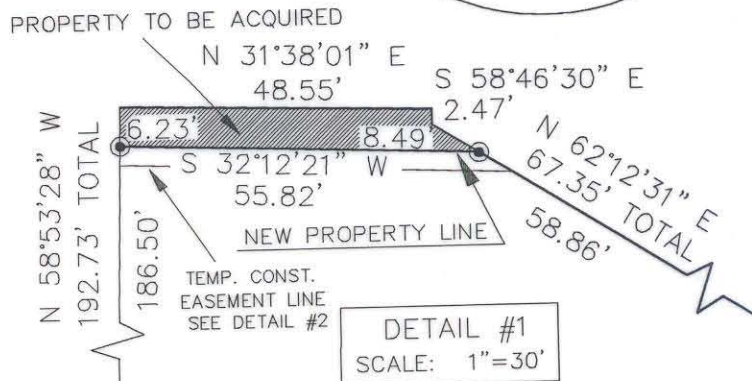

LINE CHART FOR TEMP. CONST. ESMT.

LINE	DIRECTION	DISTANCE
L1	N 62°12'31" E	6.00'
L2	S 32°09'07" W	60.96'
L3	N 58°53'28" W	3.06'

- NOTES
- BEARINGS AND DISTANCES SHOWN IN PARENTHESES ARE BASED ON DEED INFORMATION.
 - BROKEN LINES INDICATE PROPERTY NOT SURVEYED.
 - TOTAL AREA BY DEED: 24,983 SQ. FT.
AREA ACQUIRED: 330 SQ. FT.
AREA REMAINING: 24,653 SQ. FT.
 - TOTAL AREA OF TEMP. CONST. ESMT: 177 SQ. FT.

- LEGEND
- EXISTING IRON PIN
 - IRON SET
 - RIGHT-OF-WAY MONUMENT FOUND

PREPARED BY:
CITY OF CHARLOTTE
ENGINEERING DEPARTMENT
600 E. FOURTH STREET
CHARLOTTE, NC 28202-2844
(704) 336-2291

CHARLOTTE
ENGINEERING DEPARTMENT

N. GRAHAM ST. SIDEWALK
DALTON AVE. TO I-85
SIDEWALK PROGRAM 90-3

PROPERTY OF
RUDOLPH SMITH

CITY OF CHARLOTTE, MECK. CO., N.C.

DATE 05-19-93 SCALE 1"=60'

REVISIONS

DRAWN BY *cdb*

CHECKED BY *RDS*

SURVEY SUPVR.

JOB NO. 92033
FILE NO. 90035
NGPLAT9

SHEET 1 OF 1

DB 8740 013