



ELGYWOOD

S.13°-32'-05"E.
305.99'

S.13°-32'-05"E.
305.86'

Arrowhead Dr.

LANE

R=609.35'
148.08'
R=579.35'
145.30'
30.35'

N.81°-13'-00"E. TOTAL 225.77'
195.67'

HOBERT SMITH CONSTRUCTION CO.
089-222-38
DEED 3223-299
Total Area 68,735 Sq. Ft.=1.578 Ac.
Area Taken 9,178 Sq. Ft.=0.211 Ac.
Area Remaining 59,557 Sq. Ft.=1.367 Ac.

HOBERT SMITH CONSTRUCTION CO.
089-222-37
DEED 2961-486
Total Area 38,734 Sq. Ft.=0.889 Ac.
Area Taken 5,208 Sq. Ft.=0.120 Ac.
Area Remaining 33,526 Sq. Ft.=0.769 Ac.

N.81°-28'-01"E. TOTAL 225.85'
195.74'

S.81°-52'-22"W. TOTAL 229.01'
198.66'

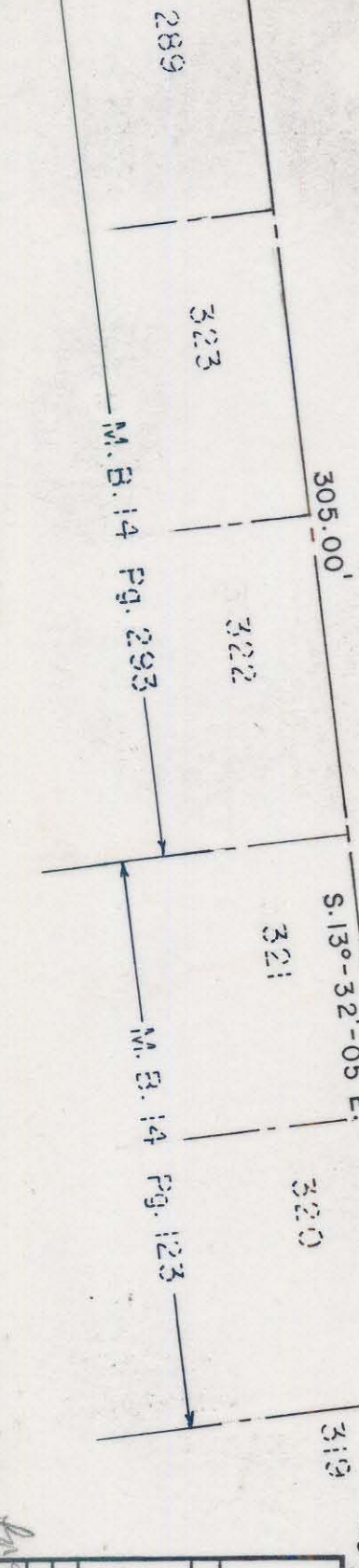

2

3

NOTE: Property corners shown circled were located by actual survey. Bearings are based on UNRECORDED MAP OF THE R. L. HUNTER ESTATE DATED 1952.

This map was prepared for the purpose of right of way or easement acquisition only, and is not intended to be a boundary survey of the property shown.

This plat was prepared under my supervision *Stephen A. Gilbert*
N. C. Reg. Surveyor No. L-1785



REVISIONS		CITY OF CHARLOTTE NORTH CAROLINA DEPARTMENT OF PUBLIC WORKS ENGINEERING DIVISION	
PROPERTY TO BE ACQUIRED BY CITY OF CHARLOTTE		PROPERTY OF HOBERT SMITH CONSTRUCTION CO.	
DRAWN BY BC	CHECKED BY <i>BC</i>	DATE 9-29-80	SCALE 1" = 50'
JOB NO. 512-75-173	FILE NO.	SHEET 2	OF 14

089-222-48/49/50/51