

I, GREGORY B. PHILLIPS, CERTIFY THAT THIS PLAT WAS PREPARED UNDER MY SUPERVISION AND THAT THE PLAT WAS PREPARED FOR THE PURPOSE OF ACQUISITION AND EASEMENTS ONLY AND IS NOT INTENDED TO BE A BOUNDARY SURVEY OF THE PROPERTY SHOWN.

GREGORY B. PHILLIPS, NC PLS L, PG 3918 DATE \_\_\_\_\_

STATE OF NORTH CAROLINA  
COUNTY OF MECKLENBURG

\_\_\_\_\_, REVIEW OFFICER OF MECKLENBURG COUNTY,  
CERTIFY THAT THE MAP OR PLAT TO WHICH THIS CERTIFICATION IS  
AFFIXED  
MEETS ALL STATUTORY REQUIREMENTS FOR RECORDING.

REVIEW OFFICER \_\_\_\_\_ DATE \_\_\_\_\_

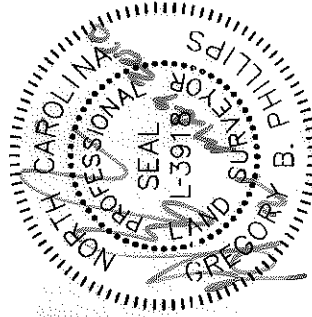

ENGINEERS (ARCADIS)  
NAD 1983

070 09104312  
SARA JOHNSON SPENCER  
MB 5, PG 273  
DB 3936, PG 440  
4115 DINGLEWOOD AVE

9+21.00 L 23.70'  
NC GRID NSRS 2007  
N: 550,453.56'  
E: 1,466,658.01'  
TO NCGS "M046"  
N 81°26'19" E 2457.99' (GRID)  
N 80°7'29" E 2701.62' (LOCAL)  
CFG: 0.9998726015

071 09104313  
LARRY E. & DARIN D.  
MASSEY  
MB 5, PG 273  
DB 5159, PG 22  
4117 DINGLEWOOD AVE

072 09104314  
CORA JUANITA HERRON  
MB 5, PG 273  
DB 2677, PG 136  
4121 DINGLEWOOD AVE

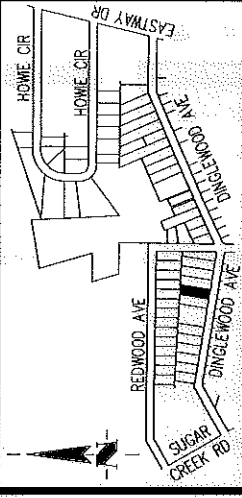

VICINITY MAP NOT TO SCALE

09104321  
FREDERICK B. & DAYLE E.  
MULLINS  
MB 5, PG 273  
DB 20480, PG 446  
4120 REDWOOD AVE

09104322  
REDWOOD 4116, LLC  
MB 5, PG 273  
DB 25311, PG 296  
4116 REDWOOD AVE

S 87°02'13" E 60.36'

N 917°04' E 182.40'  
S 917°04' W 189.05'  
171.55'

TEMPORARY  
CONSTRUCTION  
EASEMENT

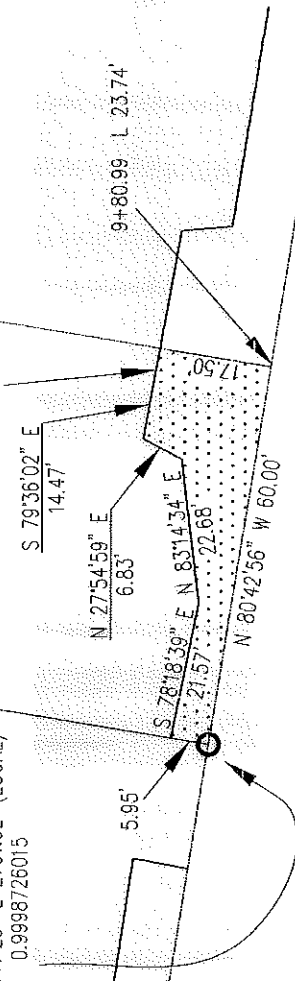

NOTES AND REFERENCES:

1. DEEDS AND MAPS SHOWN HEREON.
2. ALL DISTANCES ARE IN US SURVEY FEET AND DECIMALS THEREOF, UNLESS OTHERWISE NOTED.
3. NC GRID NSRS 2007 NCGS "M 046"

N: 550,899.45' (GRID)  
E: 1,469,322.14' (GRID)  
N: 550,989.13' (LOCAL)  
E: 1,469,554.46' (LOCAL)

LEGEND

- IRON PIN FOUND ○
- TEMP. CONSTRUCTION EASEMENT [Dotted pattern]
- PARCEL NUMBER (XX)
- DEED BOOK DB
- MAP BOOK MB
- PAGE PG

TOTAL AREA: 11,143 SQ. FT.  
TEMPORARY CONSTRUCTION EASEMENT: 584 SQ. FT.  
AREA REMAINING: 11,143 SQ. FT.

		REVISIONS	
		ENGINEERING DEPARTMENT	
JOB NO. 512-08-061		7791.001	
HOWIE ACRES NEIGHBORHOOD IMPROVEMENT PROJECT - PHASE 2		PROPERTY OF LARRY E. MASSEY et. UX. CITY OF CHARLOTTE, MECKLENBURG CO., NC	
SCALE 1"=30'		SHEET 1 OF 1	
DRAWN BY: GBP		CHECKED BY: GBP SURVEY SUPVR.: MSM	
DATE: 21 MAY 2010			

PREPARED BY:  
THE SCHNEIDER CORPORATION  
8001 ARROWRIDGE BLVD.  
CHARLOTTE NC 28273  
704-697-5900  
NC LICENSE # F-1041

ACQUISITION BY DB 2682 PG 466