

THIS PLAN IS NOT SUBJECT TO THE PROVISIONS OF THE CITY OF CHARLOTTE OR MECKLENBURG COUNTY SUBDIVISION ORDINANCES AND DOES NOT REQUIRE THE APPROVAL OF THE MECKLENBURG COUNTY PLANNING COMMISSION. HOWEVER, THE FUTURE DEVELOPMENT OF THIS PROPERTY MAY BE SUBJECT TO THESE ORDINANCES.

CHARLOTTE MECKLENBURG PLANNING COMMISSION  
*Richard B. Hobbs*  
 NOV 11 1999  
 PLANNING COMMISSION STAFF DATE



AREA ACQUIRED		
LINE	BEARING	DIST.
L1	S 81°12'30" E	1.50'
L2	S 8°49'49" W	51.68'
L3	N 81°10'11" W	1.50'
L4	N 8°49'49" E	51.68'

PARCEL AREA DATA		
DESC.	SQ. FT.	AC.
TOTAL PARCEL	440539	10.1
TOTAL AREA ACQ'D	78	n/a
AREA REMAINING	440461	10.1
TOTAL TEMP. CONST. EASE.	325	0.01

TEMP. CONST. EASEMENT		
LINE	BEARING	DIST.
L1	S 81°12'30" E	10.50'
L2	S 8°49'49" W	46.69'
L3	N 81°10'11" W	10.50'
L4	N 8°49'49" E	46.68'

134

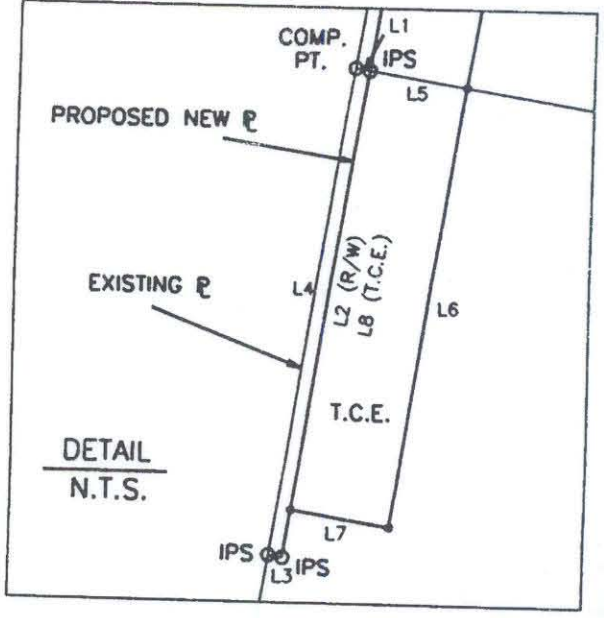

I, Bradley Lloyd Hunter, certify that this plot was drawn under my supervision. This plot is a compilation of field and deed data and is NOT intended to be a boundary survey of the property shown.

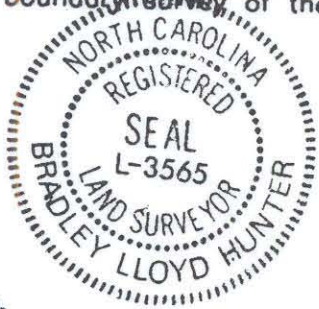

*Bradley Lloyd Hunter*  
 Bradley Lloyd Hunter, NCRLS # L-3565

- REFERENCES:
- 1) NCGS MONUMENTS "RANDY" AND "TAYLOR".
  - 2) CHARLOTTE ENG. DEPT. R/W PLANS FOR PROPOSED MILTON RD. IMPROVEMENTS PREP. BY PBS&J, CHARLOTTE, DATED 10/25/93. (PARCEL #134)
  - 3) D.B. 3452, PG. 363.
  - 4) D.B. 2603, PG. 9.

- NOTES:
- 1) EIP DENOTES EXISTING IRON PIPE.
  - 2) IPS DENOTES IRON PIPE SET.
  - 3) ALL DISTANCES ARE HORIZONTAL GROUND.
  - 4) AREAS BY COORDINATE COMPUTATION.
  - 5) (C) DENOTES COMPUTED.
  - 6) (F) DENOTES FIELD MEASUREMENT

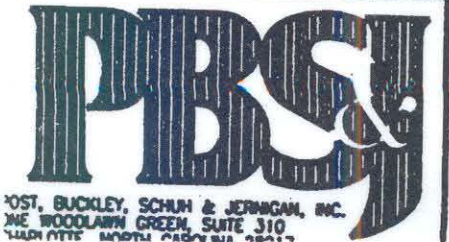

 CHARLOTTE ENGINEERING DEPARTMENT		JOB NO. 99-04819
MILTON ROAD IMPROVEMENTS PROJECT NO. 512-89-062		DWG NO. 04/13/09
PROPERTY OF BARRINGTON CRKS APT. ASSOCIATES L&S MAP CODE 99-211-PARCEL 5 <small>CITY OF CHARLOTTE MECKLENBURG COUNTY</small>		SHEET 1
REVISIONS  DRAWN BY CHECKED BY		

99-211-05