

This map was prepared for the purpose of fee simple right of way or easement acquisition only and it is not intended to be a boundary survey of the property shown.

The bearings and distances shown in parentheses are based on deed information.

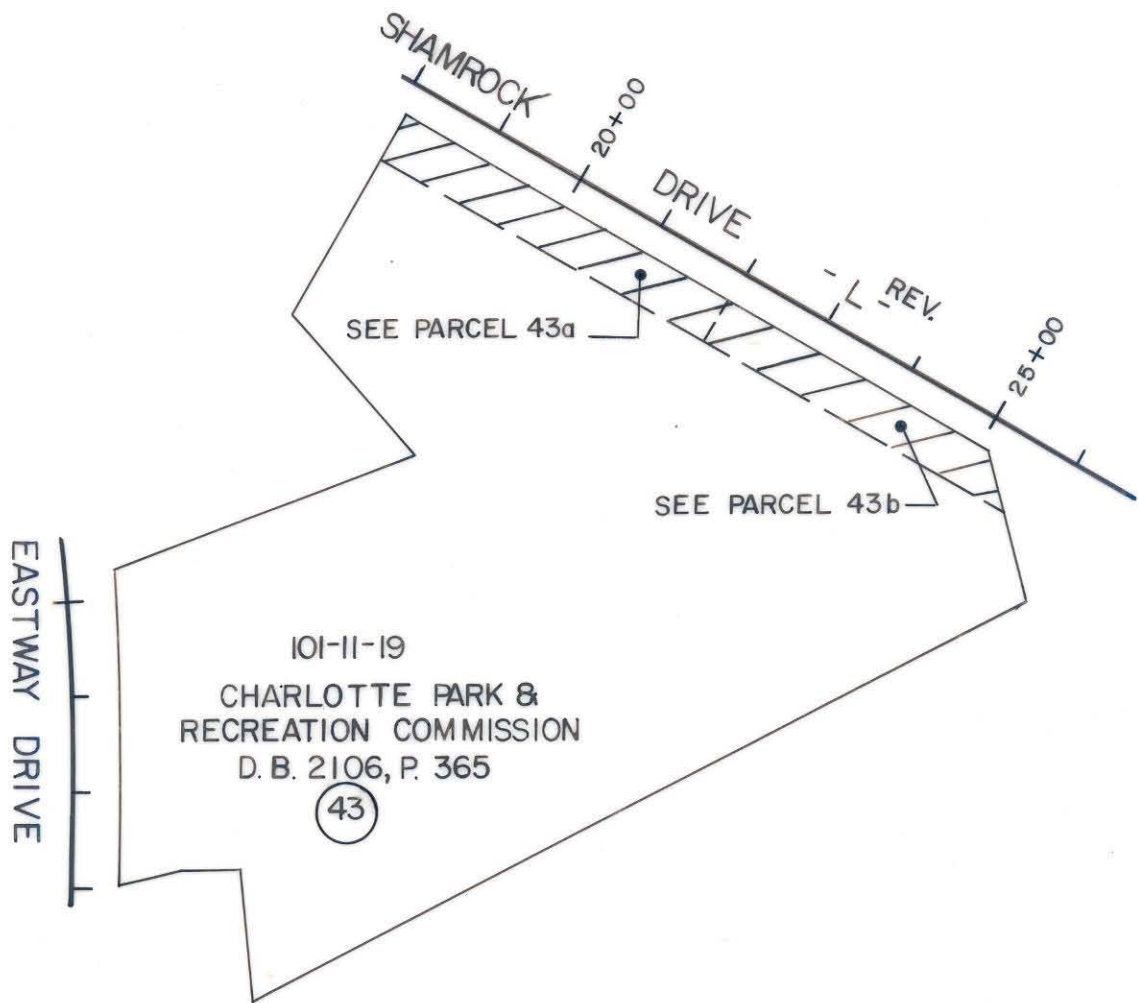

- Iron Pin By Deed
- Iron Pin Found

TOTAL AREA	461,300 S.F. = 10.59	Ac
AREA TO BE ACQ'D.	6,408 S.F. = 0.1471	Ac
UTILITY EASEMENT	78 S.F. = 0.0018	Ac
REMAINING	454,892 S.F. = 10.4429	Ac
CONST. EASEMENT	5,263 S.F. = 0.1208	Ac



F H FLORENCE & HUTCHESON, INC.
CONSULTING ENGINEERS

This plat was prepared under my supervision. *Robert A. Fox*
N. C. Reg. Surveyor No. L-1651

CHARLOTTE ENGINEERING DEPARTMENT		JOB NO.
REVISIONS	SHAMROCK DRIVE PROPERTY OF CHARLOTTE PARK & RECREATION COMMISSION	FILE NO.
DRAWN BY SLA CHECKED BY MSA		SHEET 43 OF 141
SURVEY SUPPL.	DATE 6/89	SCALE 1" = 200'

101-11-19