

This map was prepared for the purpose of fee simple, right of way or easement acquisition only and it is not intended to be a boundary survey of the property shown.

The bearings and distances shown in parentheses are based on deed information.

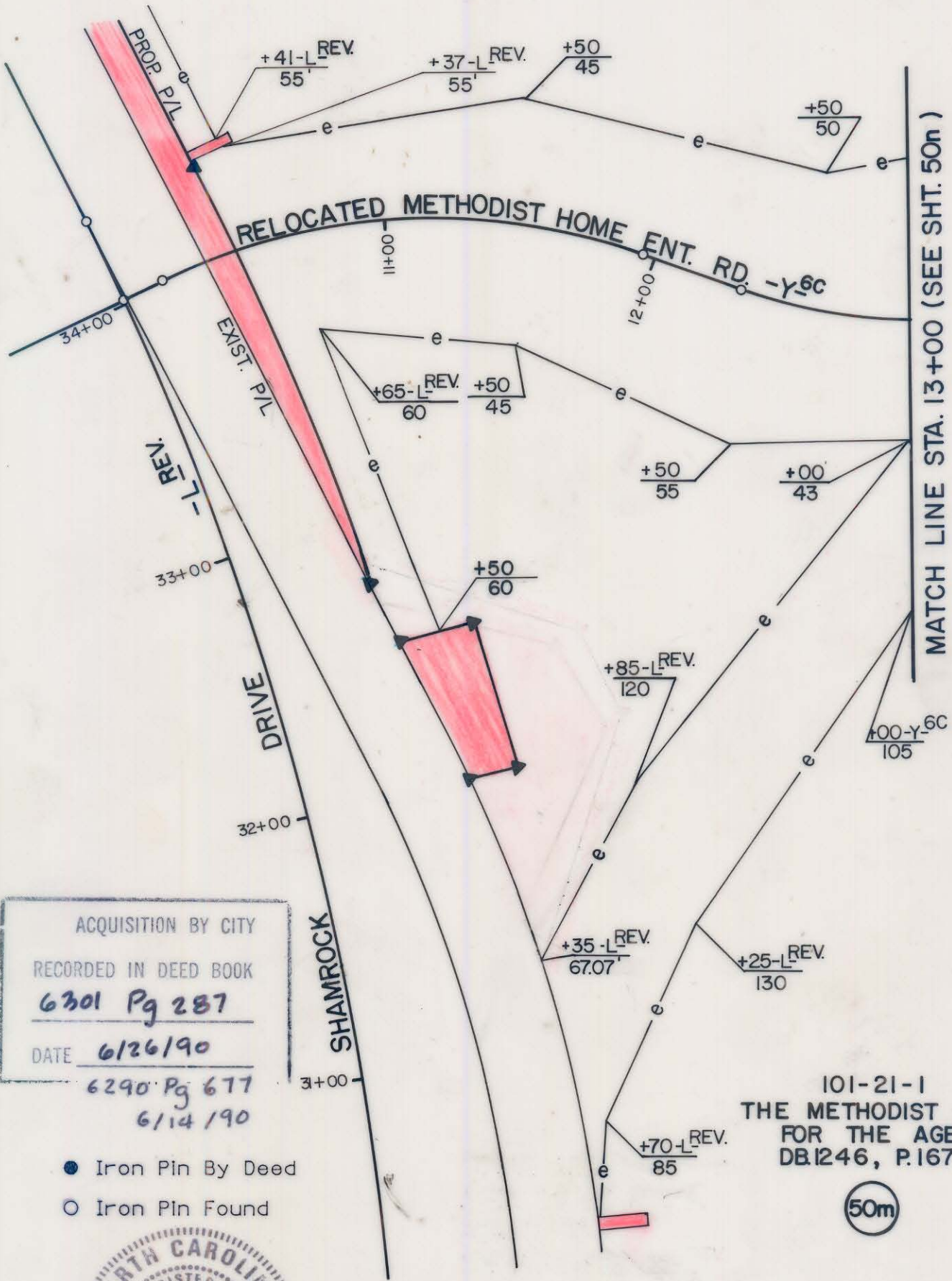

ACQUISITION BY CITY
 RECORDED IN DEED BOOK
6301 Pg 287
 DATE **6/26/90**

6290 Pg 677
6/14/90

- Iron Pin By Deed
- Iron Pin Found



(FOR ENTRANCE ROAD CONSTRUCTION EASM'T. ACQUISITION ONLY.)

101-21-1
 THE METHODIST HOME FOR THE AGED
 DB.1246, P.167



F H FLORENCE & HUTCHESON, INC.
 CONSULTING ENGINEERS

This plat was prepared under my supervision. *Robert A. Foy*
 N. C. Reg. Surveyor No. L-1651

CHARLOTTE ENGINEERING DEPARTMENT		JOB NO.
REVISIONS	SHAMROCK DRIVE	FILE NO.
10/89 REVISED PROP. R/W / SRW		SHEET
1/90 REV. PROP. R/W	PROPERTY OF THE METHODIST HOME FOR THE AGED	50m
DRAWN BY SRW		OF
CHECKED BY MSA	DATE 4/89	141
SURVEY SUPPL.	SCALE 1" = 50'	

DB6291Pg110 101-21-1 102-01