

I, DAVID H. SNIDER, CERTIFY THAT THIS PLAT WAS PREPARED UNDER MY SUPERVISION AND THAT THE PLAT WAS PREPARED FOR THE PURPOSE OF EASEMENTS ONLY, AND IS NOT INTENDED TO BE A BOUNDARY SURVEY OF PROPERTY SHOWN.

David H. Snider 4/16/07
 DAVID H. SNIDER, NC P.L.S. L-2942 DATE

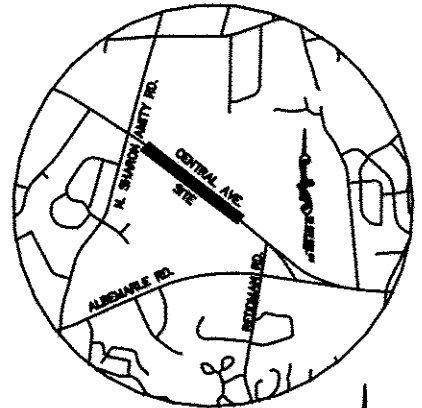
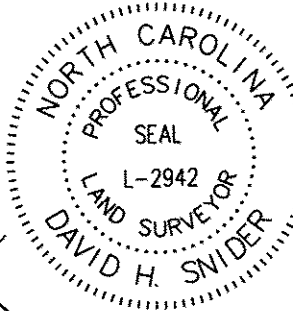

VICINITY MAP
not to scale

CHARLOTTE EASTLAND MALL, LLC
 TAX CODE: 103-041-27
 DB 12807 PAGE 675 (TRACT III)

(23)

BELK CHARLOTTE, INC.
 TAX CODE: 103-041-26
 DB 7227 PG 982

(20)

(22)
 EASTLAND, LTD.
 TAX CODE: 103-041-34
 DB 3658 PG 634

S40°53'04"W 272.14'
 (S39°30'00"W)

#4 REBAR
 GRID FACTOR=0.999843745
 N 535860.25
 E 1475389.08
 B sta. "-L-"
 136+19.40
 52.16' LT.

State of North Carolina
 County of Mecklenburg

I, Review Officer of Mecklenburg County, certify that the map or plat to which this certification is affixed meets all statutory requirements for recording.

Review Officer _____ Date _____

(21)

H/V CENTRAL AVENUE, LLC.
 TAX CODE: 103-041-29
 DB 10956 PG 224
 5301 CENTRAL AVENUE

SEE DETAIL "A"

CENTRAL AVENUE
 (100' RW)

LEGEND

IRON PIN (FOUND)

TEMP. CONSTRUCTION EASEMENT

SIDEWALK/UTILITY EASEMENT

LINES SURVEYED

LINES NOT SURVEYED

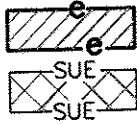

SEE DETAIL "B"

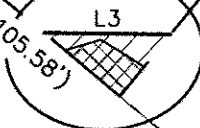

DETAIL "B"
N.T.S.

CURVE TABLE				
CURVE	LENGTH	RADIUS	CHORD	CHORD BEARING
(C1)	(212.60)	(3156.27)	(212.57)	(N52°00'54"W)
C1	212.24		212.20	N51°00'54"W
C2	9.67	3156.27	9.67	N52°51'13"W
C3	125.79	3156.27	125.78	N51°37'27"W

LINE TABLE		
LINE	LENGTH	BEARING
L1	0.43	N40°53'04"E
L2	5.23	N40°53'04"E
L3	39.84	S87°53'55"E
L4	13.04	S40°54'41"W
L5	11.93	S40°54'41"W
L6	9.66	S50°17'55"E
L7	22.50	N49°05'19"W
L8	8.54	N49°05'19"W
L9	11.76	N75°12'11"E
L10	16.03	S57°00'50"E

NOTE:

- BEARINGS AND DISTANCES SHOWN IN PARENTHESES ARE BASED ON RECORDED MAP INFORMATION.
- TOTAL AREA 84,702 SQ.FT.
- TEMP. CONSTRUCTION EASEMENT 1,026 SQ.FT.
- SIDEWALK/UTILITY EASEMENT 206 SQ.FT.
- AREA REMAINING 84,702 SQ.FT.



PREPARED BY:
 CITY OF CHARLOTTE
 ENGINEERING DEPARTMENT
 600 EAST FOURTH STREET
 CHARLOTTE, NC 28202
 704-336-2291

DETAIL "A"
N.T.S.

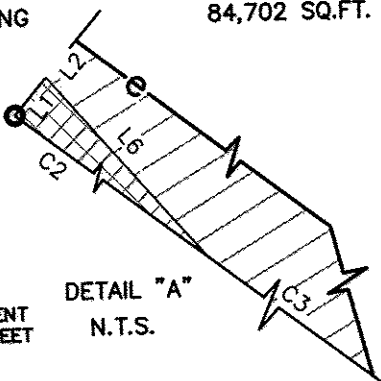

CHARLOTTE ENGINEERING DEPARTMENT		
REVISIONS	CENTRAL AVENUE EASTLAND	JOB NO. 512-03-031
SCALE 1"=60'	OWNER: H/V CENTRAL AVENUE, LLC CHARLOTTE, MECKLENBURG CO., NC	FILE NO. LAN #203031
DRAWN BY G.F.	CHECKED BY	SHEET 1
DATE	SURVEY SUPVR.	OF 1
K:\AUTOCAD\en_su-ld4\Lan.203031\dwg\PLAT-21.dwg		

* RECORDED 08-03-07 DB 22630-141 *