

# SHARON AMITY ROAD

599.71' to  
VERNDALE RD. →

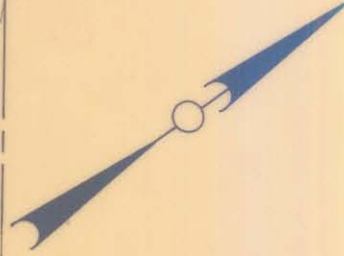
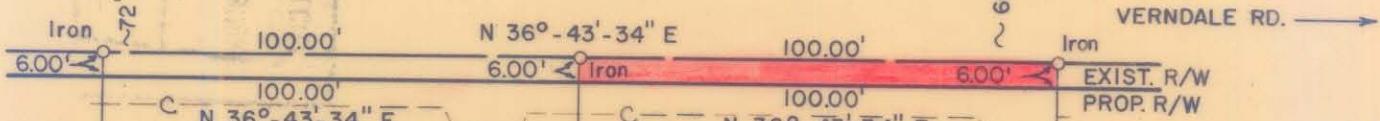

117

118

119

120

N 53°-16' - 26" W 370.00' total  
364.00'

**103-071-06**

DEED 2070-600

Total Area 37,000 Sq. Ft.  
Area Taken 600 Sq. Ft.  
Area Remaining 36,400 Sq. Ft.

N 53°-16' - 26" W 370.00' total  
364.00'

**103-071-05**

DEED 1767-299

Total Area 37,000 Sq. Ft.  
Area Taken 600 Sq. Ft.  
Area Remaining 36,400 Sq. Ft.

N 53°-16' - 26" W 370.00' total  
364.00'

R/W ACQUISITION BY CITY  
RECORDED IN DEED BOOK  
3751 - 0633  
DATE 11-20-75



NOTE: Property corners shown circled were located by actual survey. Bearings are based on NORTH CAROLINA COORDINATE SYSTEM

This plat was prepared under my supervision *K. G. Gillis*  
N.C. Reg. Engineer No. 4343

CITY OF CHARLOTTE NORTH CAROLINA DEPARTMENT OF PUBLIC WORKS ENGINEERING DIVISION		
REVISIONS	PROPOSED R/W SHARON AMITY ROAD PROJECT NO. 513-72-212	JOB NO.
	PARCEL NO. 119	FILE NO. RW-70
DRAWN BY CSC		SHEET 119
CHECKED BY JSS		OF 164
CITY ENGINEER	DATE JUNE 21, 1974 SCALE 1" = 40'	

103-71-05