

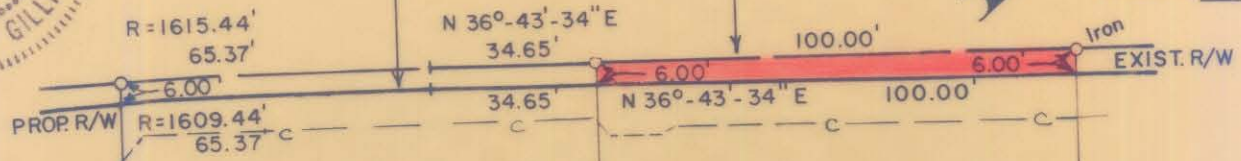

# SHARON AMITY ROAD



110

111

112

113

368.68' total

370.00' total

370.00' total

N 53°-16'-26" W  
362.68'

N 53°-16'-26" W  
364.00'

N 53°-16'-26" W  
364.00'

**103-071-13**  
DEED 1317 - 380  
Total Area 36,971 Sq. Ft.  
Area Taken 600 Sq. Ft.  
Area Remaining 36,371 Sq. Ft.

**103-071-12**  
DEED 1405 - 180  
Total Area 37,000 Sq. Ft.  
Area Taken 600 Sq. Ft.  
Area Remaining 36,400 Sq. Ft.

R/W ACQUISITION BY CITY  
RECORDED IN DEED BOOK  
3751-0690  
DATE 11-20-75

100.00'  
N 36°-43'-34" E

100.00'  
N 36°-43'-34" E

NOTE: Property corners shown circled were located by actual survey. Bearings are based on NORTH CAROLINA COORDINATE SYSTEM

This plat was prepared under my supervision K.G. Gillis  
N.C. Reg. Engineer No. 4343

CITY OF CHARLOTTE NORTH CAROLINA DEPARTMENT OF PUBLIC WORKS ENGINEERING DIVISION		
REVISIONS	PROPOSED R/W SHARON AMITY ROAD PROJECT NO. 513-72-212	JOB NO.
	PARCEL NO. 112	FILE NO. RW-70
DRAWN BY CSC		SHEET 112
CHECKED BY JSS		OF 164
CITY ENGINEER <u>K.G. Gillis</u>	DATE JUNE 21, 1974 SCALE 1" = 40'	

103-71-12