

I, DAVID H. SNIDER, CERTIFY THAT THIS PLAT WAS PREPARED UNDER MY SUPERVISION AND THAT THE PLAT WAS PREPARED FOR THE PURPOSE OF EASEMENTS ONLY, AND IS NOT INTENDED TO BE A BOUNDARY SURVEY OF PROPERTY SHOWN.

David H. Snider 6/22/09
 DAVID H. SNIDER, NC P.L.S. L-2942 DATE



N44°12'25"E
 (N44°34'11"E 228.28')

PROPERTY LINE

MECKLENBURG COUNTY
 TAX CODE: 105-071-02
 DB 9864 PAGE 954
 LESS R/W DB 14415 PG 77
 8900 GRIER ROAD

GRIER ROAD
 R/W VARIES

PROPERTY LINE

NOTE:

- 1) BEARINGS AND DISTANCES SHOWN IN PARENTHESES ARE BASED ON RECORDED MAP & DEED INFORMATION.
- 2) TOTAL AREA 1,494,569 SQ.FT.
- 3) AREA WITHIN R/W 36,189 SQ.FT.
- 4) UNRECORDED SURVEY BY R.B. PHARR DATED 08-04-1999, FILE NO. W-2437
- 5) TEMPORARY CONSTRUCTION EASEMENT 27,182 SQ.FT.
- 6) SIDEWALK / UTILITY EASEMENT 38,819 SQ.FT.
- 7) STORM DRAINAGE EASEMENT 1,044 SQ.FT.
- 8) AREA REMAINING 1,494,569 SQ.FT.

TIE LINE
 S30°15'51"W
 372.05'

5

MECKLENBURG COUNTY
 TAX CODE: 105-071-07
 DB 10888 PAGE 642
 GRIER ROAD

SEE SHEET 2 OF 2 FOR
 DETAILS OF EASEMENTS

N 557337.61
 E 1485062.47

B sta. 46+59.65 Grier Rd.
 55.00' Rt.

(N44°09'08"W 911.54'
 N44°30'59"W 932.91' total)

4

THE CHARLOTTE-MECKLENBURG
 BOARD OF EDUCATION
 TAX CODE: 105-091-26
 DB 9876 PAGE 176
 8330 GRIER ROAD

MECKLENBURG COUNTY
 TAX CODE: 105-071-06
 DB 9276 PAGE 437

PREPARED BY:
 CITY OF CHARLOTTE
 ENGINEERING DEPARTMENT
 600 EAST FOURTH STREET
 CHARLOTTE, NC 28208
 704-336-2291

(S41°41'46"W 371.34')
 (N67°10'39"W 442.70')
 MECKLENBURG COUNTY
 TAX CODE: 105-071-04
 DB 10840 PAGE 683

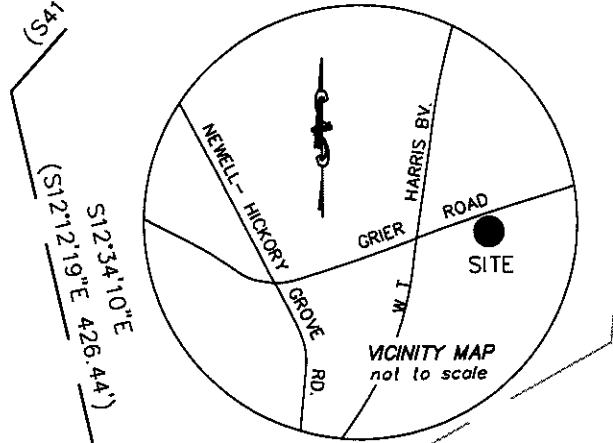

S28°56'48"E
 (S28°34'57"E 126.63')

MECKLENBURG COUNTY
 TAX CODE: 105-071-01
 DB 9276 PAGE 437

S60°45'52"W
 (S61°07'43"W 191.23')

S04°52'43"W
 (S05°21'34"W 847.56')



NC GRID NAD 83/2007 MRS

DB 25401-944

		CHARLOTTE ENGINEERING & PROPERTY MANAGEMENT	
REVISIONS		GRIER ROAD SIDEWALK	JOB NO. 512-07-068
			FILE NO. LAN #207068
SCALE 1" = 200' 		OWNER: MECKLENBURG COUNTY TAX CODE: 105-071-07 CHARLOTTE, MECKLENBURG CO., NC	SHEET 1
			OF 2
DATE 6-15-09	DRAWN BY G.F.	CHECKED BY	SURVEY SUPR. <i>DU</i>

I, DAVID H. SNIDER, CERTIFY THAT THIS PLAT WAS PREPARED UNDER MY SUPERVISION AND THAT THE PLAT WAS PREPARED FOR THE PURPOSE OF EASEMENTS ONLY, AND IS NOT INTENDED TO BE A BOUNDARY SURVEY OF PROPERTY SHOWN.

David H. Snider 6/22/09
 DAVID H. SNIDER, NC P.L.S. L-2942 DATE

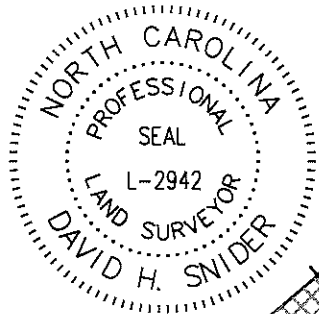

State of North Carolina
 County of Mecklenburg

I, _____, Review Officer of Mecklenburg County, certify that the map or plat to which this certification is affixed meets all statutory requirements for recording.

Review Officer _____ Date _____

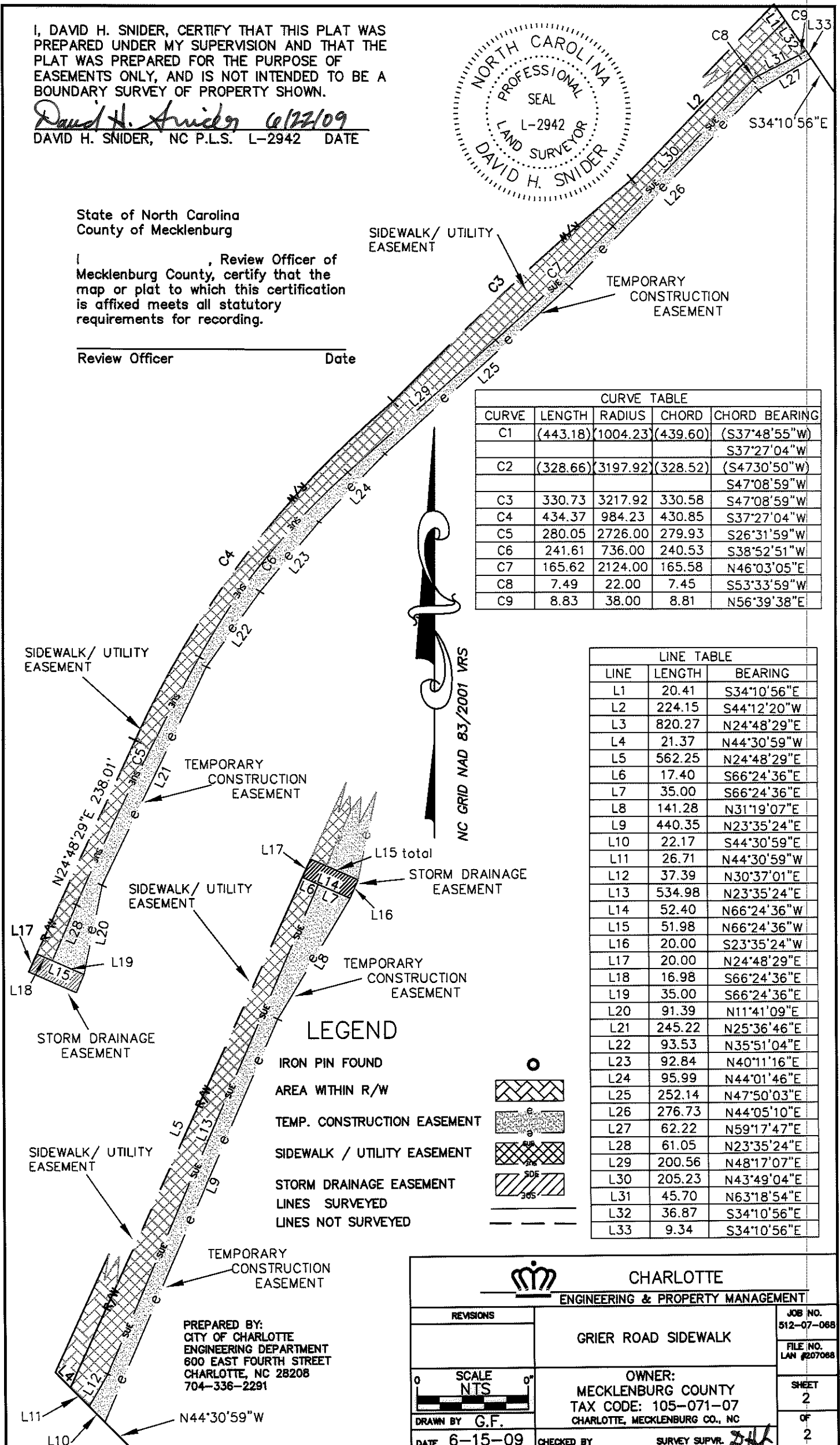

CURVE TABLE				
CURVE	LENGTH	RADIUS	CHORD	CHORD BEARING
C1	(443.18)	1004.23	(439.60)	(S37°48'55"W)
				S37°27'04"W
C2	(328.66)	3197.92	(328.52)	(S47°30'50"W)
				S47°08'59"W
C3	330.73	3217.92	330.58	S47°08'59"W
C4	434.37	984.23	430.85	S37°27'04"W
C5	280.05	2726.00	279.93	S26°31'59"W
C6	241.61	736.00	240.53	S38°52'51"W
C7	165.62	2124.00	165.58	N46°03'05"E
C8	7.49	22.00	7.45	S53°33'59"W
C9	8.83	38.00	8.81	N56°39'38"E

LINE TABLE		
LINE	LENGTH	BEARING
L1	20.41	S34°10'56"E
L2	224.15	S44°12'20"W
L3	820.27	N24°48'29"E
L4	21.37	N44°30'59"W
L5	562.25	N24°48'29"E
L6	17.40	S66°24'36"E
L7	35.00	S66°24'36"E
L8	141.28	N31°19'07"E
L9	440.35	N23°35'24"E
L10	22.17	S44°30'59"E
L11	26.71	N44°30'59"W
L12	37.39	N30°37'01"E
L13	534.98	N23°35'24"E
L14	52.40	N66°24'36"W
L15	51.98	N66°24'36"W
L16	20.00	S23°35'24"W
L17	20.00	N24°48'29"E
L18	16.98	S66°24'36"E
L19	35.00	S66°24'36"E
L20	91.39	N11°41'09"E
L21	245.22	N25°36'46"E
L22	93.53	N35°51'04"E
L23	92.84	N40°11'16"E
L24	95.99	N44°01'46"E
L25	252.14	N47°50'03"E
L26	276.73	N44°05'10"E
L27	62.22	N59°17'47"E
L28	61.05	N23°35'24"E
L29	200.56	N48°17'07"E
L30	205.23	N43°49'04"E
L31	45.70	N63°18'54"E
L32	36.87	S34°10'56"E
L33	9.34	S34°10'56"E

LEGEND

- IRON PIN FOUND
- AREA WITHIN R/W
- TEMP. CONSTRUCTION EASEMENT
- SIDEWALK / UTILITY EASEMENT
- STORM DRAINAGE EASEMENT
- LINES SURVEYED
- LINES NOT SURVEYED

PREPARED BY:
 CITY OF CHARLOTTE
 ENGINEERING DEPARTMENT
 600 EAST FOURTH STREET
 CHARLOTTE, NC 28208
 704-336-2291

		CHARLOTTE ENGINEERING & PROPERTY MANAGEMENT
REVISIONS	GRIER ROAD SIDEWALK	JOB NO. 512-07-088
		FILE NO. LAN #207068
SCALE NTS 	OWNER: MECKLENBURG COUNTY TAX CODE: 105-071-07 CHARLOTTE, MECKLENBURG CO., NC	SHEET 2
DRAWN BY G.F.		OF 2
DATE 6-15-09	CHECKED BY	SURVEY SUPVR. <i>[Signature]</i>

DB 25401-944