

I, DAVID H. SNIDER, CERTIFY THAT THIS PLAT WAS PREPARED UNDER MY SUPERVISION AND THAT THE PLAT WAS PREPARED FOR THE PURPOSE OF ACQUISITION AND EASEMENTS ONLY, AND IS NOT INTENDED TO BE A BOUNDARY SURVEY OF PROPERTY SHOWN.

*David H. Snider* 11/20/01  
 DAVID H. SNIDER, NC P.L.S. L-2942 DATE

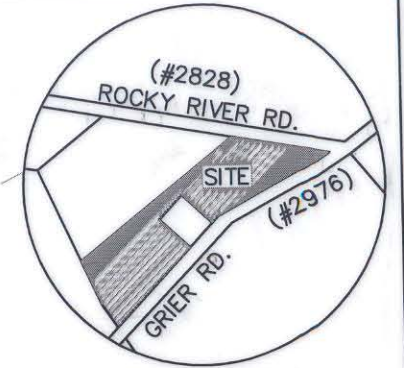

②  
 UNITED WESLEYAN CHURCH  
 TAX CODE: 105-031-31  
 DB 6471 PG 258



VICINITY MAP (N.T.S.)

FIRE STATION #34  
 LOT 1  
 MAP BOOK 35 PAGE 581

④  
 MECKLENBURG COUNTY  
 REEDY CREEK PARK  
 TAX CODE: 105-071-01  
 DB 9276 PG 437

③  
 CHURCH OF JESUS CHRIST OF LATTERDAY SAINTS  
 TAX CODE: 105-082-04  
 DB 7141 PG 967

JOHN B. MCLAUGHLIN  
 TAX CODE: 105-082-03  
 DB 1209 PG 012  
 8801 GRIER ROAD

⑤  
 MECKLENBURG COUNTY  
 TAX CODE: 105-071-02  
 DB 9864 PG 954

LEGEND

IRON PIN FOUND	⊙
IRON PIN SET	⦿
PK NAIL FOUND	Ⓚ
AREA ACQUIRED	
TEMPORARY CONSTRUCTION EASEMENT	
APPARENT RIGHT OF WAY	
PERMANENT UTILITY EASEMENT	
LINES SURVEYED	
LINES NOT SURVEYED	

ACQUISITION BY CITY  
 RECORDED IN DEED BOOK  
 13732-924  
 DATE 6-25-02

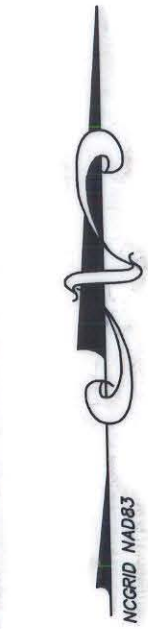

GLEN LAUREL, MAP 1  
 MAP BOOK 29 PAGE 671

PREPARED BY:  
 CITY OF CHARLOTTE  
 ENGINEERING DEPARTMENT  
 600 EAST FOURTH STREET  
 CHARLOTTE, NC 28202  
 704-336-2291

1-1/2" iron pipe  
 (S33°15'00"E) PK nail  
 S34°39'25"E 67.05'

State of North Carolina  
 County of Mecklenburg

I, \_\_\_\_\_, Review Officer of Mecklenburg County, certify that the map or plat to which this certification is affixed meets all statutory requirements for recording.

Review Officer \_\_\_\_\_ Date \_\_\_\_\_

REVISIONS
ADDED: 10-29-01 CHANGED TEMP. CONST. EASEMENT ADDED PERMANENT UTILITY EASEMENTS ADJUSTED AREA REMAINING REMOVED PERMANENT SEWER EASEMENT ADDED 3rd PAGE

		CHARLOTTE ENGINEERING DEPARTMENT	
REVISIONS		GRIER RD. & ROCKY RIVER RD. INTERSECTION IMPROVEMENT	JOB NO. 512-02-010
ADDED: 7-30-01 CHANGED PROJECT NUMBER ADDED: 7-20-01 15' PERM. SAN. SEWER EASEMENT 10' TEMP. CONST. EASEMENT		PROJECT NO. 512-02-010	FILE NO. LAN #30834 PLAT-01.dwg
SCALE 0 1" = 200' 1"		<b>PROPERTY OF JOHN B. MCLAUGHLIN</b> CHARLOTTE, MECKLENBURG CO., NC	SHEET 1
DRAWN BY G.C.F. DATE 7-09-01			OF 3
CHECKED BY _____		SURVEY SUPVR. <i>DNA</i>	