

N.C. GRID - M.A.D. 83
COMBINED SCALE FACTOR = 0.9998362

AREA ACQUIRED		
LINE	BEARING	DIST.
L1	S33-32-39E	90.04
C1	RAD = 20.00 ARC = 31.41	
CHORD	N11-35-47E	28.28
DELTA	89-58-58	
L2	S56-35-07W	1.21
C2	RAD = 521.39 ARC = 112.29	
CHORD	N62-46-07E	112.07
DELTA	12-20-21	
L3	N64-46-06E	18.01
C3	RAD = 520.39 ARC = 86.04	
CHORD	S62-12-59W	85.94
DELTA	09-28-23	
L4	N10-37-49E	31.33
L5	N33-24-27W	86.44
L6	N56-34-28E	7.29

TEMP. CONST. EASEMENT 'A'		
LINE	BEARING	DIST.
L5	N33-24-27W	86.44
L7	N10-37-49W	9.35
L8	S33-24-28E	27.13
L9	N56-35-31E	10.00
L10	S33-24-18E	17.00
L11	S56-35-31W	10.00
L12	S33-24-28E	49.03
L13	S56-34-28W	6.50

TEMP. CONST. EASEMENT 'B'		
LINE	BEARING	DIST.
L14	S19-20-21E	6.99
L15	S67-26-41W	39.14
L16	S24-43-30E	4.00
L17	S64-07-15W	20.55
L18	N27-01-48W	4.00
L19	N57-22-11E	57.12
L20	N10-37-49E	11.60
C3	RAD = 520.39 ARC = 86.04	
CHORD	N62-12-59E	85.94
DELTA	09-28-23	
L3	N64-46-12E	18.02
C4	RAD = 521.39 ARC = 6.51	
CHORD	N69-17-22E	6.51
DELTA	00-42-35	

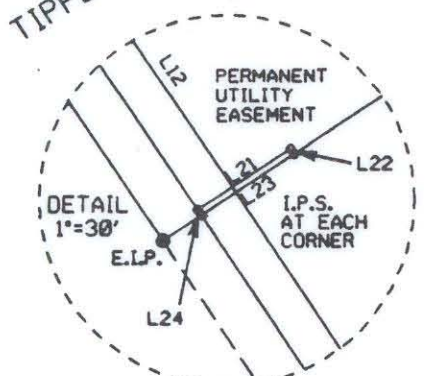

PERM. UTILITY EASEMENT		
LINE	BEARING	DIST.
L21	N56-35-44E	17.50
L22	S33-24-51E	1.02
L23	S56-34-30W	17.50
L24	N33-17-29W	1.03

PARCEL AREA DATA		
DESC.	SQ. FT.	AC.
TOTAL PARCEL AREA	13502	0.310
TOTAL AREA ACQUIRED	1095	0.025
TOTAL PERM. UTILITY EASE.	18	0.0004
AREA REMAINING	12389	0.285
TOTAL TEMP. CONST. EASE. 'A'	754	0.017
TOTAL TEMP. CONST. EASE. 'B'	880	0.020

I, Bradley Lloyd Hunter, certify that this plat was drawn under my supervision. This plat is a compilation of field and deed data and is NOT intended to be a boundary survey of the property shown.



- REFERENCES:
- 1) NCGS MONUMENTS "RANDY" AND "TAYLOR".
 - 2) CHARLOTTE ENG. DEPT. R/W PLANS FOR PROPOSED MILTON RD. IMPROVEMENTS PREP. BY PBS&J, CHARLOTTE, DATED 10/25/93. (PARCEL #35)
 - 3) D.B. 5338, PG. 556.

- NOTES:
- 1) EIP DENOTES EXISTING IRON PIPE.
 - 2) IPS DENOTES IRON PIPE SET.
 - 3) ALL DISTANCES ARE HORIZONTAL GROUND.
 - 4) AREAS BY COORDINATE COMPUTATION.
 - 5) (C) DENOTES COMPUTED.
 - 6) (F) DENOTES FIELD MEASUREMENT.

Bradley L. Hunter
Bradley Lloyd Hunter, NCRLS * L-3565



POST, BUCKLEY, SCHUH & JERNIGAN, INC.
ONE WOODLAWN GREEN, SUITE 310
CHARLOTTE, NORTH CAROLINA 28217

CHARLOTTE ENGINEERING DEPARTMENT		
REVISIONS	MILTON ROAD IMPROVEMENTS PROJECT NO. 512-89-062	JOB NO. 29-04915
PROPERTY OF	JAMES J. POLK TAX MAP CODE 107-021-PARCEL 6 CITY OF CHARLOTTE, MECKLENBURG COUNTY, N.C.	DWG NO. MLT356500
DATE 2/21/94	SCALE 1" = 60'	SHEET 1 OF 1

107-021-06