

I, DAVID H. SNIDER, CERTIFY THAT THIS PLAT WAS PREPARED UNDER MY SUPERVISION AND THAT THE PLAT WAS PREPARED FOR THE PURPOSE OF ACQUISITION AND EASEMENTS ONLY, AND IS NOT INTENDED TO BE A BOUNDARY SURVEY OF PROPERTY SHOWN.

*David H. Snider* 01/10/03  
 DAVID H. SNIDER, NC P.L.S. L-2942 DATE

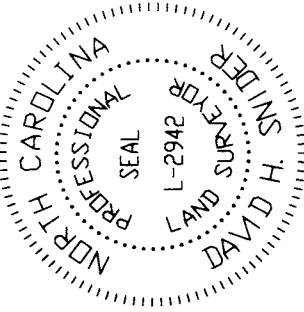

**ACQUISITION BY CITY  
 RECORDED IN DEED BOOK**  
 15620-563  
 DATE 02-09-03

LEGEND

- IRON PIN FOUND
- #6 REBAR SET
- ▨ AREA ACQUIRED
- ▤ TEMP. CONSTRUCTION EASEMENT
- ▥ PERMANENT DRAINAGE EASEMENT

PERMANENT UTILITY EASEMENT  
 OLD PROPERTY LINE

**THE PLAZA (R/W VARIES)**

LINE	BEARING	LENGTH
L5	N01°07'20"W	6.02
L6	N01°07'20"W	13.43
L7	N88°30'48"E	7.35
L8	N01°04'37"W	51.23
L9	N87°41'26"E	57.32
L10	S07°45'47"E	60.71
L11	N01°00'24"W	29.12
L12	N89°24'04"E	27.49
L13	S18°58'28"E	14.50
L14	S80°56'29"E	41.88
L15	S01°30'00"E	31.79
L16	S01°30'00"E	19.77
L17	S86°07'39"W	17.26
L18	S82°54'21"W	20.40
L19	S82°54'21"W	42.58
L20	S82°54'21"W	22.13
L21	N77°47'39"E	42.41
L22	S12°12'21"E	3.79

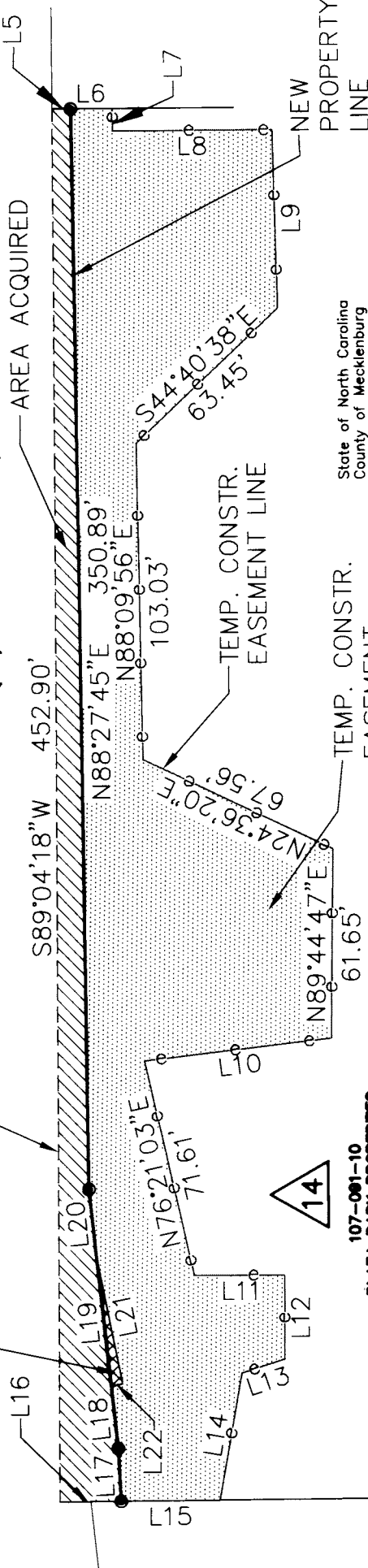

107-081-10  
 PLAZA PARK PROPERTIES  
 DB 04817 PG 841  
 7320 THE PLAZA

State of North Carolina  
 County of Mecklenburg

I, \_\_\_\_\_, Review Officer of Mecklenburg County, certify that the map or plat to which this certification is affixed meets all statutory requirements for recording.

**DETAIL "A"**

NOTE:

- 1) BEARINGS AND DISTANCES SHOWN IN PARENTHESES ARE BASED ON RECORDED MAP INFORMATION.
- 2) TOTAL AREA 240,337 SQ.FT.
- 3) CONSTRUCTION EASEMENT 19,448 SQ.FT.
- 4) PERM. UTILITY EASEMENT 80 SQ.FT.
- 5) AREA ACQUIRED 4,312 SQ.FT.
- 6) AREA REMAINING 236,025 SQ.FT.

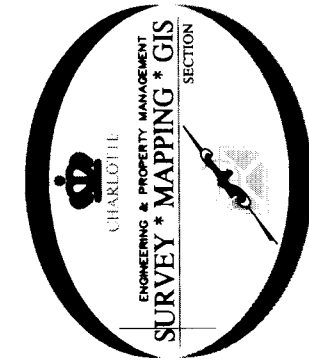

Review Officer \_\_\_\_\_ Date \_\_\_\_\_

CHARLOTTE ENGINEERING DEPARTMENT	REVISIONS	JOB NO. 512-00-067
	SCALE 1"=50' 0 50'	FILE NO. 091-10
THE PLAZA STREETScape		SHEET 2
OWNER: PLAZA PARK PROPERTIES CHARLOTTE, MECKLENBURG CO., NC		OF 2
DATE 11/21/01		SURVEY SUPVR. <i>JS</i>