

FOR REFERENCE INFORMATION SEE
DUKE POWER R/W PLAT FILE NO.
1-926.

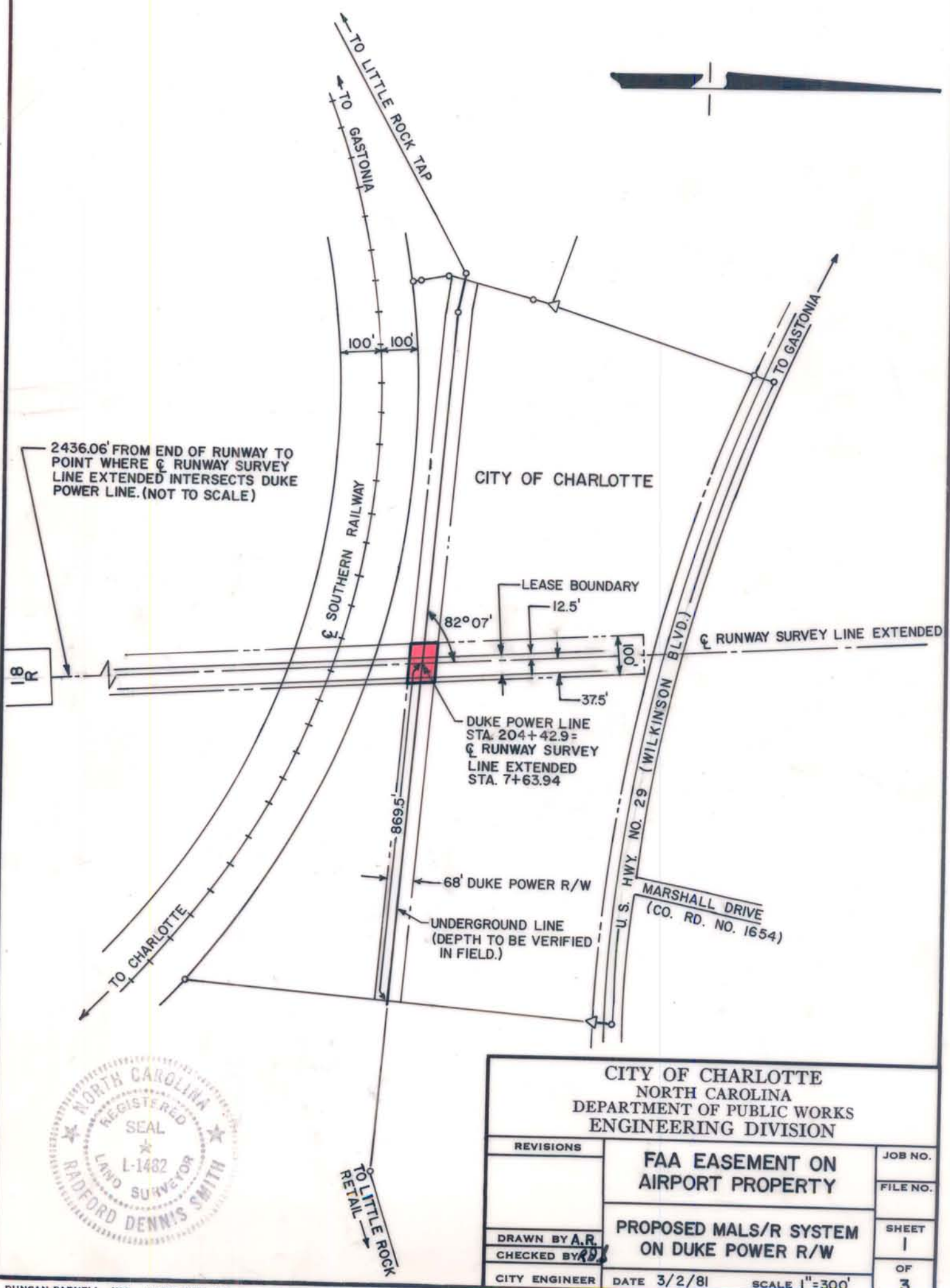

2436.06' FROM END OF RUNWAY TO
POINT WHERE ϕ RUNWAY SURVEY
LINE EXTENDED INTERSECTS DUKE
POWER LINE. (NOT TO SCALE)

18 R



CITY OF CHARLOTTE NORTH CAROLINA DEPARTMENT OF PUBLIC WORKS ENGINEERING DIVISION		
REVISIONS	FAA EASEMENT ON AIRPORT PROPERTY	JOB NO.
		FILE NO.
DRAWN BY A.R.	PROPOSED MALS/R SYSTEM ON DUKE POWER R/W	SHEET 1
CHECKED BY [Signature]		OF 3
CITY ENGINEER	DATE 3/2/81	SCALE 1"=300'