

PARKER DRIVE

± 506.24' TO
REMOUNT RD.

S 87° 30' 00" E
284.00'

60' R/W

IRON

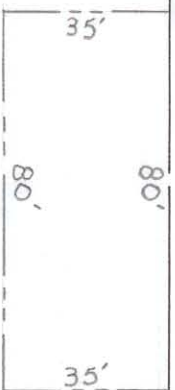

JOHN D. GRIER & WIFE QUEEN ESTHER

119-021-24

± 0.75 ACRES

GRIER

105.50'
N 10° 00' 00" E

LANUCE

100.76'
N 27° 45' 00" E

185.50'
N 9° 00' 00" E

ARDRY

SIMS



This map was prepared for the purpose of right of way or easement acquisition only, and is not intended to be a boundary survey of the property shown.

NOTE: Property corners shown circled were located by actual survey. Bearings are based on MAP BY T.B. SPRATT DATED APRIL 1924.

This plat was prepared under my supervision
Stephen A. Gilbert
N. C. Reg. Surveyor No. L-1785



CITY OF CHARLOTTE NORTH CAROLINA DEPARTMENT OF PUBLIC WORKS ENGINEERING DIVISION		JOB NO. 572-76
REVISIONS	PROPERTY OF JOHN D. GRIER AND WIFE QUEEN ESTHER	FILE NO. R/W 131
DRAWN BY RDT CHECKED BY AG	PARKER DRIVE DRAINAGE IMPROVEMENT	SHEET 2
CITY ENGINEER	DATE NOV. 1976 SCALE 1" = 40'	OF 2