

I, DAVID H. SNIDER, CERTIFY THAT THIS PLAT WAS PREPARED UNDER MY SUPERVISION AND THAT THE PLAT WAS PREPARED FOR THE PURPOSE OF EASEMENTS ONLY, AND IS NOT INTENDED TO BE A BOUNDARY SURVEY OF PROPERTY SHOWN.

David H. Snider 7/20/11
 DAVID H. SNIDER, NC P.L.S. L-2942 DATE

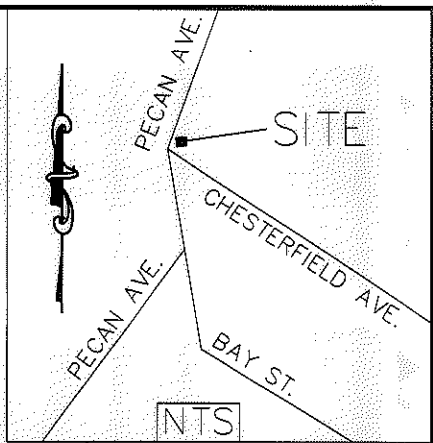

STATE OF NORTH CAROLINA
 COUNTY OF MECKLENBURG

I, _____, REVIEW OFFICER OF MECKLENBURG COUNTY, CERTIFY THAT THE MAP OR PLAT TO WHICH THIS CERTIFICATION IS AFFIXED MEETS ALL STATUTORY REQUIREMENTS FOR RECORDING.

REVIEW OFFICER _____ DATE _____

LEGEND

- IRON PIN FOUND
- CALCULATED POINT
- LINES SURVEYED
- LINES NOT SURVEYED
- TEMP. CONSTRUCTION EASEMENT
- SIDEWALK UTILITY EASEMENT

**60' RIGHT OF WAY
 CHESTERFIELD AVENUE**
 N56°25'45"W
 (N56°18'00"W)
 (50.00')

COMBINED GRID
 FACTOR=0.9998
 N 538590.26
 E 1458072.18

③
 127-023-31
 ERIC C. SOLOW AND
 CHRISTINE J. SOLOW
 DB 10621-276
 2008 CHESTERFIELD AV

④
 127-023-30
 JAMES EARL BRANNON, SR.
 DB 4257-572
 2012 CHESTERFIELD AV

⑤
 127-023-29
 DAVID L. BARKER AND
 DAVID M. BARKER & WVS
 DB 06167-542
 2016 CHESTERFIELD AV

LINE TABLE		
LINE	LENGTH	BEARING
L1	25.36	S54°52'51"E
L2	30.36	S14°22'30"E
L3	6.54	S39°15'23"W
L4	14.30	N03°09'24"E

- 1) BEARINGS AND DISTANCES SHOWN IN PARENTHESES ARE BASED ON RECORDED MAP INFORMATION.
- 2) TOTAL AREA 8,000 SQ. FT.
- 3) TEMP CONSTRUCTION EASEMENT 1,011 SQ. FT.
- 4) SIDEWALK UTILITY EASEMENT 40 SQ. FT.
- 5) AREA REMAINING 8,000 SQ. FT.

**50' RIGHT OF WAY
 PECAN AVENUE**

ALLEY
 11.71'
 6.10'
 9.66'
 7.26'
 3+4.54
 RT 17.97'
 40.02'
 (S56°18'00"E 56.00'TOTAL)
 S56°21'24"E
 8.72'

PREPARED BY:
 CITY OF CHARLOTTE
 ENGINEERING DEPARTMENT
 600 EAST FOURTH STREET
 CHARLOTTE, NC 28202
 704-336-2291

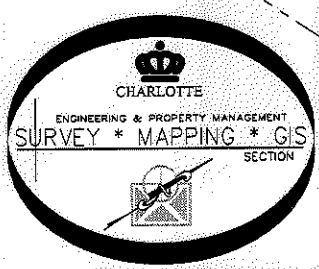

		CHARLOTTE ENGINEERING DEPARTMENT	
REVISIONS		BAY-PECAN INTERSECTION IMP.	
7/28/11 PROJECT # 6/23/11 PID#			
SCALE 1"=20"		PROPERTY OF JAMES EARL BRANNON, SR. CHARLOTTE, MECKLENBURG CO., NC.	
DRAWN BY P.S.			
DATE		CHECKED BY DS SURVEY SUPVR. <i>AK</i>	
K:\AutoCad\En_su-LD4\210051 Bay-Pecan Intersection\PLATS\#4 127-023-30			

ACQUISITION BY DB 27018 PG 63-68

NC GRID NAD 83/2001 VRS